

**CONTROL GEAR**  
railcar.co.uk

**CONTROL  
GEAR**

# CONTROL GEAR SECTION

(A.E.C. TYPE UNITS)

## TYPES

R214A, R214B, R214C,  
R214D, R214E, R214F

railcar.co.uk

# INDEX UNITS, COMPONENTS AND MAJOR PARTS FOR CONTROL GEAR

Description	Page No.
Bracket, Cross Shaft ... ..	R11
Camshaft, Direction Selecting ... ..	R4
Camshaft, Gear Change ... ..	R4
Camshaft, Throttle Controller ... ..	R2
Contact, Moving ... ..	R2, R5
Controller, Gearbox ... ..	R4, R5
Controller, Throttle ... ..	R2, R3
Cleaner, Air... ..	R13
Gauge, Air Pressure ... ..	R6
Indicator, Engine Speed ... ..	R6
Lever, Fuel Pump ... ..	R11
Motor, Throttle ... ..	R10
Panel, Control ... ..	R6
Panel, Instrument ... ..	R12
Reservoir, Air ... ..	R12
Reservoir, Auxiliary Air ... ..	R2
Shaft, Intermediate... ..	R12
Solenoid ... ..	R6
Switch, Change Over ... ..	R12
Switch, Float ... ..	R13
Valve, Combined Deadman's Control ... ..	R7, R8
Valve, Electric Pneumatic ... ..	R12
Valve, Non-Return... ..	R12
Valve, Reducing ... ..	R12
Valve, Safety ... ..	R12

railcar.co.uk

## NUMERICAL INDEX TO PART NUMBERS

Manufacturer's Basic Part No.	B.R. Catalogue No.	Page	Manufacturer's Basic Part No.	B.R. Catalogue No.	Page
A74103	9/15/65123	R7, R8	R32466	9/15/65076	R4
D26903	9/15/95198	R10	R32467	9/15/65007	R2
D26904	9/15/65150	R10	R32473	9/15/65016	R2
D30649	9/15/65028	R2, R4	R32474	9/15/65025	R2
D40602	9/15/65155	R10	R32475	9/15/65027	R2
D40604	9/15/65154	R10	R32477	9/15/65001	R2
D40606	9/15/65152	R10	R32479	9/15/65053	R4
D40702	9/15/65149	R10	R32484	9/15/65070	R4
D40703	9/15/95186	R10	R32485	9/15/65058	R4
E11113	9/15/65036	R3	R32488	9/15/65065	R4
GA0903	9/15/65215	R13	R32492	9/15/65074	R4
GA0904	9/15/65216	R13	R32497	9/15/65163	R10
GA0905	9/15/65217	R13	R1/32402	9/15/65069	R4
G22607	9/15/65032	R3	R1/32404	9/15/65063	R4
G27223	9/15/95208	R10	R1/32405	9/15/65064	R4
R214A		R1	R1/32407	9/15/65010	R2
R214B		R1	R1/32408	9/15/65004	R2
R214C		R1	R1/32409	9/15/65046	R4
R214D		R1	R1/32410	9/15/65078	R4
R214E		R1	R1/32411	9/15/65047	R4
R214F		R1	R1/32414	9/15/65165	R10
R1468	9/15/46829	R11	R1/32415	9/15/65008	R2
R3102	9/15/65142	R10	R1/32417	9/15/65049	R4
R6405	9/15/65174	R11	R2/11262	9/15/65072	R4
R6406	9/15/65173	R11	R2/11286		R11
R6408	9/15/65176	R11	R3/11213	9/15/65196	R12
R6412	9/15/65177	R11	R3/11366	9/15/65180	R11
R6704	9/15/65024	R2	R3/11369	9/15/65197	R12
R6706	9/15/65014	R2	R3/11371	9/15/65181	R11
R6707	9/15/65015	R2	V5026	9/15/65092	R6
R6709	9/15/65052	R4	V7504	9/15/65112	R7, R8
R6710	9/15/65061	R4	V7518	9/15/65097	R6
R7001	9/15/65057	R4	V7519	9/15/65111	R7
R7208	9/15/65030	R3	V7520	9/15/65140	R8
R7209	9/15/65035	R3	V7521	9/15/65110	R7
R7406	9/15/65079	R5	V7532		R9
R7407	9/15/65038	R3	V1/5107	9/15/65091	R6
R7408	9/15/65082	R5	V1/5122	9/15/65102	R6
R7611	9/15/65201	R12	V1/5123	9/15/65106	R6
R7709	9/15/65000	R2	V14106	9/15/65041	R3, R5
R7712	9/15/65045	R4	V15734	9/15/65095	R6
R7713	9/15/65077	R4	V16422	9/15/65096	R6
R2/1212	9/15/65169	R10	V16425	9/15/65103	R6
R2/1219	9/15/65170	R10	V17225	9/15/65042	R3
R2/1224	9/15/65171	R10	V17226	9/15/65040	R3
R10490	9/15/65019	R2	V17227	9/15/65080	R5
R10495	9/15/65085	R5	V17228	9/15/65081	R5
R10498	9/15/65062	R4	V17229	9/15/65083	R5
R10603	9/15/95201	R10	V38005	9/15/65039	R3, R5
R10919	9/15/65033	R3	V38006	9/15/65129	R7
R10920	9/15/65160	R10	V38007	9/15/65130	R7, R8
R10929	9/15/65161	R10	V38036	9/15/65138	R7
R12248	9/15/65023	R2	V38043	9/15/65114	R7, R8
R13530	9/15/65086	R5	V38044	9/15/65121	R7, R8
R13540	9/15/65195	R12	V38045	9/15/65116	R7, R8
R17118	9/15/65184	R11	V38046	9/15/65137	R7, R8
R17125	9/15/45540	R12	V38047	9/15/65240	R8
R32401	9/15/65143	R10	V38050		R7, R8
R32402	9/15/65144	R10	V38051	9/15/65125	R7
R32403	9/15/65146	R10	V38052	9/15/65118	R7, R8
R32404	9/15/65147	R10	V38072	9/15/65018	R2, R5
R32407	9/15/65164	R10	V38073	9/15/65141	R8
R32409	9/15/65172	R10	V38089	9/15/65434	R8
R32414	9/15/65238	R4	V38094	9/15/65139	R7
R32432	9/15/65073	R4	V1/14506	9/15/65093	R6

# NUMERICAL INDEX TO PART NUMBERS

Manufacturer's Basic Part No.	B.R. Catalogue No.	Page	Manufacturer's Basic Part No.	B.R. Catalogue No.	Page
V1/14507	9/15/65094	R6	Z13/30712	9/15/65104	R6
Z10232	9/15/65175	R11	Z14/30720	9/15/65071	R4
Z10657	9/15/65099	R6	Z17/30793	9/15/65098	R6
Z10658	9/15/65100	R6	28-32		R13
Z30316	9/15/65168	R10	28-51	9/15/56763	R4
Z43497	9/15/65202	R12	39-2	9/15/46831	R12
Z44919	9/15/65186	R11	39-3	9/15/65166	R11
Z45239		R12	39-5	9/15/65087	R10
Z45286	9/15/65031	R3	41-61	9/15/65178	R5, R12
Z45298		R11	41-62	9/15/32177	R11
Z47228	9/15/65200	R12	43-95	9/15/65159	R10
Z47612	9/15/65145	R10	43-103	9/15/46582	R10
Z47614	9/15/65050	R4	81-260	9/15/65188	R11
Z48801	9/15/65124	R7, R8	81-263	9/15/46619	R11
Z49313	9/15/65185	R11	81-264	9/15/63551	R11
Z51738	9/15/65119	R7, R8	81-265	9/15/65191	R11
Z51739	9/15/65120	R7, R8	81-266	9/15/65190	R11
Z51740	9/15/65131	R7, R8	81-267	9/15/65189	R11
Z51741	9/15/65132	R7, R8	81-268	9/15/63555	R11
Z51765	9/15/65198	R12	81-320		R13
Z51766	9/15/65204	R12	81-870	9/15/65187	R11
Z51779	9/15/65222	R13	81-1050	9/15/65156	R10
Z1/10146	9/15/65026	R2	81-1994	9/15/65158	R10, R11
Z1/10147	9/15/65003	R2, R4	81-2159		R6, R10, etc.
Z1/10149	9/15/65056	R4	85-32		R10
Z1/10150	9/15/65068	R4	85-33		R7, R8, etc.
Z1/30802	9/15/65017	R2, R4	85-34		R2, R10
Z1/30803	9/15/65029	R2	85-36		R11
Z1/44569	9/15/65126	R7, R8	86-32		R11
Z1/45442	9/15/65005	R2, R4	86-34		R12
Z1/45467	9/15/65183	R11	90-31		R10, R11, etc.
Z1/47033	9/15/65034	R3	90-32		R7, R8, etc.
Z1/47034	9/15/65006	R2	90-34		R2, R5
Z1/47036	9/15/65162	R10	90-37		R12
Z2/10286	9/15/65153	R10	90-152		R11
Z2/10299	9/15/46830	R11	100-4		R12
Z2/32014	9/15/65224	R13	100-5		R3
Z2/32045		R3	100-8		R10
Z2/32047	9/15/33075	R12	100-11		R2, R5
Z3/10201	9/15/65128	R7, R8	100-16		R11
Z3/30616		R2, R3	100-51	9/15/65117	R7, R8
Z3/32013	9/15/65167	R10	107-4	9/15/65054	R4
Z3/44849	9/15/65182	R11	108-22	9/15/65115	R7, R8
Z3/45407	9/15/65022	R2, R5	112-72	9/15/65122	R7, R8
Z4/30690		R6	114-188	9/15/65127	R7, R8
Z4/30691		R12	117-83		R12
Z4/30696		R7, R8	121-103		R12
Z4/30698		R6	121-104	9/15/65002	R2
Z6/30577	9/15/65151	R10	124-155		R7, R8
Z6/30608		R5	124-158		R10
Z6/44883	9/15/65020	R2, R5	124-1127	9/15/65148	R10
Z7/30570	9/15/65113	R7, R8	124-1155	9/15/37546	R13
Z7/44852	9/15/65021	R2	132-56	9/15/65223	R3, R11
Z7/44853	9/15/65055	R4	134-4		R10, R11, etc.
Z8/30701	9/15/65179	R11	135-32		R10
Z11/30783	9/15/35459	R7, R8	135-33		R5, R7, etc.
Z12/30708	9/15/65048	R4	135-34		R2, R10
Z12/30714	9/15/65059	R4	135-36		R13
Z12/30721	9/15/65105	R6	138-142	9/15/65212	R10
Z12/30736	9/15/65012	R2	138-165	9/15/65225	R13
Z12/30740	9/15/65009	R2	138-214	9/15/65199	R12
Z12/30741	9/15/65101	R2, R4	139-41	9/15/45546	R12
Z12/30760	9/15/65134	R6	141-16		R5
Z12/30763	9/15/65133	R7, R8	142-21		R3, R5
Z13/30702	9/15/65037	R7	142-63		
		R3			

## NUMERICAL INDEX TO PART NUMBERS

Manufacturer's Basic Part No.	B.R. Catalogue No.	Page	Manufacturer's Basic Part No.	B.R. Catalogue No.	Page
143-15		R11	409-4		R9
143-18		R6	409-5		R9
145-18		R6	409-6		R9
146-12		R6	409-7		R9
147-31		R6	409-8		R9
149-3		R3, R5	409-10		R9
149-14		R4, R6, etc.	409-16		R9
149-17		R6	409-17		R9
152-9	9/15/65043	R3, R5	409-18		R9
153-11		R3, R5	409-19		R9
153-17		R6	409-20		R9
153-19		R4, R6, etc.	409-24		R9
153-22		R6	409-28	9/15/65013	R2
155-96	9/15/65011	R2	410-15		R9
156-168		R4	410-18		R9
157-2		R10	410-19		R9
157-3		R3	410-30		R9
157-6		R4	410-42		R9
196-1	9/15/99076	R2, R4	410-43		R9
216-282	9/15/63549	R11	410-45		R9
216-573	9/15/63548	R11	410-48		R9
219-24		R13	410-49		R9
219-56		R3	410-55		R9
310-81		R13	410-57		R9
310-82		R13	410-58		R9
310-89		R13	410-59		R9
331-48	9/15/65136	R7, R8	410-60		R9
331-49	9/15/65135	R7, R8	410-61		R9
332-68		R13	410-62		R9
339-997	9/15/65051	R4, R7, etc.	410-63		R9
339-999	9/15/63775	R2	410-64		R9
339-1327	9/15/63794	R6	411-117	9/15/65193	R11
339-1375	9/15/65107	R6	411-190	9/15/65192	R11
347-90		R14	416-364	9/15/63795	R6
347-169		R14	416-371	9/15/65108	R6
347-214		R14	471-9		R9
373-406	9/15/65088	R6	471-15		R9
373-415	9/15/65089	R6	499-33		R14
402-107		R14	499-924		R14
402-115		R14	499-928		R14
402-116		R14	499-2472		R9
402-214		R14	499-2495	9/15/65084	R5
402-217		R14	499-3030	9/15/65203	R12
402-220		R14	501-225	9/15/65221	R13
404-3		R9	546-1198	9/15/63777	R6
404-4		R9	546-1390	9/15/63792	R6
404-5		R9	546-1391	9/15/63793	R6
404-6		R9	546-1393	9/15/63788	R6
404-7		R9	546-1394	9/15/63789	R6
404-8		R9	5001-29	9/15/65231	R13
406-47		R9	5001-140	9/15/65209	R13
407-33		R9	5001-143	9/15/65211	R13
407-34		R9	5001-144	9/15/65214	R13
407-35		R9	5004-10	9/15/65230	R13
407-38		R9	5004-11	9/15/65206	R13
407-42		R9	5006-92	9/15/65228	R13
407-43		R9	5006-93	9/15/65226	R13
407-44		R9	5006-308	9/15/65207	R13
407-45		R9	5006-326	9/15/65227	R13
407-46		R9	5006-327	9/15/65229	R13
407-48		R9	5006-442	9/15/65218	R13
408-12		R9	5006-443	9/15/65219	R13
408-16		R9	5006-444	9/15/65220	R13
408-17		R9	5006-495	9/15/65210	R13
409-1		R9	5006-504	9/15/65208	R13
409-2		R9			
409-3		R9			

## NUMERICAL INDEX TO PART NUMBERS

Manufacturer's Basic Part No.	B.R. Catalogue No.	Page	Manufacturer's Basic Part No.	B.R. Catalogue No.	Page	
5006-505	9/15/65213	R13				
5021-81		R13				
5021-82		R13				
5021-83		R13				
5021-84		R13				
5021-85		R13				
5021-87		R13				
5021-333		R13				
5021-583		R13				
5023-17		9/15/65233	R14			
5023-19		9/15/65235	R14			
5023-24		9/15/65234	R14			
5037-44		9/15/65236	R14			
5041-1	9/15/65090	R6				
5041-2	9/15/65382	R6				
5042-1	9/15/65232	R13				
5046-2	9/15/65194	R12				
5110-1	9/15/65205	R12				

railcar.co.uk

## CONTROL GEAR TYPES

B.R. Cat. No.	A.E.C. Basic Part No.	Description
	R214A	<b>CONTROL GEAR COMPLETE</b> (Power Car) DTO1/B, 1/2, 1/5, 1/7, 1/11, 1/11B
	R214B	<b>CONTROL GEAR COMPLETE</b> (Trailer Car) DTO1/B, 1/2, 1/5, 1/7, 1/11, 1/11B
	R214C	<b>CONTROL GEAR COMPLETE</b> (Power Car) DTO1/3
	R214D	<b>CONTROL GEAR COMPLETE</b> (Trailer Car) DTO1/3
	R214E	<b>CONTROL GEAR COMPLETE</b> (Power Car) DTO1/6
	R214F	<b>CONTROL GEAR COMPLETE</b> (Power Car) DTO1/20

railcar.co.uk



B.R. Cat. No.	A.E.C. Basic Part No.	Plate Ref.	Designation	Used on	No. Req. per Control Gear	Remarks
		<b>RI</b>	<b>CONTROL GEAR COMPLETE ... ..</b>	See Page R.1		
			<b>THROTTLE CONTROLLER COMPLETE ...</b>	All Models	1	
9/15/65000	R7709		Casing, Controller ... ..	"	1	Controller Case
9/15/65001	R32477	1	Stud, $\frac{3}{8}$ " B.S.F. $\times$ $1\frac{1}{2}$ ", Special ... ..	"	4	
9/15/65002	124-155	2	Bush ... ..	"	1	
9/15/65003	Z1/10147	3	Plunger, Locking ... ..	"	1	
9/15/65004	R1/32408	4	Spring ... ..	"	1	Locking Plunger
9/15/65005	Z1/45442	5	Setscrew, Special ... ..	"	1	
9/15/65006	Z1/47034	6	Washer, $\frac{1}{4}$ " Grover... ..	"	1	
	Z3/30616	7	Plug ... ..	"	1	
9/15/65007	R32467	8	Coupling Connection ... ..	"	1	
9/15/63775	339-999	9	Cover, Controller Case ... ..	"	1	Cover
9/15/65008	R1/32415	11	Setscrew, Special ... ..	"	5	
9/15/65009	Z12/30740	12	Cover, Side ... ..	"	1	Side Cover
9/15/65010	R1/32407	13	Dowel, $\frac{1}{4}$ ", 14 m/m. ... ..	"	2	
9/15/65011	155-96	14	Setscrew, Special ... ..	"	7	
9/15/65012	Z12/30736	15	Washer, $\frac{1}{4}$ " Grover... ..	"	7	
	Z3/30616	15	Bush, Camshaft ... ..	"	3	
9/15/65003	Z1/10147	16	Plug, $\frac{3}{8}$ " Electric Thread ... ..	"	1	
9/15/65013	409-28	17	<b>CAMSHAFT COMPLETE WITH LOCATING PLATE ... ..</b>	"	1	
9/15/65014	R6706	18	<b>CAMSHAFT WITH GEAR</b>	"	1	
			Plate, Locating ... ..	"	1	
9/15/65015	R6707		Rivet, $\frac{1}{4}$ " Dia., Steel, Special ... ..	"	1	
9/15/65016	R32473		Washer, Thrust ... ..	"	2	
9/15/99076	196-1		<b>MOVING CONTACT COMPLETE</b>	"	4	
9/15/65017	Z1/30802	19	Shaft ... ..	"	1	Moving Contact
9/15/65018	V38072	20	Locknut, $\frac{5}{8}$ " B.S.F. ... ..	"	1	
9/15/65019	R10490	21	Distance Piece, $\frac{5}{8}$ " ... ..	"	3	
	90-37	22	Distance Piece, $\frac{3}{8}$ ", Drilled ... ..	"	2	
9/15/65020	Z6/44883	23	Split Pin, $\frac{1}{8}$ " $\times$ $1\frac{3}{8}$ " ... ..	"	2	
9/15/65021	Z7/44852	24	Spring ... ..	"	4	
	100-16	25	Shaft, Intermediate ... ..	"	1	Intermediate Shaft
9/15/65022	Z3/45407	26	Gear ... ..	"	1	
9/15/65023	R12248	27	Bush ... ..	"	1	
9/15/65024	R6704	28	Lever ... ..	"	1	
9/15/65025	R32474		Pin, Locating ... ..	"	2	
9/15/65026	Z1/10146		Washer, Thrust ... ..	"	1	
9/15/65027	R32475		Nut, Plain, $\frac{1}{2}$ " B.S.F. ... ..	"	1	
9/15/65028	D30649		Washer, Grover, $\frac{1}{2}$ " ... ..	"	1	
9/15/65029	Z1/30803	29				
	85-36	30				
	135-36	31				

B.R. Cat. No.	A.E.C. Basic Part No.	Plate Ref.	Designation	Used on	No. Req. per Control Gear	Remarks
		<b>RI</b>	<b>CONTROL GEAR—Continued</b>	<b>All Models</b>		
			<b>THROTTLE CONTROLLER—Continued</b>			
			<b>OPERATING SHAFT AND LEVER</b> ...	"	1	
9/15/65030	R7208	32	<b>Spring, Return</b> ... ..	"	1	
9/15/65031	Z45286	33	<b>Anchor, Spring</b> ... ..	"	1	
9/15/65032	G22607		<b>Link</b> ... ..	"	2	Intermediate Shaft
9/15/65033	R10919	34	<b>Pin, Link</b> ... ..	"	2	} Link
9/15/65034	Z1/47033	35	<b>Washer, Plain, <math>\frac{3}{8}</math>"</b> ... ..	"	4	
	I34-4	36	<b>Split, Pin, <math>\frac{3}{32}</math>" x <math>\frac{3}{4}</math>"</b> ... ..	"	2	
	I00-8	37	<b>OPERATING LEVER END AND SHAFT...</b>	"	1	
9/15/65035	R7209	38	<b>Ball, Bakelite, 32 m/m. Dia.</b> ... ..	"	1	
9/15/65036	E11113		<b>Pin, Steel, 12 I.W.G.</b> ... ..	"	1	
	219-56		<b>Bolt, Special</b> ... ..	"	1	} Clamp
9/15/65037	Z13/30702	40	<b>Washer, <math>\frac{1}{4}</math>" Grover...</b> ... ..	"	1	
	Z3/30616	41	<b>Nut, <math>\frac{1}{4}</math>" B.S.F. Plain...</b> ... ..	"	1	
	Z2/32045	42	<b>Key, Woodruff No. 3</b> ... ..	"	1	
	I57-3	43	<b>FIXED CONTACT AND CONTACT BOARD</b> ... ..	"	1	
9/15/65038	R7407	44	<b>Contact, Fixed</b> ... ..	"	4 pr.	
9/15/65039	V38005		<b>Board, Contact</b> ... ..	"	1	
9/15/65040	V17226		<b>Strip, Bonding</b> ... ..	"	1	
9/15/65041	V14106		<b>Block, Contact Board</b> ... ..	"	1	
9/15/65042	V17225		<b>Screw, Ch. Hd., No. 2 B.A. x <math>1\frac{1}{8}</math>"</b> ... ..	"	1	
	I42-63		<b>Nut, Plain, No. 2 B.A.</b> ... ..	"	1	
	I49-3		<b>Washer, Brass, 5-0 m/m.</b> ... ..	"	1	
9/15/65043	I52-9		<b>Washer, Spring, No. 2 B.A.</b> ... ..	"	1	
	I53-11		<b>Screw, Ch. Hd., No. 2 B.A. x <math>1\frac{1}{8}</math>"</b> ... ..	"	2	} Contact Board
9/15/65043	I42-63		<b>Washer, Brass, 5-0 m/m.</b> ... ..	"	2	

B.R. Cat. No.	A.E.C. Basic Part No.	Plate Ref.	Designation	Used on	No. Req. per Control Gear	Remarks
		<b>RI</b>	<b>CONTROL GEAR—Continued</b>			
9/15/65045	R7712		<b>GEAR BOX CONTROLLER COMPLETE</b>	Not R214E	} 1	
9/15/65077	R7713		<b>GEAR BOX CONTROLLER COMPLETE...</b>	R214E		
9/15/65046	R1/32409	} 48	Casing, Controller ...	Not R214E	} 1	
9/15/65078	R1/32410		Casing, Controller ...	R214E		
9/15/65047	R1/32411	49	Cover, Top ...	All Models	1	
9/15/65048	Z12/30708	50	Screw, Special ...		8	Top Cover
9/15/65049	R1/32417	51	Cover, Side ...		1	
9/15/65009	Z12/30740	52	Screw, Special ...		8	Side Cover
9/15/65050	Z47614	53	Plug, Special...		1	
9/15/65051	339-997	54	Coupling, Flexible Metallic Tube...		1	
9/15/65003	Z1/10147	55	<b>Bush, <math>\frac{1}{8}</math>" Length</b> ...		1	Direction Selecting Camshaft
9/15/65017	Z1/30802	56	Washer, Thrust ...		1	
9/15/65052	R6709	57	<b>DIRECTION SELECTING CAMSHAFT COMPLETE</b> ...		1	
9/15/65028	D30649		Pin, Locating, 0.092" Dia. $\times \frac{27}{64}$ " ...		4	} Camshaft
9/15/65053	R32479		Plate, Selecting ...		1	
9/15/99076	196-1		Rivet, $\frac{1}{4}$ " Dia., Steel, Special ...		1	
	156-168		Key, $\frac{1}{4}$ " $\times \frac{3}{16}$ " $\times \frac{7}{8}$ " ...		1	
9/15/65054	108-22		Rivet, Copper, $\frac{1}{8}$ " $\times \frac{3}{4}$ ", Csk. ...		1	
9/15/65055	Z7/44853	58	Distance Piece ...		1	
9/15/65056	Z1/10149	59	<b>Bush, <math>1\frac{1}{32}</math>" Length</b> ...		1	Direction Selecting Camshaft
9/15/65057	R7001	60/61	<b>LOCKING LEVER COMPLETE WITH PLUG</b> ...		1	
9/15/65058	R32485	62	Plate, Locking ...		1	
9/15/65059	Z12/30714	63	Screw, Special ...		2	
9/15/65003	Z1/10147	64	<b>Bush, Gear Change Camshaft...</b> ...		1	
9/15/65017	Z1/30802	65	Washer, Thrust ...		1	
9/15/65061	R6710	66	<b>CAMSHAFT, GEAR CHANGE COMPLETE</b>		1	
9/15/65062	R10498		Shaft, Cam ...		1	
9/15/65063	R1/32404		Cam, Hole Drilled 1 Wall Only ...		3	
9/15/65064	R1/32405		Cam, Hole Drilled Through ...		1	
9/15/65065	R32488		Plate, Speed Indicator ...		1	
9/15/65028	D30649		Pin, Locating, 0.092" Dia. $\times \frac{27}{64}$ " ...		3	
9/15/99076	196-1		Rivet, Locating $\frac{1}{4}$ " Dia., Steel, Special ...		2	
9/15/65055	Z7/44853	67	Distance Piece ...		1	
9/15/65068	Z1/10150	68	<b>Bush, Gear Change Camshaft</b> ...		1	
9/15/65069	R1/32402	69	Sleeve, Adaptor ...		1	Top Cover
9/15/65070	R32484	70	Plate ...		1	Selector Lever Plate
9/15/65071	Z14/30720		Screw, Special, Csk. ...		4	
9/15/65072	R2/11262	73	Lever, Gear Change ...		1	
9/15/65073	R32432	74	Screw, Special ...		1	
	157-6	75	Key, Woodruff, No. 6 ...		1	
9/15/65074	R32492	76	Housing, Locking Plunger...		1	} Locking Plunger
9/15/65059	Z12/30714	77	Screw, Special, Csk. ...		6	
9/15/65076	R32466	78	Plunger ...		2	
9/15/65005	Z1/45442	79	<b>Spring</b> ...		2	
	28-51		Bolt, No. 2 B.A. $\times 3\frac{1}{8}$ " ...		2	
	149-14		Nut, Plain, No. 2 B.A. ...		2	
	153-19		Washer, Grover, $\frac{3}{16}$ " ...		2	
9/15/65238	R32414	80	Interlock ...		1	

B.R. Cat. No.	A.E.C. Basic Part No.	Plate Ref.	Designation	Used on	No. Req. per Control Gear	Remarks	
		<b>RI</b>	<b>CONTROL GEAR—Continued</b>				
			<b>GEAR BOX CONTROLLER—Continued</b>				
			<b>FIXED CONTACT BOARD COMPLETE</b>	All Models			
9/15/65079	R7406	81	Board ... ..	"	1	F.W.D.—Reverse	
9/15/65080	V17227		Contact, Fixed ... ..	"	1		
9/15/65039	V38005		Strip, Bonding ... ..	"	4 prs.	} Contact Board Block	
9/15/65041	V14106		Block ... ..	"	1		
9/15/65081	V17228		Bolt, Ch. Hd., No. 2 B.A. × 1 $\frac{1}{8}$ " ... ..	"	2		
	I42-63		Nut, Plain No. 2 B.A. ... ..	"	2		
	I49-3		Washer, Brass, 5-0 m/m. ... ..	"	2		
	I52-9		Washer, Grover, $\frac{3}{16}$ " ... ..	"	2		
	I53-11			"	1		
9/15/65082	R7408	82	<b>FIXED CONTACT BOARD COMPLETE</b>	"	1		} Gear Change
9/15/65083	V17229		Board ... ..	"	1		
9/15/65039	V38005		Contact, Fixed ... ..	"	4 prs.		} Contact Board Block
9/15/65041	V14106		Strip, Bonding ... ..	"	1		
9/15/65084	499-2495		<b>BONDING CABLE COMPLETE</b>	"	1		
9/15/65081	V17228		Block ... ..	"	1		
	I42-63		Bolt, Ch. Hd., No. 2 B.A. × 1 $\frac{1}{8}$ " ... ..	"	2		
	I49-3		Nut, Plain, No. 2 B.A. ... ..	"	2		
	I52-9		Washer, Brass, 5-0 m/m. ... ..	"	2		
	I53-11		Washer, Grover, $\frac{3}{16}$ " ... ..	"	2		
9/15/65018	V38072	83	<b>MOVING CONTACTS COMPLETE</b>	"	8	} Moving Contacts	
9/15/65085	R10495	84	Shaft ... ..	"	2		
	90-37	85	Locknut, $\frac{5}{8}$ " B.S.F. ... ..	"	2		
9/15/65020	Z6/44883	86	Distance Piece, $\frac{5}{16}$ " ... ..	"	5		
	Z6/30608	87	Washer, Plain, $\frac{3}{8}$ " Dia. ... ..	"	1		
	100-16	88	Split Pin, $\frac{1}{8}$ " × 1 $\frac{3}{8}$ " ... ..	"	4		
9/15/65022	Z3/45407	89	<b>Spring</b> ... ..	"	4		
9/15/65086	R13530	90	Bracket ... ..	"	2		} Contact Board
	I42-63	91	Bolt, No. 2 B.A. × 1 $\frac{1}{8}$ " ... ..	"	2		
	I49-3	92	Nut, Plain, No. 2 B.A. ... ..	"	2		} Contact Board Bracket
	I53-11	93	Washer, Grover, $\frac{3}{16}$ " ... ..	"	2		
	I42-21	94	Screw, No. 2 B.A. × $\frac{5}{16}$ " ... ..	"	2	} Contact Board	
	I42-63		Screw, No. 2 B.A. × 1 $\frac{1}{8}$ " ... ..	"	2		
	I53-11		Washer, Grover, $\frac{3}{16}$ " ... ..	"	2	} 4 Off on R214E	
9/15/65087	41-61		Bolt, $\frac{3}{8}$ " B.S.F. × 1", Special Drilled	Controller R214A/B/C/D/F	3		
	I35-34		Washer, Grover $\frac{3}{8}$ " ... ..	Casing	3		

B.R. Cat. No.	A.E.C. Basic Part No.	Plate Ref.	Designation	Used on	No. Req. per Control Gear	Remarks
9/15/65088	373-406	RI 95	<b>CONTROL GEAR</b> —Continued ... ..			
9/15/65089	373-415		<b>ENGINE SPEED INDICATOR, EVERETT</b> <b>EDGECUMBE No. D16944</b> ... ..	R214A/B	1	
9/15/65090	5041-1		<b>ENGINE SPEED INDICATOR, SMITHS</b> <b>RMC 58/1</b> ... ..	R214C/D/F		
9/15/65091	V1/5107	R4	<b>AIR PRESSURE GAUGE, BUDENBURG</b> <b>No. P2832</b> ... ..	"	1	
9/15/65092	V5026	1	<b>CONTROL PANEL COMPLETE</b> ... ..	R214A/B/C/D/F	2	
9/15/65093	V1/14506	2	<b>SIDE SUPPORT AND HANK BUSH</b> ... ..	"	2	
9/15/65094	V1/14507	3	Strip, Support, Button, 2 Holes ... ..	"	4	Length 6" with 2 Holes $\frac{29}{32}$ "
		4	Strip, Support, Button, 1 Hole ... ..	"	1	Length 6" with 1 Hole $\frac{29}{32}$ "
	145-18	4	Screw, Csk., No. 2 B.A. $\times \frac{1}{2}$ " ... ..	"	20	Stop Switch
	149-14	5	Nut, Plain, No. 2 B.A. ... ..	"	20	Support Strip
	153-19	6	Washer, Grover, No. 2 B.A. ... ..	"	20	
9/15/65095	V15734	7	Bracket, Support Lamp, Holder ... ..	"	4	
	145-18	8	Screw, Csk., No. 2 B.A. $\times \frac{1}{2}$ " ... ..	"	16	Lampholder Bracket
	149-14	9	Nut, Plain, No. 2 B.A. ... ..	"	16	
	153-19	10	Washer, Grover, No. 2 B.A. ... ..	"	16	
9/15/63794	339-1327	11	Holder, Lamp, "Bill" Switchgear L.H.15 ... ..	"	12	
	147-31	12	Screw, Rd. Hd., No. 5 B.A. $\times \frac{3}{8}$ " ... ..	"	24	
	149-17	13	Nut, Plain, No. 5 B.A. ... ..	"	24	
	153-22	14	Washer, Grover, No. 5 B.A. ... ..	"	24	
9/15/63795	416-364	15	<b>Bulb, 35 V., 6 W., S.B.C., Double Contact</b> ... ..	"	12	
9/15/63777	546-1198	16	<b>Switch, Press Button, C.A.V. No. 108-3</b> ... ..	"	9	
	143-18	17	Screw, Ch. Hd., No. 2 B.A. $\times \frac{1}{2}$ " ... ..	"	18	
	153-19	18	Washer, Grover, No. 2 B.A. ... ..	"	18	
9/15/65096	V16422	19	Plate, Cover ... ..	"	1	
9/15/65097	V7518	20	<b>SUPPORT PLATE COMPLETE</b> ... ..	"	4	
9/15/65098	Z17/30793	21	Screw, Special ... ..	"	16	
	Z4/30698		Washer, 2 B.A., Grover ... ..	"	16	
	149-14		Nut, Plain, No. 2 B.A. ... ..	"	16	
9/15/65099	Z110657	22	Bush, Blue ... ..	"	4	
9/15/65100	Z10658	23	Bush, Off White ... ..	"	8	
9/15/65101	Z12/30741		Screw, Special ... ..	"	2	
	Z4/30690		Washer, $\frac{1}{2}$ " Thackray ... ..	"	2	
9/15/65102	V1/5122		<b>INSTRUMENT PANEL COMPLETE</b> ... ..	R214E	1	
9/15/65103	V16425		Panel ... ..	"	1	
9/15/65089	373-415		<b>ENGINE SPEED INDICATOR, SMITHS</b> <b>RMC 58/1</b> ... ..	"	1	
9/15/65104	Z13/30712		Bolt, Special ... ..	"	4	
	85-32		Nut, Plain, $\frac{1}{4}$ " B.S.F. ... ..	"	4	
	153-17		Washer, Grover, No. 0 B.A. ... ..	"	4	
9/15/63794	339-1327		Lampholder, "Bill" Switchgear No. L.H.15 ... ..	"	5	
	147-31		Screw, Rd. Hd., No. 5 B.A. $\times \frac{3}{8}$ " ... ..	"	10	
	149-17		Nut, Plain, No. 5 B.A. ... ..	"	10	
	153-22		Washer, Grover, No. 5 B.A. ... ..	"	10	
9/15/63795	416-364		<b>Bulb, 35 V., 6 W., S.B.C., Double Contact</b> ... ..	"	5	
9/15/65382	5041-2		<b>Air Pressure Gauge, Budenburg</b> ... ..	"	1	
9/15/65105	Z12/30721		Screw, Special ... ..	"	3	
	149-14		Nut, Plain, No. 2 B.A. ... ..	"	3	
	153-19		Washer, Grover, No. 2 B.A. ... ..	"	3	
9/15/65106	V1/5123		<b>ENGINE CONTROL PANEL COMPLETE</b> ... ..	"	1	
9/15/63792	546-1390		<b>Change-Over Switch, Bulgin 5603/PD</b> ... ..	"	1	R.P.M.
9/15/63793	546-1391		<b>Switch, Bulgin 5602/PD</b> ... ..	"	1	Panel Lights
9/15/65107	339-1375		<b>Signal Lamp Fitting, Bulgin D133/G—Blue</b> ... ..	"	19	
9/15/65108	416-371		<b>Bulb, 32 V., 2-8 W.</b> ... ..	"	19	
9/15/63788	546-1393		<b>Push Button, C.A.V. No. 108/43</b> ... ..	"	2	Start
9/15/63789	546-1394		<b>Push Button, C.A.V. No. 108/4</b> ... ..	"	1	Stop
	146-12		Screw, Rd. Hd., No. 2 B.A. $\times \frac{1}{2}$ " ... ..	"	6	
	153-19		Washer, Grover, No. 2 B.A. ... ..	"	6	

B.R. Cat. No.	A.E.C. Basic Part No.	Plate Ref.	Designation	Used on	No. Req. per Control Gear	Remarks	
		<b>R4</b>	<b>CONTROL GEAR—Continued</b>				
9/15/65110	V7521		<b>ELECTRIC PNEUMATIC VALVE COMPLETE</b> ... ..	R214A	} 1		
9/15/65111	V7519		<b>ELECTRIC PNEUMATIC VALVE COMPLETE</b> ... ..	R214C/E/F			
9/15/65112	V7504	24	<b>VALVE CASING WITH STIFFENERS</b> ...	R214A/C/E/F	1	Not supplied as Spares	
	V38050		Casing, Bare ... ..	"	1		
9/15/65113	Z7/30570	25	Stud, Special, $\frac{7}{16}$ " B.S.F. $\times 4\frac{1}{2}$ " ... ..	"	1		
	90-34		Locknut, $\frac{7}{16}$ " B.S.F. ... ..	"	1		
9/15/65114	V38043	26	Bar, Locating ... ..	"	6		
9/15/65115	112-72	27	Rivet, Iron, Csk., $\frac{1}{8}$ " $\times \frac{1}{2}$ " ... ..	"	12		
9/15/65051	339-997	28	Coupling, Flexible Metallic Tube ... ..	"	1		
9/15/65116	V38045		Number Plate ... ..	R214C/E/F	5		} 6 off } On R214A 12 off }
9/15/65117	107-4		Rivet, Brass, Snap Hd., $\frac{3}{32}$ " $\times \frac{9}{32}$ " ... ..	"	10		
9/15/65118	V38052	29	Cover ... ..	R214A/C/E/F	1		} Valve Casing
9/15/65119	Z51738	30	<b>Felt Seal, 8<math>\frac{1}{8}</math>" Long</b> ... ..	"	2		
9/15/65120	Z51739	31	<b>Felt Seal, 19<math>\frac{3}{8}</math>" Long</b> ... ..	"	2		
9/15/65121	V38044	32	Boss, Thumb Screw ... ..	"	1		
9/15/65122	114-188	33	Rivet, Snap Hd., $\frac{3}{32}$ " $\times \frac{5}{8}$ ", Mild Steel ... ..	"	4		
9/15/65123	A74103	34	Nut, Special ... ..	"	1		
9/15/65124	Z48801	35	Circlip, A.E.C. Special ... ..	"	1		
9/15/65125	V38051	36	Block, Manifold ... ..	"	1		
9/15/65126	Z1/44569	37	Plug, Special ... ..	"	5		
	117-83	38	Screw, Csk., $\frac{5}{16}$ " B.S.F. $\times \frac{3}{4}$ " ... ..	"	3		
9/15/65127	124-158	39	Stud, $\frac{3}{8}$ " B.S.F. $\times 1\frac{7}{8}$ ", Special ... ..	"	4		
	85-34	40	Nut, Plain, $\frac{3}{8}$ " B.S.F. ... ..	"	4		
	135-34	41	Washer, Grover, $\frac{3}{8}$ " ... ..	"	4		
9/15/65128	Z3/10201	42	<b>Bush</b> ... ..	R214C/E/F	10	} 12 off on R.214A	
9/15/65129	V38006	43	<b>ELECTRIC PNEUMATIC VALVE</b> ... ..	R214A/C/E/F	1		
9/15/65130	V38007	44	<b>ELECTRIC PNEUMATIC VALVE</b> ... ..	"	4	"Off" Type } B.T.H. Drg.	
9/15/65131	Z51740	45	<b>Gasket, B.T.H. X1216778-12</b> ... ..	"	1	"On" Type } W. 136.Z147	
						"Off" Type } Valves and Blanking Plates	
9/15/65132	Z51741	46	<b>Gasket, B.T.H. X1216778-1</b> ... ..	"	5	"On" Type }	
9/15/65133	Z12/30763	47	Bolt, Special, $\frac{3}{8}$ " B.S.F. $\times 2\frac{1}{4}$ ", Drilled ... ..	"	2		
9/15/65134	Z12/30760	48	Bolt, Special, $\frac{3}{8}$ " B.S.F. $\times 2\frac{1}{2}$ ", Drilled ... ..	"	8		
9/15/35459	Z11/30783		Bolt, Special, $\frac{3}{8}$ " B.S.F. $\times 1\frac{1}{2}$ ", Drilled ... ..	"	2		
	Z4/30696	49	Washer, Special ... ..	"	12		
9/15/65135	331-49	50	Plug, $\frac{3}{8}$ " Gas ... ..	"	2		
9/15/65136	331-48	51	Plug, $\frac{1}{4}$ " Gas ... ..	"	6		
9/15/65137	V38046		Blanking Plate ... ..	"	1		
9/15/65138	V38036		Support ... ..	R214C/E/F	} 1	} Control Wiring	
9/15/65139	V38094		Support ... ..	R214A			

B.R. Cat. No.	A.E.C. Basic Part No.	Plate Ref.	Designation	Used on	No. Req. per Control Gear	Remarks
9/15/65140	V7520	R4	<b>CONTROL GEAR—Continued</b>			
			<b>ELECTRIC PNEUMATIC VALVE COMPLETE</b> ... ..			
9/15/65112	V7504	52	<b>VALVE CASING WITH STIFFENER</b> ... ..	R214A/C/E/F	1	
	V38050		Casing, Bare ... ..	"	1	
9/15/65113	Z7/30570	53	Stud, Special, $\frac{7}{16}$ " B.S.F. $\times 4\frac{1}{8}$ "	"	1	Not supplied as Spares
	90-34		Locknut, $\frac{7}{16}$ " B.S.F. ... ..	"	1	
9/15/65114	V38043	54	Bar, Locating ... ..	"	1	
9/15/65115	112-72	55	Rivet, Iron, Csk., $\frac{1}{8}$ " $\times \frac{1}{2}$ " ... ..	"	6	
9/15/65051	339-997	56	Coupling, Flexible Metallic Tube ... ..	"	12	
9/15/65116	V38045		Number Plate ... ..	"	1	
9/15/65117	107-4		Rivet, Brass, Snap Hd., $\frac{3}{32}$ " $\times \frac{9}{32}$ " ... ..	"	4	
9/15/65118	V38052	57	Cover ... ..	"	8	
9/15/65119	Z51738	58	<b>Felt Seal, <math>8\frac{1}{8}</math>" Long</b> ... ..	"	1	
9/15/65120	Z51739	59	<b>Felt Seal, <math>19\frac{3}{8}</math>" Long</b> ... ..	"	2	
9/15/65121	V38044	60	Boss, Thumb Screw ... ..	"	2	
9/15/65122	114-188	61	Rivet, Snap Hd., $\frac{5}{32}$ " $\times \frac{5}{8}$ ", Mild Steel	"	1	
9/15/65123	A74103	62	Nut, Special ... ..	"	4	
9/15/65124	Z48801	63	Circlip, A.E.C., Special ... ..	"	1	
9/15/65141	V38073	64	Block, Manifold ... ..	"	1	
9/15/65126	Z1/44569	65	Plug, Special... ..	"	1	
	117-83	66	Screw, Csk., $\frac{5}{16}$ " B.S.F. $\times \frac{3}{4}$ " ... ..	"	5	
9/15/65127	124-158	67	Stud, $\frac{3}{8}$ " B.S.F. $\times 1\frac{7}{8}$ ", Special	"	3	
	85-34	68	Nut, Plain, $\frac{3}{8}$ " B.S.F. ... ..	"	4	
	135-34	69	Washer, Grover, $\frac{3}{8}$ " ... ..	"	4	
9/15/65128	Z3/10201	70	<b>Bush</b> ... ..	"	4	
9/15/65130	V38007	71	<b>ELECTRIC PNEUMATIC VALVE</b> ... ..	"	8	
			<b>ELECTRIC PNEUMATIC VALVE</b> ... ..	"	4	
9/15/65137	V38046	72	Blanking Plate ... ..	"	1	"On" Type B.T.H. Drg. W.1362147
9/15/65240	V38047		Blanking Plate ... ..	"	1	
9/15/65131	Z51740	73	<b>Gasket, B.T.H. X1216778-12</b> ... ..	"	1	
9/15/65132	Z51741	74	<b>Gasket, B.T.H. X1216778-1</b> ... ..	"	1	"On" Type } Valves and Blanking Plates
9/15/65134	Z12/30760	75	Bolt, Special, $\frac{3}{8}$ " B.S.F. $\times 2\frac{1}{4}$ ", Drilled	"	5	
9/15/35459	Z11/30783		Bolt, Special, $\frac{3}{8}$ " B.S.F. $\times 1\frac{1}{2}$ ", Drilled	"	8	
	Z4/30696	76	Washer, Special ... ..	"	4	
9/15/65135	331-49	77	Plug, $\frac{3}{8}$ " Gas ... ..	"	12	
9/15/65136	331-48	78	Plug, $\frac{1}{4}$ " Gas ... ..	"	2	
9/15/65434	V38089		Support ... ..	"	6	
				"	1	Control Wiring

B.R. Cat. No.	A.E.C. Basic Part No.	Plate Ref.	Designation	Used on	No. Req. per Control Gear	Remarks
			<b>CONTROL GEAR—Continued</b>			
			<b>CONDUITS AND FITTINGS ...</b>	R214C/D		
				R214C		
	404-8		Conduit, 2" ...		140 ft.	
	404-7		Conduit, 1 1/2" ...	"	28 ft.	
	404-6		Conduit, 1 1/4" ...	"	7 ft.	
	404-5		Conduit, 1" ...	"	7 ft.	
	404-4		Conduit, 3/4" ...	"	42 ft.	
	404-3		Conduit, 5/8" ...	"	1 ft.	
	410-19		Tee, Inspection, 2" ...	"	6	
	410-18		Tee, Inspection, 1 1/2" ...	"	6	
	410-45		Tee, Inspection, 1" ...	"	1	
	410-15		Tee, Inspection, 3/4" ...	"	5	
	408-16		Elbow, Inspection, 2" ...	"	6	
	408-17		Elbow, Inspection, 1 1/4" ...	"	2	
	410-48		Elbow, Inspection, 1" ...	"	2	
	408-12		Elbow, Inspection, 3/4" ...	"	5	
	410-42		Coupler, Solid, 2" ...	"	20	
	410-64		Coupler, Solid, 1 1/2" ...	"	3	
	410-63		Coupler, Solid, 1 1/4" ...	"	3	
	410-43		Coupler, Solid, 1" ...	"	2	
	410-62		Coupler, Solid, 3/4" ...	"	7	
	409-20		Backnut, 2" ...	"	55	
	409-19		Backnut, 1 1/2" ...	"	10	
	409-18		Backnut, 1 1/4" ...	"	10	
	409-17		Backnut, 1" ...	"	6	
	409-16		Backnut, 3/4" ...	"	23	
	409-24		Backnut, 5/8" ...	"	2	
	407-48		Bush, Brass Ring, 2" ...	"	20	
	407-46		Bush, Brass Ring, 1 1/2" ...	"	5	
	407-43		Bush, Brass Ring, 1 1/4" ...	"	8	
	407-42		Bush, Brass Ring, 1 1/8" ...	"	2	
	407-44		Bush, Brass Ring, 1" ...	"	1	
	407-45		Bush, Brass Ring, 1 1/4" ...	"	3	
	407-38		Bush, Brass, Male, 2" ...	"	3	
	407-35		Bush, Brass, Male, 1 1/4" ...	"	6	
	407-34		Bush, Brass, Male, 1" ...	"	5	
	407-33		Bush, Brass, Male, 3/4" ...	"	4	
	409-10		Socket, Reducing, 1 1/4" x 3/4" ...	"	3	
	410-58		Socket, Reducing, 1 1/2" x 3/4" ...	"	4	
	409-6		Socket, Reducing, 1 1/2" x 1" ...	"	2	
	409-3		Socket, Reducing, 1 1/2" x 1 1/4" ...	"	3	
	409-5		Socket, Reducing, 2" x 1 1/4" ...	"	5	
	409-4		Socket, Reducing, 2" x 1 1/2" ...	"	2	
	409-7		Socket, Reducing, 2" x 1" ...	"	3	
	409-1		Socket, Reducing, 1" x 3/4" ...	"	2	
	409-8		Socket, Reducing, 3/4" x 5/8" ...	"	3	
	409-2		Socket, Reducing, 1 1/4" x 1" ...	"	2	
	410-55		Nipple, 2" ...	"	1	
	410-57		Nipple, 3/4" ...	"	3	
	406-47		Box, Connection, 6" x 6" x 3" ...	"	2	
	V7532		<b>CONNECTION BOX COMPLETE ...</b>	"	2	
	471-9		Tubing, Metallic, 1 1/4" ...	"	1	
	471-15		Tubing, Metallic, 1" ...	"	2	
	499-2472		Tubing, Metallic, 3/4" ...	"	2' 6"	
	410-59		Adaptor, 3/4" ...	"	4	
	410-60		Adaptor ...	"	2	
	410-61		Adaptor ...	"	2	
	410-49		Adaptor, Male ...	"	4	
	404-8		Conduit, 2" ...	R214D	126 ft.	
	408-16		Elbow, Inspection, 2" ...	"	6	
	410-30		Coupler, Running, 2" ...	"	16	
	409-20		Backnut, 2" ...	"	25	
	409-18		Backnut, 1 1/4" ...	"	1	
	407-48		Bush, Brass Ring, 2" ...	"	13	
	407-35		Bush, Brass, Male, 1 1/4" ...	"	2	
	407-33		Bush, Brass, Male, 3/4" ...	"	2	



B.R. Cat. No.	A.E.C. Basic Part No.	Plate Ref.	Designation	Used on	No. Req. per Control Gear	Remarks
		<b>R5</b>	<b>CONTROL GEAR—Continued</b>			
			<b>THROTTLE MOTOR COMPLETE ...</b>			
9/15/65142	R3102		Body ...	R214A/C/E/F	2	A.E.C. Type
9/15/65143	R32401	1	Cover, End ...	"	2	
9/15/65144	R32402	2	Stud, $\frac{3}{8}$ " B.S.F. $\times$ $1\frac{1}{2}$ ", Special	"	2	
9/15/37546	124-1155	3	Nut, Plain, $\frac{3}{8}$ " B.S.F.	"	12	} End Cover
	85-34	4	Washer, Grover, $\frac{3}{8}$ "	"	12	
	135-34	5	Plug, Breather	"	12	
9/15/65145	Z47612	6	Gland	"	2	} Gland
9/15/65146	R32403	7	Packing	"	2	
9/15/65147	R32404	8	Stud, $\frac{5}{16}$ " B.S.F. $\times$ $1\frac{5}{8}$ ", Special	"	2	} Gland
9/15/65148	124-1127	9	Locknut, $\frac{5}{16}$ " B.S.F.	"	4	
	90-32	10	Cylinder, Centre	"	8	} Outer Inner
9/15/65149	D40702	11	Stop Plate	"	2	
9/15/95198	D26903	12	Stop Plate	"	2	} Outer Inner
9/15/65150	D26904	13	Cylinder, End	"	2	
9/15/95186	D40703	14	Stud, Special	"	2	} End Cylinder
9/15/65151	Z6/30577	15	Nut, Plain, $\frac{5}{16}$ " B.S.F.	"	12	
	85-33	16	Washer, Grover, $\frac{5}{16}$ "	"	12	
9/15/65152	D40606	17	Piston, Operating	"	12	} End Cylinder
9/15/65153	Z2/10286	18	Bush	"	2	
9/15/65154	D40604	19	Piston, Intermediate	"	2	} End Cylinder
9/15/65155	D40602	20	Piston, End	"	2	
9/15/95208	G27223	21	Cup Washer	"	2	} End Cylinder
9/15/95201	R10603	22	Spring, Return	"	10	
9/15/65156	81-1994	23	Adaptor Valve	"	2	} Tecaletit Y.28275 (Mod.)
9/15/65157	138-165	24	Washer, Copper, $\frac{3}{16}$ " $\times$ $1$ " $\times$ $\frac{3}{32}$ "	"	6	
9/15/65158	81-2159	25	Adaptor, $\frac{3}{8}$ " B.S.F. $\times$ $\frac{1}{8}$ " B.S. Pipe	"	6	} Lubricator
9/15/32177	43-95		Bolt, $\frac{1}{2}$ " B.S.F. $\times$ $1\frac{1}{2}$ ", Special, Drilled	"	8	
9/15/65159	43-103		Bolt, $\frac{1}{2}$ " B.S.F. $\times$ $2\frac{1}{2}$ ", Special, Drilled	R214C/E	} 8	} Throttle Motor to Frame
	85-36		Nut, Plain, $\frac{1}{2}$ " B.S.F.	R214F		
	135-36		Washer, Grover, $\frac{1}{2}$ "	R214C/E/F	8	} Throttle Motor to Frame
9/15/65160	R10920		Link	"	8	
9/15/65161	R10929	26	Link	R214A/C/E	} 4	} Link
9/15/65162	Z1/47036	27	Pin	R214F		
	100-11	28	Split Pin, $\frac{3}{32}$ " $\times$ $1$ "	R214A/C/E/F	4	} Link
9/15/65163	R32497	29	Lever, Adjustable	"	8	
9/15/65164	R32407	30	Boss	"	2	} Adjustable Lever
9/15/65165	R1/32414		Clamp	R214A	2	
9/15/65166	39-5		Bolt, $\frac{1}{4}$ " B.S.F. $\times$ $1\frac{1}{4}$ ", Special, Drilled	R214C/E/F	2	} Adjustable Lever
	85-32		Nut, Plain, $\frac{1}{4}$ " B.S.F.	"	2	
	135-32		Washer, Grover, $\frac{1}{4}$ "	"	2	} Adjustable Lever
9/15/65167	Z3/32013	31	Nut, Special, $\frac{1}{2}$ " B.S.F.	"	2	
9/15/65168	Z30316	32	Cotter, Special	"	4	} Adjustable Lever
	85-32	33	Nut, Plain, $\frac{1}{4}$ " B.S.F.	R214A	2	
	135-32	34	Washer, Grover, $\frac{1}{4}$ "	"	2	} Adjustable Lever
9/15/65169	R2/1212		CROSS SHAFT COMPLETE	"	2	
9/15/65170	R2/1219	35	CROSS SHAFT COMPLETE	"	2	} Adjustable Lever
9/15/65171	R2/1224		CROSS SHAFT COMPLETE	R214C/E	2	
	157-2		Key, Woodruff, No. 2	R214F	2	} Adjustable Lever
9/15/65172	R32409	36	Trunnion	R214C/E/F	2	
	100-11	37	Split Pin, $\frac{3}{32}$ " $\times$ $1$ "	R214A/C/E/F	2	} Adjustable Lever
				"	4	

B.R. Cat. No.	A.E.C. Basic Part No.	Plate Ref.	Designation	Used on	No. Req. per Control Gear	Remarks
		<b>R5</b>	<b>CONTROL GEAR—Continued</b>			
9/15/65173	R6406	38	<b>CROSS SHAFT BRACKET COMPLETE ...</b>	R214A	2	
9/15/65174	R6405		<b>TUBE AND BOSS COMPLETE ...</b>	"	2	
9/15/65175	Z10232	39	<b>Bush ...</b>	"	4	
9/15/65176	R6408		<b>CROSS SHAFT BRACKET PLATE AND TUBE COMPLETE ...</b>	R214C/E	2	
9/15/65177	R6412	38	<b>CROSS SHAFT BRACKET PLATE AND TUBE COMPLETE ...</b>	R214F	4	
9/15/65175	Z10232	39	<b>Bush ...</b>	R214C/E/F	4	
9/15/65158	81-2159	40	Adaptor, Lubricator, $\frac{3}{8}$ " B.S.F. x $\frac{1}{2}$ " B.S. Pipe	R214A	2	
9/15/65178	41-62	41	Bolt, $\frac{3}{8}$ " B.S.F. x $\frac{1}{2}$ " Special, Drilled	"	6	} 4 off on R214C/E
	85-34	42	Nut, Plain, $\frac{3}{8}$ " B.S.F.	"	6	
	135-34	43	Washer, Grover, $\frac{3}{8}$ "	"	6	
9/15/65179	Z8/30701		Bolt, Special, $\frac{3}{8}$ " B.S.F. x $\frac{1}{2}$ " Drilled	R214F	4	
	86-34		Nut, Slotted, $\frac{3}{8}$ " B.S.F.	"	4	
	134-4		Washer, Plain, $\frac{3}{8}$ "	"	4	
	100-51		Split Pin, $\frac{1}{16}$ " B.S.F. x $\frac{1}{2}$ "	"	4	
9/15/65180	R3/11366	} 44	Rod	R214A	} 2	} To Fuel Pump
9/15/65181	R3/11371		Rod	R214C/E/F/		
9/15/65182	Z3/44849	45	Distance Piece	R214A/C/E/F	2	
9/15/65183	Z1/45467	46	<b>Spring ...</b>	"	2	
	90-34	47	Locknut, $\frac{3}{8}$ " B.S.F.	"	4	
9/15/65184	R17118	48	Fork End	"	2	} Fuel Pump Rod
	90-32	49	Locknut, $\frac{3}{8}$ " B.S.F.	"	2	
9/15/65185	Z49313	50	Pin	"	2	
	86-32	51	Nut, Slotted, $\frac{3}{8}$ " B.S.F.	"	2	
	100-4	52	Split Pin, $\frac{1}{16}$ " x $\frac{1}{2}$ "	"	2	
9/15/46829	R1468		<b>FUEL PUMP LEVER COMPLETE</b>		2	
	R2/11286	53	Lever		2	} Not supplied as Spares
9/15/46830	Z2/10299	54	<b>Bush ...</b>		2	
9/15/46831	39-3	56	Bolt, $\frac{1}{2}$ " B.S.F. x $\frac{1}{2}$ " Special, Drilled		2	
	85-32	57	Nut, Plain, $\frac{1}{2}$ " B.S.F.		2	
	135-32	58	Washer, Grover, $\frac{1}{2}$ "		2	
	Z45298	59	<b>Spring, Pull-Off</b>		2	
9/15/65158	81-2159		Adaptor, Lubricator, $\frac{3}{8}$ " B.S.F. x $\frac{1}{2}$ " B.S. Pipe	R214C/E/F	10	} Fibre
9/15/65186	Z44919		Washer, Special, $\frac{3}{8}$ " x $\frac{1}{2}$ "		10	
9/15/65187	81-1050		Lubricator, Tecalemit Drg. No. N4570E	R214A/C/E/F	10	
9/15/63555	81-320		Adaptor, $\frac{3}{8}$ " Gas	"	10	
9/15/63551	81-265		Locknut	"	10	
9/15/46619	81-264		Nut, Union, Tecalemit CL17C	R214A	12	} 20 off on R214C/E/F
9/15/46582	81-260		Olive, Tecalemit 100E4	"	12	
9/15/63548	216-573		Pipe, "Bundy" Steel, $\frac{3}{8}$ " O.D.	"	} 40 ft.	} 35 ft. on R214C/E/F } Alternatives
9/15/63549	216-282		Pipe, Steel, $\frac{3}{8}$ " O.D. x 18 L.W.G. I.D.	"		
9/15/65188	81-263		<b>ELBOW BASE COMPLETE</b>		8	
9/15/65189	81-268		Base	"	8	
9/15/65190	81-267		Adaptor	"	8	
9/15/65191	81-266		Connection	"	8	
9/15/46619	81-264		Nut, Union, Tecalemit CL17C	"	8	
9/15/46582	81-260		Olive, Tecalemit 100E4	"	8	
9/15/65192	411-190		Clip, S-Way	R214A/C/E/F	2	
9/15/65193	411-117		Clip, I-Way	R214C/E/F	8	
	143-15		Screw, Ch. Hd., No. 2 E.A. x $\frac{1}{2}$ "	R214A	2	} 10 off on R214C/E/F
	149-14		Nut, Plain, No. 2 E.A.	"	2	
	153-19		Washer, Grover, No. 2 E.A.	"	2	
<p><b>NOTE:—For Fuel Pump Lever and Fittings see also Engine Section, No. A51, page A.7</b></p>						

B.R. Cat. No.	A.E.C. Basic Part No.	Plate Ref.	Designation	Used on	No. Req. per Control Gear	Remarks
9/15/65194	5046-2		<b>CONTROL GEAR—Continued</b>			
			<b>SOLENOID COMPLETE, BRITISH THERMOSTAT No. JS2089</b> ... ..	R214A	2	
9/15/56763	39-2		Bolt, $\frac{1}{4}$ " B.S.F. $\times \frac{7}{8}$ ", Special, Drilled	"	4	} Solenoid to Bracket
	90-152		Locknut, $\frac{1}{4}$ " B.S.F., "Simmonds" No. NP-F082	"	4	
9/15/65195	R13540		Bracket ... ..	"	2	
9/15/65087	41-61		Bolt, $\frac{3}{8}$ " B.S.F. $\times 1$ ", Special, Drilled	"	6	} Bracket
	85-34		Nut, Plain, $\frac{3}{8}$ " B.S.F.	"	6	
	135-34		Washer, Grover, $\frac{3}{8}$ "	"	6	
9/15/65196	R3/11213		Lever ... ..	"	2	Solenoid
9/15/65197	R3/11369		Rod, Operating ... ..	"	2	
9/15/65198	Z51765		Fork End, Length $2\frac{3}{4}$ " (Sliding End) ... ..	"	2	} Operating Rod
9/15/65199	139-41		Fork End, Length $1\frac{3}{4}$ " ... ..	"	2	
	90-32		Locknut, $\frac{5}{16}$ " B.S.F.	"	4	
9/15/65200	Z47228		Pin, Length 20 m/m., Special	"	2	
9/15/45546	141-16		Pin, Length $\frac{1}{4}$ " $\times 18$ m/m., Special	"	2	
	Z4/30691		Washer, $\frac{1}{4}$ " Bright Steel	"	2	
	100-5		Split Pin, $\frac{5}{64}$ " $\times \frac{5}{8}$ "	"	4	
	Z45239		<b>Spring, Pull Off</b> ... ..	"	2	
9/15/65201	R7611		<b>ANCHOR BRACKET COMPLETE</b> ... ..	"	2	Pull Off Spring
	121-103		Setscrew, $\frac{1}{4}$ " B.S.F. $\times \frac{3}{8}$ "	"	4	} Anchor Bracket
	135-32		Washer, Grover, $\frac{1}{4}$ "	"	4	
9/15/65202	Z43497		Stop Screw, Special	"	2	} Fuel Pump Lever
9/15/33075	Z2/32047		Nut, Special	"	2	
9/15/65203	499-3030		<b>SOLENOID COMPLETE, C.A.V. No. WN62-2221</b> ... ..	R214/C/E/F	2	
	121-104		Setscrew, $\frac{1}{4}$ " B.S.F. $\times \frac{3}{8}$ "	"	4	} Solenoid to Bracket
	85-32		Nut, Plain, $\frac{1}{4}$ " B.S.F.	"	4	
	135-32		Washer, Grover, $\frac{1}{4}$ "	"	4	
9/15/65204	Z51766		Bracket ... ..	"	2	
	121-103		Setscrew, $\frac{1}{4}$ " B.S.F. $\times \frac{5}{8}$ "	"	4	} Bracket
	135-32		Washer, Grover, $\frac{1}{4}$ "	"	4	
9/15/45540	R17125		Fork End ... ..	"	2	Solenoid
	90-31		Locknut, $\frac{1}{4}$ " B.S.F.	"	2	
9/15/45546	141-16		Pin, Special, $\frac{1}{4}$ " Dia. $\times 18$ m/m.	"	2	} Fork End
	100-5		Split Pin, $\frac{5}{64}$ " $\times \frac{5}{8}$ "	"	2	
9/15/65205	5110-1		<b>FLOAT SWITCH COMPLETE, MOBREY TYPE S01A/F02A</b> ... ..	R21A/C/E/F	2	

B.R. Cat. No.	A.E.C. Basic Part No.	Plate Ref.	Designation	Used on	No. Req. per Control Gear	Remarks
<b>CONTROL GEAR—Continued</b>						
9/15/65206	5004-11		<b>AIR CLEANER AND ANTI-FREEZER, CLAYTON DEWANDRE A.P.S.A. 372-1</b> ...	R214/A/C/E/F	2	} Compressor Delivery Compressor Delivery Compressor Suction
	310-82		Hose, Flexible, $\frac{5}{8}$ " I/D. $\times$ $1\frac{1}{8}$ " O/D. $\times$ 20 $\frac{1}{4}$ " ...	R214A/E	2	
	332-68		Clip, Jubilee, No. 1 ...	"	4	
	310-89		Hose, Flexible, $\frac{5}{8}$ " I/D. $\times$ $1\frac{1}{8}$ " O/D. $\times$ 12" ...	R214C	2	
	310-81		Hose, Flexible, $\frac{7}{8}$ " I/D. $\times$ $1\frac{1}{4}$ " O/D. $\times$ 12" ...	"	2	
	332-68		Clip, Jubilee, No. 1 ...	"	8	
	81-870		Hose, Flexible, $\frac{1}{2}$ " I/D. $\times$ $1\frac{5}{8}$ " O/D. $\times$ 18" ...	"	4	
	332-68		Clip, Jubilee, No. 1 ...	"	8	
9/15/65207	5006-308		<b>NON RETURN VALVE, CLAYTON DEWANDRE, AP.SA68</b> ...	R214A/C/E/F	2	
9/15/65208	5006-504		Body, Clayton AP5006-1 ...	"	2	
9/15/65209	5001-140		Trip Valve with Seat, Clayton AP.SA-39 ...	"	2	
9/15/65210	5006-495		Spring, Clayton AP5134 ...	"	2	
9/15/65211	5001-143		Adaptor Nut, Clayton AP5484-1 ...	"	2	
9/15/65212	138-142		Washer, Copper, 30.5 $\times$ 38 $\times$ 2 m/m. ...	"	2	
9/15/65213	5006-505		Plate, Locking, Clayton SO 2055 ...	"	2	
9/15/65214	5001-144		Screw, Clayton SF8-13 ...	"	2	
	135-32		Washer, Grover, $\frac{1}{2}$ " ...	"	2	
9/15/65215	GA0903		<b>AIR RESERVOIR COMPLETE WITH SAFETY VALVE AND BLANKING PIECE</b> ...	R214A/C	} 1	
9/15/65216	GA0904		<b>AIR RESERVOIR COMPLETE WITH SAFETY VALVE AND BLANKING PIECE</b> ...	R214F		
9/15/65217	GA0905		<b>AIR RESERVOIR COMPLETE WITH SAFETY VALVE AND BLANKING PIECE</b> ...	R214E		
9/15/65218	5006-442		<b>AIR RESERVOIR COMPLETE, CLAYTON DEWANDRE AP.GA4624-1</b> ...	R214A/C		
9/15/65219	5006-443		<b>AIR RESERVOIR COMPLETE, CLAYTON DEWANDRE</b> ...	R214F		
9/15/65220	5006-444		<b>AIR RESERVOIR COMPLETE, CLAYTON DEWANDRE</b> ...	R214E		
	5021-583		<b>SAFETY VALVE COMPLETE, WESTINGHOUSE A87644-1</b> ...	R214A/C/E/F		
	5021-83		Body, Westinghouse A74387 ...	"		
	5021-82		Valve, Westinghouse A74386 ...	"		
	5021-81		Pivot, Westinghouse A74385 ...	"		
	5021-84		Spring, Westinghouse A75028-1 ...	"		
	5021-85		Cap. Valve, Westinghouse A75062 ...	"		
	5021-87		Locknut, Special, Westinghouse A84202 ...	"		
	5021-333		Adaptor, Westinghouse A74804-2 ...	"		
	219-24		Wire, Locking, Iron, 18 S.W.G. ...	"	As req.	
9/15/65221	501-225		Seal, Lead ...	"	1	
9/15/65222	Z51779		Blanking Piece ...	"	1	
	28-32		Bolt, No. 2 B.A. $\times$ $\frac{3}{4}$ " ...	"	4	
	153-19		Washer, Grover, No. 2 B.A. ...	"	4	
9/15/65223	132-56		Nut, Union ...	"	1	
9/15/65224	Z2/32014		Nut, Special ...	"	1	
9/15/65225	138-214		Washer, Copper, Special, $5\frac{3}{4}$ " Dia. $\times$ 2 m/m. ...	"	1	
9/15/65226	5006-93		<b>AIR RESERVOIR COMPLETE, CLAYTON DEWANDRE AP.GA.4460-1</b> ...	R214A/C/E	1	
9/15/65227	5006-326		<b>AIR RESERVOIR COMPLETE, CLAYTON DEWANDRE</b> ...	R214F	1	
9/15/65228	5006-92		<b>AUXILIARY AIR RESERVOIR, CLAYTON DEWANDRE AP.GA4459</b> ...	R214A/C/E	1	
9/15/65229	5006-327		<b>AUXILIARY AIR RESERVOIR, CLAYTON DEWANDRE</b> ...	R214F	1	
9/15/65230	5004-10		<b>AIR FILTER COMPLETE, CLAYTON DEWANDRE AP.SA209-3</b> ...	R214A/C/E/F	2	
9/15/65231	5001-29		<b>REDUCING VALVE COMPLETE, CLAYTON DEWANDRE AP.GA5154.2</b> ...	"	1	
9/15/65232	5042-1		<b>AIR PRESSURE SWITCH, BTH. TYPE PGS FORM E12</b> ...	"	1	2 Off on DTO1/5

B.R. Cat. No.	A.E.C. Basic Part No.	Plate Ref.	Designation	Used on	No. Req. per Control Gear	Remarks
			<b>CONTROL GEAR—Continued</b>			
9/15/65233	5023-17		Coupling Cock, $\frac{3}{4}$ " ... ..	R214A/B/C/D	2	
9/15/65234	5023-24		Hose, Coupling, $\frac{3}{4}$ " ... ..	"	2	
9/15/65235	5023-19		Dummy Coupling, $\frac{3}{4}$ " ... ..	"	2	
			<b>TERMINALS AND FITTINGS</b>	R214C/D		
	347-90		Terminal, Dynamo ... ..	R214C	475	
	347-214		Terminal ... ..	"	16	Use on 2 B.A. Stud with 60/0-018" Cable
	347-169		Terminal, Starter ... ..	"	4	
	347-90		Terminal, Dynamo ... ..	R214D	300	
	347-214		Terminal ... ..	"	12	Use on 2 B.A. Stud with 60/0-018" Cable
	402-214		Cable, 7/0-029" ... ..	R214C	5,370 ft.	4,140 ft. on R214D
	402-115		Cable, 60/0-018", Black ... ..	R214C/D	140 ft.	
	402-116		Cable, 60/0-018", Red ... ..	"	140 ft.	
	402-217		Cable, 14/0-012" ... ..	R214C	370 ft.	
	402-107		Cable, 61/0-044" ... ..	"	50 ft.	
	402-220		Cable, 35/0-012" ... ..	"	40 ft.	
	499-33		Tape, Adhesive, $\frac{3}{4}$ " ... ..	R214C/D	100 yds.	
	499-924		Sleeve, Identification, S+ ... ..	R214C	2	
	499-928		Sleeve, Identification, S- ... ..	"	2	
9/15/65236	5037-44		<b>COMBINED DEADMAN'S CONTROL VALVE, GRESHAM AND CRAVEN No. 13924</b> ...	DTO1/B, 1/2, 1/5, 1/7	1	

railcar.co.uk



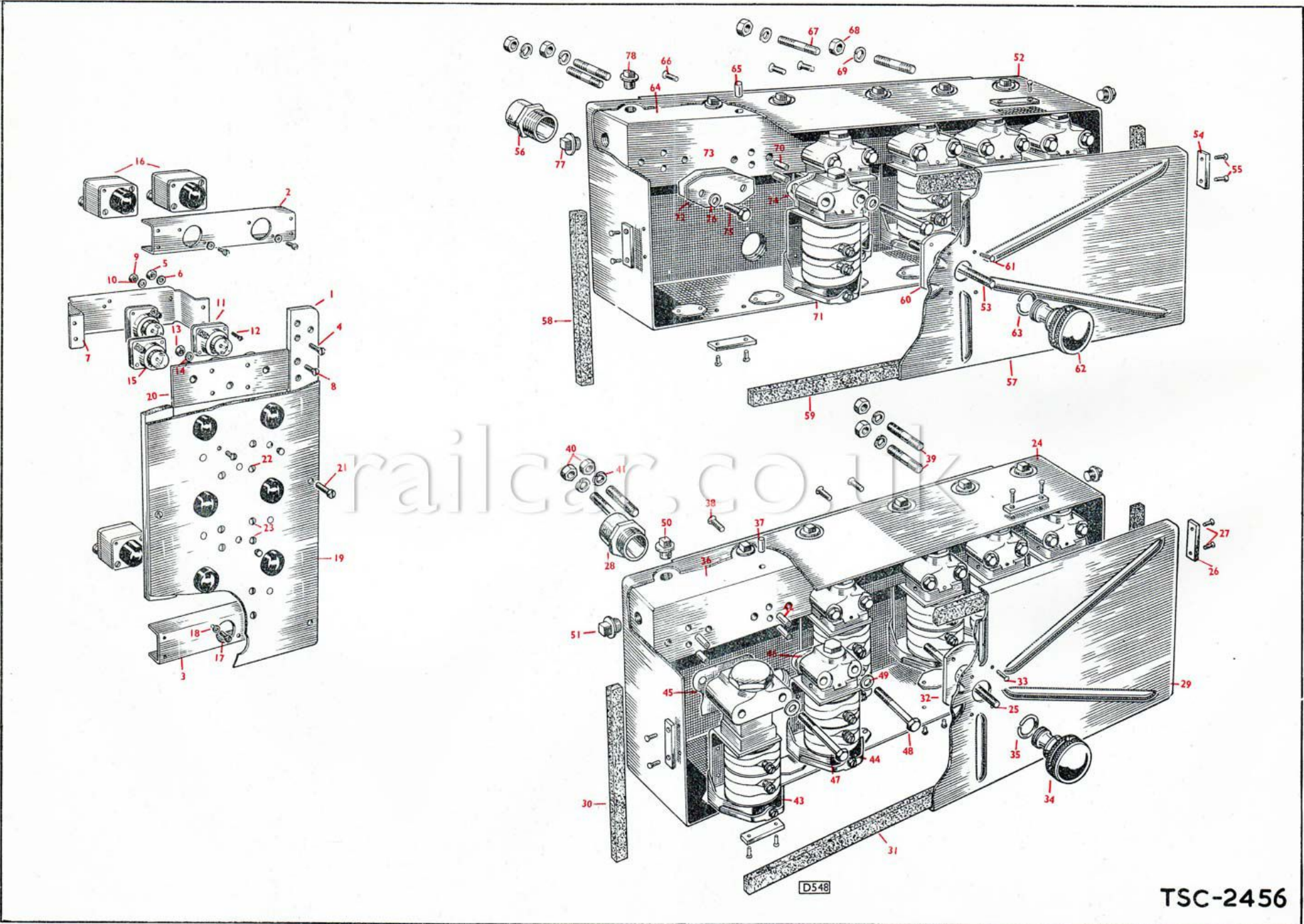

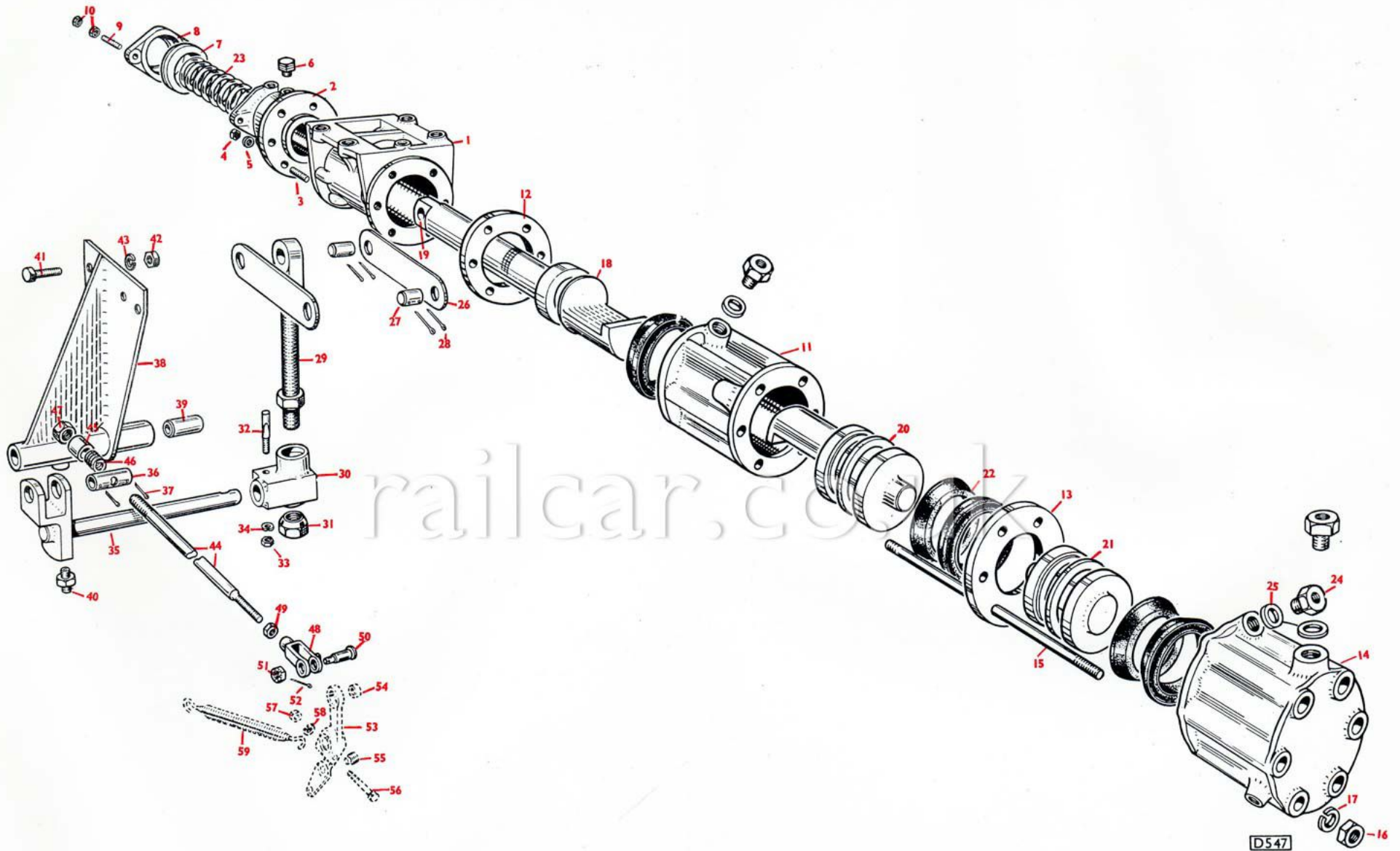

TSC-2498



# CONTROL GEAR SECTION

(A.E.C. TYPE UNITS)

TYPE  
R223 SERIES

railcar.co.uk

**INDEX**  
**UNITS, COMPONENTS AND MAJOR PARTS FOR CONTROL GEAR**

Description	Page No.
Alternator ... ..	R24
Box, Electric Pneumatic Relay ... ..	R20, R24
Box, Engine Relay ... ..	R20
Box, Engine Speed Control ... ..	R20
Box, Local Control... ..	R20
Cleaner, Air... ..	R22
Cock, Coupling ... ..	R23
Controller, Automatic Gear ... ..	R24
Controller, Gearbox ... ..	R5-R7
Controller, Throttle ... ..	R2-R4
Controller, Throttle, Sanding ... ..	R24
Ejector, Sand ... ..	R24
Filter, Air ... ..	R23
Gauge, Air Pressure ... ..	R8, R11
Gauge, Vacuum ... ..	R8
Indicator, Engine Speed ... ..	R8, R11
Motor, Throttle ... ..	R17, R18, etc.
Panel, Engine Control ... ..	R8, R9, etc.
Panel, Instrument ... ..	R11
Panel, 12 and 18-Way Relay Operated Switch ... ..	R20
Reservoir, Air ... ..	R22
Reservoir, Auxiliary Air ... ..	R23
Switch, Air Pressure ... ..	R23
Switch, Battery Isolating ... ..	R20
Switch, Change Over ... ..	R8
Switch, Combined Starter, Control and Fire Alarm ... ..	R20
Switch, Engine Isolating ... ..	R20
Switch, Float ... ..	R20
Switch, Single Pole On-Off ... ..	R10
Unit, Control ... ..	R24
Valve, Duplex Check ... ..	R24
Valve, Electric Pneumatic ... ..	R12, R13, etc.
Valve, Non-Return... ..	R22
Valve, Reducing ... ..	R23
Valve, Safety ... ..	R22

railcar.co.uk

**NUMERICAL INDEX TO PART NUMBERS**

Manufacturer's Basic Part No.	B.R. Catalogue No.	Page	Manufacturer's Basic Part No.	B.R. Catalogue No.	Page
A74103	9/15/65123	R12, R13, etc.	V7553	9/15/65442	R15
D40622	9/15/65478	R17, R19	V7554	9/15/65456	R16
GA0903	9/15/65215	R22	V7555	9/15/65445	R15
GA0904	9/15/65216	R22	V7556	9/15/65550	R16
GA0906	9/15/65530	R22	V1/5117	9/15/65384	R8
G27225	9/15/65479	R17, R19	V1/5149	9/15/65410	R11
R3107	9/15/65458	R17	V1/5150	9/15/65385	R8
R3109	9/15/65459	R17	V1/5152	9/15/65398	R9
R3110	9/15/65460	R17	V1/5155	9/15/65408	R11
R3114	9/15/65505	R19	V1/5156	9/15/65406	R11
R3203	9/15/65461	R17	V1/5160	9/15/65386	R8
R3204	9/15/65468	R17, R19	V1/5196	9/15/65411	R11
R3205	9/15/65469	R17, R19	V1/5197	9/15/65399	R9
R3206	9/15/65466	R17	V16424	9/15/65387	R8
R3208	9/15/65467	R17, R19	V16432	9/15/65412	R11
R3210	9/15/65506	R19	V16433	9/15/65400	R9
R6414	9/15/65501	R18	V16434		R11
R7714	9/15/65244	R2	V38007	9/15/65130	R12, R14
R7715	9/15/65331	R5	V38036	9/15/65138	R14
R7718	9/15/65332	R5	V38043	9/15/65114	R12, R13, etc.
R13548	9/15/65499	R18	V38044	9/15/65121	R12, R13, etc.
R13449	9/15/65502	R18	V38046	9/15/65137	R13, R14
R13550	9/15/65500	R18	V38051	9/15/65125	R14
R13551	9/15/65505	R18	V38052	9/15/65118	R12, R13, etc.
R1/10400	9/15/65484	R17, R19	V38066	9/15/65425	R12, R13
R1/32425		R17, R19	V38079	9/15/63785	R21
R1/32427	9/15/65491	R18, R19	V38080	9/15/63786	R21
R1/32428	9/15/65492	R19	V38084		R12, R13, etc.
R1/32430	9/15/65482	R17, R19	V38089	9/15/65434	R12, R13
R1/32438	9/15/65470	R17, R19	V38092	9/15/65528	R21
R3/11224	9/15/65493	R18	V38093	9/15/65529	R21
R3/11225	9/15/65490	R19	V1/14531	9/15/65409	R11
R3/11232	9/15/65487	R18	V1/38001	9/15/65429	R12, R13
S2/13399	9/15/65472	R17, R19	V1/38002		R12, R13
U182505	9/15/65405	R10	V1/38003	9/15/65438	R13
U182506	9/15/65404	R10	V1/38004	9/15/65430	R12, R13
U182507	9/15/65440	R14	V1/38005	9/15/65426	R12, R13
U182509	9/15/65535	R22	V1/38007	9/15/65523	R21
U182532	9/15/65515	R20	V1/38008	9/15/65524	R21
U182533	9/15/65381	R8	V1/38014	9/15/65446	R15, R16
U184944	9/15/65441	R14	V1/38015	9/15/65447	R15, R16
U184945	9/15/65439	R14	V1/38016	9/15/65451	R15
U184958	9/15/65540	R24	V1/38017	9/15/65457	R16
U184959	9/15/65541	R24	V1/38018	9/15/65454	R15, R16
U187420	9/15/65542	R24	V1/38019	9/15/65444	R15, R16
U187464	9/15/65543	R24	V1/38022	9/15/65452	R15, R16
U189585	9/15/65422	R12	V1/38023		R15, R16
U189587	9/15/65539	R24	V1/38024	9/15/65449	R15, R16
U189624	9/15/65407	R11	V1/38025	9/15/65450	R15, R16
U192378	9/15/65538	R24	Z44115	9/15/65526	R21
U192379	9/15/65537	R24	Z44245	9/15/65483	R17, R19
U192380		R24	Z48801	9/15/65124	R12, R13, etc.
U192381		R24	Z51738	9/15/65119	R12, R13, etc.
U192382		R24	Z51739	9/15/65120	R12, R13, etc.
U192383	9/15/65415	R12	Z51740	9/15/65131	R14
V7522	9/15/65417	R12, R13, etc.	Z51741	9/15/65132	R12, R13, etc.
V7523	9/15/65416	R12	Z51779	9/15/65222	R22
V7529	9/15/65527	R21	Z51786	9/15/65431	R12, R13
V7531	9/15/65521	R21	Z51787	9/15/65427	R12, R13
V7533	9/15/65413	R12	Z1/44569	9/15/65126	R12, R13
V7534	9/15/65435	R13	Z1/45206	9/15/65503	R18
V7535	9/15/65418	R12, R13	Z2/10100	9/15/65489	R18, R19
V7536	9/15/65414	R12	Z2/32014	9/15/65224	R22
V7537	9/15/65436	R13	Z2/32045		R15, R16
V7549	9/15/65520	R21	Z2/32056		R15, R16
V7552	9/15/65443	R15, R16			

## NUMERICAL INDEX TO PART NUMBERS

Manufacturer's Basic Part No.	B.R. Catalogue No.	Page	Manufacturer's Basic Part No.	B.R. Catalogue No.	Page
Z2/32057		R15, R16	121-104	9/15/56758	R17
Z2/44025	9/15/65464	R17, R18	121-123		R18
Z3/10201	9/15/65128	R12, R13, etc.	121-124		R18
Z4/10215	9/15/65471	R17, R18	124-154	9/15/65465	R17, R19
Z4/30691		R15, R16	124-155	9/15/64230	R19
Z4/30696		R12, R13, etc.	124-156	9/15/65507	R19
Z4/43706	9/15/65497	R18, R19	124-158	9/15/65127	R12, R13, etc.
Z4/43707	9/15/65498	R18, R19	124-162	9/15/65448	R15, R16
Z4/46517	9/15/65494	R18, R19	132-56	9/15/65223	R22
Z4/46518	9/15/65495	R18, R19	134-2		R4, R7
Z4/46519	9/15/65496	R18, R19	134-3		R18, R19
Z4/46549	9/15/65480	R17, R19	135-2		R18, R19
Z5/30602		R15, R16	135-32		R4, R5, etc.
Z5/31374	9/15/65504	R18	135-33		R3, R5, etc.
Z6/30697	9/15/65481	R17, R19	135-34		R4, R12, etc.
Z8/30566	9/15/65423	R12, R13, etc.	135-61		R15, R16
Z8/30567	9/15/65477	R17, R19	135-102		R9, R21
Z8/30568	9/15/65463	R17, R19	138-133	9/15/65475	R17, R19
Z8/30590	9/15/65462	R17	138-142	9/15/65212	R22
Z8/44884	9/15/65486	R17, R19	138-214	9/15/65225	R22
Z8/44885	9/15/40192	R18, R19	138-224	9/15/65473	R17, R19
Z8/44889	9/15/65485	R17, R19	138-227	9/15/65474	R17, R19
Z11/30783	9/15/35459	R13, R14	142-20		R3
Z12/30710		R11	143-18		R15, R16
Z12/30721		R11	143-19		R3, R6
Z12/30760	9/15/65134	R12, R13, etc.	145-36		R21
Z12/30763	9/15/65133	R14	145-78		R21
Z12/30769	9/15/46527	R18	145-80		R21
Z12/30770	9/15/65433	R12, R13	146-12	9/15/63790	R8, R9, etc.
Z12/30712	9/15/65104	R11	146-38		R9
Z13/30712		R15, R16	147-31		R10, R11
Z16/30798		R15, R16	149-7		R9
Z21/30728		R3, R5	149-14		R11, R17
13-8	9/11/640	R7	149-16		R21
13-10	9/11/656	R22	149-17		R10, R11
28-32	9/15/65532	R15, R16	153-11		R3, R6
39-21	9/15/65453	R3, R5	153-13		R3, R7
40-3		R18	153-17		R11
40-36	9/15/65488	R18	153-19		R3, R5, etc.
41-62	9/15/65178	R18	153-22		R10, R11
41-65	9/15/94087	R17, R19	157-3		R17, R19
81-1302	9/15/65476	R17, R19	219-24		R22
81-1994	9/15/65156	R7	331-48	9/15/65136	R12, R13, etc.
85-2		R3, R5	331-49	9/15/65135	R12, R13, etc.
85-3		R11, R17, etc.	339-1327	9/15/63794	R9, R11
85-32		R17, R18, etc.	339-1332	9/15/65401	R9, R10, etc.
85-33		R12, R13, etc.	339-1375	9/15/65107	R8
85-34		R4, R7	339-1454	9/15/65402	R9, R10, etc.
90-1		R3, R4, etc.	341-1647	9/15/65393	R9
90-2		R4, R7	341-1648	9/15/65394	R9
90-5		R4, R5, etc.	341-1649	9/15/65395	R9
90-33		R12, R13, etc.	341-1650	9/15/65396	R9
90-34		R17, R19	341-1651	9/15/65392	R9
90-153		R5	341-1653	9/15/65388	R9
91-3		R3, R7	341-1656	9/15/65419	R12, R15
99-3		R2, R5, etc.	341-1657	9/15/65420	R12, R13, etc.
99-8		R14	341-1658	9/15/65437	R13, R16
108-63		R12, R13, etc.	341-1659	9/15/65421	R12, R15
109-422		R12, R13, etc.	341-1682	9/15/65389	R9
112-72	9/15/65115	R3, R7	341-1685	9/15/65390	R9
112-101	9/15/94369	R12, R13, etc.	341-1704	9/15/65391	R9
114-188	9/15/65424	R12, R13, etc.	373-453	9/15/65380	R8, R11
117-83		R2, R4, etc.	415-102	9/15/63797	R20
121-7		R4, R5, etc.	416-364	9/15/63795	R10, R11
121-8		R2, R3, etc.			
121-87					

**NUMERICAL INDEX TO PART NUMBERS**

Manufacturer's Basic Part No.	B.R. Catalogue No.	Page	Manufacturer's Basic Part No.	B.R. Catalogue No.	Page
416-371	9/15/65108	R8, R9, etc.	5127-9	9/15/65268	R2
416-394	9/15/65403	R9, R10, etc.	5127-10	9/15/65350	R5
426-74		R15, R16	5127-11	9/15/65351	R5
499-3692	9/15/65525	R21	5127-12	9/15/65352	R5
501-225	9/15/65221	R22	5127-13	9/15/65359	R6
546-1170	9/15/63784	R20	5127-14	9/15/65360	R6
546-1198	9/15/63777	R8, R20, etc.	5127-15	9/15/65361	R6
546-1390	9/15/63792	R8, R11	5127-16	9/15/65362	R6
546-1391	9/15/63793	R10, R11	5127-17	9/15/65334	R5
546-1393	9/15/63788	R8, R9, etc.	5127-18	9/15/65336	R5
546-1394	9/15/63789	R8, R9, etc.	5127-19	9/15/65299	R3
546-1414	9/15/65518	R20	5127-20	9/15/65250	R2
546-1426	9/15/65519	R20	5127-21	9/15/65341	R5, R6
546-1431	9/15/65522	R21	5127-22	9/15/65365	R6
546-1440	9/15/65397	R9	5127-23	9/15/65370	R7
546-1716	9/15/65514	R20	5127-24	9/15/65245	R2
546-1717	9/15/65511	R20	5127-25	9/15/65255	R2
5001-29	9/15/65231	R23	5127-26	9/15/65256	R2
5001-140	9/15/65209	R22	5127-27	9/15/65246	R2
5001-143	9/15/65211	R22	5127-28	9/15/65353	R5
5001-144	9/15/65214	R22	5127-29	9/15/65312	R4
5004-10	9/15/65230	R23	5127-30	9/15/65318	R4
5004-11	9/15/65207	R22	5127-31	9/15/65339	R5
5006-92	9/15/65228	R23	5127-32	9/15/65344	R5
5006-93	9/15/65226	R22	5127-34	9/15/65307	R3
5006-308	9/15/65207	R22	5127-35	9/15/65327	R4
5006-326	9/15/65227	R22	5127-36	9/15/65253	R5
5006-327	9/15/65229	R23	5127-37	9/15/65279	R3
5006-425	9/15/65533	R22	5127-39	9/15/65354	R5
5006-428	9/15/65534	R22	5127-41	9/15/65374	R7
5006-429	9/15/65536	R23	5127-42	9/15/65342	R5
5006-442	9/15/65218	R22	5127-43		R4
5006-443	9/15/65219	R22	5127-44		R4
5006-449	9/15/65531	R22	5127-45	9/15/65247	R2
5006-495	9/15/65210	R22	5127-46	9/15/65258	R2, R5, etc.
5006-504	9/15/65208	R22	5127-47	9/15/65270	R2, R6
5006-505	9/15/65213	R22	5127-48	9/15/65251	R2, R4, etc.
5021-81		R22	5127-49	9/15/65272	R2
5021-82		R22	5127-50	9/15/65345	R5
5021-83		R22	5127-51	9/15/65294	R3, R7
5021-84		R22	5127-53	9/15/65310	R3, R6
5021-85		R22	5127-54	9/15/65252	R2, R5
5021-87		R22	5127-55	9/15/65316	R4
5021-333		R22	5127-56	9/15/65314	R4
5021-583		R22	5127-57	9/15/65277	R2
5023-17		R23	5127-58	9/15/65371	R7
5023-19		R23	5127-59	9/15/65264	R2, R6
5023-24		R23	5127-60	9/15/65269	R2
5038-33	9/15/65383	R8	5127-61	9/15/65322	R4
5041-2	9/15/65382	R8, R11	5127-62	9/15/65358	R6
5042-1	9/15/65232	R23	5127-63	9/15/65276	R2, R6
5049-12	9/15/65516	R20	5127-64	9/15/65248	R2, R5, etc.
5049-27	9/15/65517	R20	5127-65	9/15/65254	R2, R5
5110-1	9/15/65205	R20	5127-66	9/15/65296	R3, R7
5111-3	9/15/65508	R20	5127-67	9/15/65320	R4
5111-4	9/15/65512	R20	5127-68	9/15/65260	R2
5111-12	9/15/65509	R20	5127-69	9/15/65301	R3, R5
5111-13	9/15/65510	R20	5127-70	9/15/65274	R2, R6
5111-14	9/15/65513	R20	5127-71	9/15/65295	R3, R7
5127-1	9/15/65315	R4	5127-72	9/15/65367	R6
5127-2	9/15/65302	R3, R5	5127-73	9/15/65326	R4
5127-5	9/15/65259	R2	5127-75	9/15/65319	R4, R5
5127-6	9/15/65265	R2	5127-76	9/15/65368	R6
5127-7	9/15/65266	R2	5127-77	9/15/65373	R7
5127-8	9/15/65267	R2	5127-78	9/15/65323	R4, R5

## NUMERICAL INDEX TO PART NUMBERS

Manufacturer's Basic Part No.	B.R. Catalogue No.	Page	Manufacturer's Basic Part No.	B.R. Catalogue No.	Page
5127-79	9/15/65329	R4, R7	5127-146	9/15/65261	R2
5127-80	9/15/65297	R3, R7	5128-2	9/15/65289	R3, R7
5127-81		R4	5128-3	9/15/65291	R3, R7
5127-82	9/15/65356	R5	5128-4	9/15/65308	R3, R6
5127-83	9/15/62575	R2, R6	5128-5	9/15/65305	R3, R7
5127-84	9/15/65330	R4, R7	5128-6	9/15/65290	R3, R7
5127-85	9/15/65375	R7	5128-7	9/15/65282	R3, R7
5127-86	9/15/65346	R5	5128-8	9/15/65253	R3, R7
5127-87	9/15/65273	R2, R6	5128-9	9/15/65285	R3, R7
5127-88	9/15/65355	R5	5128-10	9/15/65283	R3, R7
5127-89	9/15/65262	R2	5128-11	9/15/65280	R3, R7
5127-90	9/15/65313	R4	5128-12	9/15/65284	R3, R7
5127-92		R6	5128-13	9/15/65281	R3, R7
5127-93		R4, R6	9/15/65309	9/15/65309	R3
5127-94		R4, R6	5128-17	9/15/65286	R3, R7
5127-95		R4	5128-18	9/15/65287	R3, R7
5127-96		R4	5128-19	9/15/65288	R3, R7
5127-97		R4	5128-20	9/15/65292	R3, R7
5127-98		R4	5128-21	9/15/65366	R3, R6
5127-99		R4	5156-1	9/15/65379	R7
5127-100		R6			
5127-101		R6			
5127-102		R6			
5127-103		R6			
5127-104		R6			
5127-105		R6			
5127-106		R6			
5127-107		R4, R6			
5127-108		R4, R6			
5127-109		R3, R4, etc.			
5127-110		R3, R5			
5127-111	9/15/65324	R4, R6			
5127-112	9/15/65340	R5			
5127-113	9/15/65349	R5, R6			
5127-114	9/15/65321	R4			
5127-115	9/15/65311	R4			
5127-116	9/15/65257	R2, R5			
5127-117	9/15/65546	R5			
5127-118	9/15/65376	R7			
5127-119	9/15/65377	R7			
5127-120	9/15/65378	R7			
5127-121	9/15/65545	R6			
5127-122	9/15/65249	R2			
5127-123	9/15/65263	R2			
5127-124	9/15/65271	R2			
5127-125	9/15/65278	R3			
5127-126	9/15/65293	R3, R7			
5127-127	9/15/65298	R3			
5127-128	9/15/65308	R3			
5127-129	9/15/65317	R4			
5127-130	9/15/65325	R4			
5127-131	9/15/65333	R5			
5127-132	9/15/65335	R5			
5127-133	9/15/65338	R5			
5127-134	9/15/65343	R5			
5127-135	9/15/65347	R5			
5127-136	9/15/65348	R5			
5127-137	9/15/65357	R6			
5127-138	9/15/65363	R6			
5127-139	9/15/65364	R6			
5127-140	9/15/65369	R7			
5127-141	9/15/65372	R7			
5127-142	9/15/65300	R3, R5			
5127-143	9/15/65304	R3, R5			
5127-144		R3, R5			
5127-145	9/15/65303	R3, R5			

CONTROL GEAR TYPE		
B.R. Cat. No.	A.E.C. Basic Part No.	Description
	R223 Series	<p><b>CONTROL GEAR COMPLETE</b> Used on DTO1/13, 1/15, 1/12, 1/14, 1/16, 1/17, 1/18, 1/22, 1/21, 1/23, 1/24, 1/25, 1/26, 1/27, 1/28, 1/31, 1/33, 1/32, 1/30, 1/34, 1/35, 1/38, 1/40, 1/39, 1/42, 1/41, 1/41A, 1/43, 1/44, 1/45, 1/48, 1/49, 1/50, 1/51, 1/52, 1/53, 1/54, 1/55, 1/56, 1/57</p>

railcar.co.uk

B.R. Cat. No.	A.E.C. Basic Part No.	Plate Ref.	Designation	Used on	No. Req. per Control Gear	Remarks
		<b>R2</b>	<b>CONTROL GEAR</b>			Sharps Part Nos. except * G.E.C. † Santon (Power and Trailer Cars)
					(See Note below)	
9/15/65244	R7714		<b>THROTTLE CONTROLLER COMPLETE ...</b>	Not DTOI/35, I/42	1	220A18 Sharps
9/15/65245	5127-24	1	Ring, Interlock ... ..	"	1	ID54
9/15/65246	5127-27	2	<b>Spring, Torsion ... ..</b>	"	1	48D19
9/15/65247	5127-45	3	<b>Bush, <math>\frac{1}{8}</math>" Dia. x 1" Long ... ..</b>	"	1	31E31
	121-87	4	Screw, $\frac{1}{4}$ " Whit. x 1" ... ..	"	3	
9/15/65248	5127-64	5	Plate, Locking ... ..	"	4	52E16
9/15/65249	5127-122		<b>TOP PLATE COMPLETE ... ..</b>	"	1	Sub-Assy. No. 1
9/15/65250	5127-20	6	Plate, Top ... ..	"	1	93C25
9/15/65251	5127-48		Bracket, Spring Support ... ..	"	1	11E58
9/15/65252	5127-54		Bracket, Contact Panel ... ..	"	1	11E56B
	121-87		Screw, $\frac{1}{4}$ " Whit. x 1" ... ..	"	6	
9/15/65248	5127-64		Plate, Locking ... ..	"	5	52E16
9/15/65254	5127-65		Plate, Locking ... ..	"	1	52E16A
9/15/65255	5127-25	7	<b>Bearing, Top ... ..</b>	"	1	5D19
	121-7	8	Screw, $\frac{1}{4}$ " Whit. x $\frac{3}{4}$ " ... ..	"	2	
9/15/65256	5127-26	9	Shaft, Top ... ..	"	1	2D17
9/15/65257	5127-116	10	<b>Bush, Oilite CT51 ... ..</b>	"	1	307/54
9/15/65258	5127-46	12	Washer, Cams ... ..	"	3	68E4
	99-8	13	Circlip, Seeger, $\frac{1}{8}$ " Dia. ... ..	"	2	
9/15/65259	5127-5	14	Cam (TG and DM) ... ..	"	3	50D53A
9/15/65260	5127-68		Block, Stop ... ..	"	1	1E10
9/15/65261	5127-146		Screw, Stop Block ... ..	"	1	300/745A
9/15/65262	5127-89	15	Spacer, Cams ... ..	"	2	P297D43
9/15/65263	5127-123		<b>BOTTOM SHAFT COMPLETE ... ..</b>	"	1	Sub-Assy. No. 10
9/15/65264	5127-59	16	Shaft, Bottom ... ..	"	1	2E9
	99-8	17	Circlip, Seeger, $\frac{1}{16}$ " Dia. ... ..	"	1	
9/15/65258	5127-46	18	Washer, Cams ... ..	"	1	68E4
9/15/65265	5127-6	19	Cam, T1 ... ..	"	1	50D53B
9/15/65266	5127-7	20	Cam, T2 ... ..	"	1	50D53C
9/15/65267	5127-8	21	Cam, T3 ... ..	"	1	50D53D
9/15/65268	5127-9	22	Cam, T4 ... ..	"	1	50D53E
9/15/65262	5127-89	23	Spacer, Cams ... ..	"	4	P297D43
9/15/65269	5127-60	24	Shaft, Operating ... ..	"	1	2E10
9/15/65270	5127-47	25	Washer, Shaft ... ..	"	1	68E5
9/15/65271	5127-124		<b>STARWHEEL COMPLETE ... ..</b>	"	1	Sub-Assy. No. 4
9/15/65272	5127-49	26	Starwheel ... ..	"	1	49E5
9/15/65273	5127-87	27	Clamp ... ..	"	1	P297E35
9/15/65274	5127-70	28	Pin, Stop ... ..	"	1	27E49B
9/15/65275	5127-83	29	Screw, Clamp, $\frac{7}{16}$ " A/F. x $1\frac{1}{2}$ " Special ... ..	"	2	61E5/2
9/15/65248	5127-64	30	Plate, Locking ... ..	"	2	52E16
9/15/65276	5127-63	31	Pin, Driving ... ..	"	1	91E43
9/15/65277	5127-57		Bar, Tie ... ..	"	4	17E16A

**NOTE:**—Quantities are doubled from pages R.2 to R.7 on 20 Power Cars of DTOI/25 and all Power Cars of DTOI/57 (Double-Ended Controls)



B.R. Cat. No.	A.E.C. Basic Part No.	Plate Ref.	Designation	Used on	No. Req. per Control Gear	Remarks
		R2	<b>CONTROL GEAR—Continued</b> <b>THROTTLE CONTROLLER—Continued</b>	Not DTO1/35, 1/42	(See Note on page R.2)	Sharps Part Nos. except * G.E.C. † Santon  (Power and Trailer Cars)
9/15/65278	5127-125		<b>CONTACTOR COMPLETE</b> ... ..	"	1	Sub. Assy. No. 11
9/15/65279	5127-37		Shaft, Contactor ... ..	"	1	2D15
9/15/65280	5128-11		<b>MOVING ARM COMPLETE WITH MOVING CONTACT, G.E.C.</b> ... ..	"	7	5C3068-14 *
9/15/65281	5128-13		<b>MOVING ARM COMPLETE</b> ... ..	"	7	5C3068-23 *
9/15/65282	5128-7	32	Arm ... ..	"	7	S5D5072A *
9/15/65283	5128-10	33	Plate, Retaining ... ..	"	14	S5E3568A *
9/15/65284	5128-12	34	<b>ROLLER COMPLETE</b> ... ..	"	7	5E3567B *
9/15/65285	5128-9		Roller ... ..	"	7	S5E3567A *
9/15/65286	5128-17		<b>Bush</b> ... ..	"	7	S2D9359E *
9/15/65287	5128-18	35	Rivet, Retaining Plates ... ..	"	21	S2D45799V *
9/15/65288	5128-19		Tube, Roller ... ..	"	7	S2D57047T *
9/15/65289	5128-2	36	<b>Contact, Moving</b> ... ..	"	7	S5D3649A *
9/15/65290	5128-6	37	Holder ... ..	"	7	S5E2680A *
9/15/65291	5128-3	38	<b>Spring</b> } Moving Contact ... ..	"	7	S5E2691A *
9/15/65292	5128-8	39	Plate, Tapping ... ..	"	7	
9/15/65292	5128-20	40	Screw, Contact Arm ... ..	"	14	5C3068-12 *
	153-13		Washer, Thackray, No. 4 B.A. ... ..	"	14	
	99-3	41	Circlip, Seeger, $\frac{5}{8}$ " Dia. ... ..	"	10	
9/15/65293	5127-126		<b>SPRING ARM COMPLETE</b> ... ..	"	1	Sub. Assy. No. 3
9/15/65294	5127-51	42	Arm, Spring ... ..	"	1	4E43
9/15/65295	5127-71		Roller ... ..	"	1	31E27
9/15/65296	5127-66		Pin, Spring ... ..	"	1	91E42
9/15/65297	5127-80	43	Spindle ... ..	"	2	31E25
9/15/94369	112-101	44	Rivet, Steel, Csk., $\frac{3}{8}$ " x $\frac{1-3}{8}$ " ... ..	"	2	
9/15/65298	5127-127		<b>BOTTOM PLATE COMPLETE</b> ... ..	"	1	Sub. Assy. No. 2
9/15/65299	5127-19	45	Plate, Bottom ... ..	"	1	93C27
9/15/65300	5127-142		Clamp, Cable, Top ... ..	"	1	19E15
	40-3		Screw, $\frac{5}{16}$ " Whit. x $1\frac{1}{8}$ " ... ..	"	1	
	85-3		Nut, Plain, $\frac{5}{16}$ " Whit. } Top Clamp ... ..	"	1	
	135-33		Washer, Grover, $\frac{5}{16}$ " ... ..	"	1	
9/15/65301	5127-69	46	Pin, Stop ... ..	"	2	27E49A
	5127-110	47	Nut, Half, $\frac{5}{16}$ " Whit. "Simmonds" ... ..	"	2	300/124B
9/15/65304	5127-143		Clamp, Cable, Bottom ... ..	"	1	19E16
	5127-144		Screw, No. 2 B.A. (Slotted Hex. Hd.) ... ..	"	2	300/720A
	153-19		Washer, Grover, No. 2 B.A. ... ..	"	2	
9/15/65302	5127-2		Nameplate ... ..	"	1	81E40
9/15/65303	5127-145		Screw, Drive ... ..	"	2	300/857
	90-2		Locknut, $\frac{5}{16}$ " Whit., "Simmonds" ... ..	"	4	Bottom Plate
9/11/640	13-8	48	<b>Ball, Steel, <math>\frac{3}{8}</math>" Dia. (Shaft)</b> ... ..	"	1	
9/15/65305	5128-5	49	<b>Spring, Contactor, G.E.C.</b> ... ..	"	7	S5E4258A *
9/15/65306	5127-128		<b>CONTACT BLOCK PANEL COMPLETE</b> ... ..	"	1	Sub. Assy. No. 8
9/15/65307	5127-34	50	Panel ... ..	"	1	11D16
9/15/65308	5128-4		<b>FIXED CONTACT BLOCK WITH TERMINAL SCREWS, G.E.C.</b> ... ..	"	7	5C3068-24 *
9/15/65309	5128-14	51	<b>FIXED CONTACT BLOCK COMPLETE</b> ... ..	"	7	5E2700A *
	5128-21	52	Screw, 2 B.A. Hx. Hd. x $\frac{1}{2}$ " ... ..	"	14	5C3068-18 *
	153-11		Washer, Thackray, No. 2 B.A. ... ..	"	14	
	143-19		Screw, Ch. Hd., No. 2 B.A. x $\frac{5}{8}$ " ... ..	"	7	} Block to Angle Piece
	153-11	53	Washer, Thackray, No. 2 B.A. ... ..	"	7	
	5127-111		Locknut, Half, 2 B.A. "Simmonds" ... ..	"	7	300/126A
	121-87	54	Screw, $\frac{1}{4}$ " Whit. x $\frac{5}{8}$ " ... ..	"	2	Contact Block
	5127-109	55	Locknut, Half, $\frac{1}{2}$ " Whit. "Simmonds" ... ..	"	2	300/123A
9/15/65310	5127-53	56	Bracket, Contact Block ... ..	"	1	11E56A

B.R. Cat. No.	A.E.C. Basic Part No.	Plate Ref.	Designation	Used on	No. Req. per Control Gear	Remarks
		<b>R2</b>	<b>CONTROL GEAR—Continued</b>			Sharps Part Nos. except * G.E.C. † Santon
			<b>THROTTLE CONTROLLER—Continued</b>	Not DTOI/35, 1/42	(See Note on page R.2)	(Power and Trailer Cars)
			<b>CONTACT BLOCK PANEL—Continued</b>			
	5127-107		Tag, Terminal, T5 ... ..	"	1	81E15R
	5127-93		Tag, Terminal, G+ ... ..	"	1	81E15B
	5127-94		Tag, Terminal, DM ... ..	"	1	81E15C
	5127-95		Tag, Terminal, DM+ ... ..	"	1	81E15D
	5127-96		Tag, Terminal, T1 ... ..	"	1	81E15E
	5127-97		Tag, Terminal, T2 ... ..	"	1	81E15F
	5127-98		Tag, Terminal, T3 ... ..	"	1	81E15G
	5127-99		Tag, Terminal, T4 ... ..	"	1	81E15H
	5127-108		Tag, Terminal, T6 ... ..	"	1	81E15S
	5127-81		Insulation ... ..	"	1	67E12
	5127-43		Connection, Long ... ..	"	1	80D52
	5127-44		Connection, Short ... ..	"	1	80D53
	142-20		Screw, Brass, Ch. Hd., No. 2 B.A. x 1/2" ...	"	1	
9/15/65311	5127-115	57	Bush ... ..	"	1	307/53
9/15/65312	5127-29	58	Block, Handle ... ..	"	1	1D53
9/15/65313	5127-90	59	Bracket, Locking ... ..	"	1	11D15
	121-7	60	Screw, 1/4" Whit. x 3/4" ... ..	"	1	
	90-1	61	Locknut, 1/4" Whit. ... ..	"	1	
9/15/65314	5127-56	62	Pin, Spring ... ..	"	1	91E50
9/15/65315	5127-1	63	Spring ... ..	"	1	48/21
	90-33		Locknut, 3/8" B.S.F. ... ..	"	2	
9/15/65316	5127-55	64	Bush, Spring Pin ... ..	"	1	31E29
9/15/65317	5127-129		<b>HANDLE COMPLETE</b> ... ..	"	1	Sub. Assy. No. 5
9/15/65318	5127-30	65	Handle ... ..	"	1	55D16A
9/15/65319	5127-75	66	Knob ... ..	"	1	55E7
	90-2	67	Locknut, 5/16" Whit. ... ..	"	1	
9/15/65320	5127-67	68	Tongue, Driving ... ..	"	1	4E25
9/15/65321	5127-114	69	Screw, Special, 1/4" Whit. Hx. Hd. 5/8" Long ...	"	1	307/52
9/15/65322	5127-61	70	Stop Screw, Special ... ..	"	1	27E46
	135-34		Washer, Grover, 3/8" ... ..	"	1	
	135-32		Washer, Grover, 1/4" ... ..	"	1	
9/15/65323	5127-78	71	Pin, Pivot ... ..	"	1	91E41
9/15/65324	5127-111	72	Domnut ... ..	"	1	300/130
9/15/65325	5127-130		<b>SPRING SUPPORT ANGLE COMPLETE</b> ... ..	"	1	Sub. Assy. No. 12
9/15/65326	5127-73	73	Angle ... ..	"	1	11E61
	121-7		Screw, 1/4" Whit. x 3/4" ... ..	"	2	
	5127-109		Locknut, Half, "Simmonds" 1/4" Whit. ... ..	"	2	300/123A
9/15/65327	5127-35	74	Plate, Spring Support ... ..	"	1	11E19
9/15/65251	5127-48		Bracket ... ..	"	1	11E58
	134-2	75	Washer, Plain, 1/4", Steel, Bright ... ..	"	1	
9/15/65329	5127-79	76	Spring, Spring Arm Spindle ... ..	"	1	48E46
	121-8		Screw, 1/4" Whit. x 1" ... ..	"	6	
	90-1		Locknut, 1/4" Whit. ... ..	"	6	
9/15/65330	5127-84	77	Screw, Thrust, Shaft Ball ... ..	"	1	61E11
	90-5	78	Locknut, 1/2" Whit. ... ..	"	1	
	5127-109		Locknut, Half, "Simmonds" 1/4" Whit. ... ..	"	2	300/123A

} Bottom Plate

B.R. Cat. No.	A.E.C. Basic Part No.	Plate Ref.	Designation	Used on	No. Req. per Control Gear	Remarks
		<b>R3</b>	<b>CONTROL GEAR—Continued</b>			Sharps Part Nos. except * G.E.C. † Santon (Power and Trailer Cars)
					(See Note on Page R.2)	
9/15/65331	R7715		<b>GEAR BOX CONTROLLER COMPLETE ...</b>	Not DTO1/35, 1/42, 1/55, 1/57	1	
9/15/65332	R7718		<b>GEAR BOX CONTROLLER COMPLETE ...</b>	DTO1/55, 1/57	1	
9/15/65333	5127-131		<b>TOP PLATE COMPLETE ...</b>	R7715, R7718	1	Sub. Assy. No. 1
9/15/65334	5127-17		Plate, Top ...	"	1	93B26
9/15/65251	5127-48		Bracket, Spring Support ...	"	1	11E58
9/15/65252	5127-54		Bracket, Contact Panel ...	"	1	11E56B
	121-87		Screw, 1/4" Whit. x 5/8" ...	"	6	
9/15/65248	5127-64		Plate, Locking ...	"	3	52E16
9/15/65254	5127-65		Plate, Locking ...	"	3	52E16A
	121-7		Screw, 1/4" Whit. x 3/8" ...	"	2	
9/15/65335	5127-132		<b>BOTTOM PLATE COMPLETE ...</b>	"	1	Sub. Assy. No. 2
9/15/65336	5127-18	1	Plate ...	"	1	93B17
9/15/65300	5127-142		Clamp, Cable, Top ...	"	1	19E15
9/15/65301	5127-69	2	Pin, Stop ...	"	2	27E49A
	5127-110	3	Locknut, Half, "Simmonds" 5/16" Whit. ...	"	2	300/124B
	40-3		Screw, 5/16" Whit. x 1 1/8" ...	"	1	
	85-3		Nut, Plain, 5/16" Whit. ...	"	1	
	135-33		Washer, Grover, 5/16" ...	"	1	
9/15/65304	5127-143		Clamp, Cable, Bottom ...	"	1	19E16
	5127-144		Screw, No. 2 B.A. (Slotted Hex. Hd.) ...	"	2	300/720A
	153-19		Washer, Grover, No. 2 B.A. ...	"	2	
9/15/65302	5127-2		Nameplate ...	"	1	81E40
9/15/65303	5127-145		Screw, Drive ...	"	2	300/857
9/11/640	13-8	4	<b>Ball, Steel, 3/8" Dia. (Shaft)</b>	"	1	
9/15/65338	5127-133		<b>HANDLE COMPLETE ...</b>	"	1	Sub. Assy. No. 6
9/15/65339	5127-31	5	Handle ...	"	1	55D16B
9/15/65319	5127-75	6	Knob ...	"	1	55E7
	91-3	7	Locknut, 5/16" Whit. ...	"	1	
	121-8		Screw, 1/4" Whit. x 1" ...	"	1	
	135-32	8	Washer, Grover, 1/2" ...	"	1	
9/15/65323	5127-78	9	Pin, Pivot ...	"	1	91E41
9/15/65340	5127-112	10	Domenuit ...	"	1	300/130
9/15/65341	5127-21	11	Block, Handle ...	"	1	1C52
9/15/65342	5127-42	12	Bracket, Locking ...	"	1	52D15
	90-33	13	Locknut, 3/8" B.S.F. ...	"	2	
9/15/65343	5127-134		<b>DIRECTION OPERATING BOSS COMPLETE ...</b>	"	1	Sub. Assy. No. 8
9/15/65344	5127-32	14	Boss ...	"	1	1D46
9/15/65345	5127-50	15	Bush ...	"	1	31E30
9/15/65346	5127-86	16	Handle, Direction ...	"	1	P297D116
9/15/65347	5127-135		<b>TOP SHAFT COMPLETE ...</b>	R7715	1	
9/15/65348	5127-136		<b>TOP SHAFT COMPLETE ...</b>	R7718	1	Sub. Assy. No. 9
9/15/65253	5127-36	17	Shaft, Top ...	R7715, R7718	1	2D14
9/15/65257	5127-116		Bush, Top Shaft ...	"	1	307/54
9/15/65349	5127-113	18	Spacer, Cams ...	"	6	P297D43
9/15/65350	5127-10	19	Cam (Remainder of Top Shaft) ...	"	4	50D53F
9/15/65351	5127-11	20	Cam (2nd) ...	"	1	50D53G
9/15/65352	5127-12	21	Cam (3rd) ...	"	1	50D53H
9/15/65258	5127-46	22	Washer, Cams ...	"	2	68E4
	99-8	23	Circlip, Seeger, 1 5/8" Dia. ...	"	1	Cams
9/15/65353	5127-28	24	Bearing, Top ...	"	1	5D16
9/15/65354	5127-39		Starwheel ...	R7715	1	49D7
9/15/65546	5127-117	25	Starwheel ...	R7718	1	96D8
9/15/65355	5127-88	26	Clamp ...	R7715, R7718	1	P297E33
9/15/65356	5127-82	27	Screw ...	"	2	61E5/1
9/15/65248	5127-64	28	Plate, Locking ...	"	2	52E16
	121-87	29	Screw, 1/4" Whit. x 5/8" ...	"	3	Bearing to Top Plate
9/15/65248	5127-64	30	Plate, Locking ...	"	3	52E16

B.R. Cat. No.	A.E.C. Basic Part No.	Plate Ref.	Designation	Used on	No. Req. per Control Gear	Remarks
		<b>R3</b>	<b>CONTROL GEAR—Continued ... ..</b>			Sharps Part Nos. except * G.E.C. † Santon
			<b>GEAR BOX CONTROLLER—Continued</b>	R7715, R7718	(See Note on page R.2)	(Power and Trailer Cars)
			<b>OPERATING SHAFT COMPLETE</b> ... ..	"	1	Sub Assy. No. 10
9/15/65357	5127-137		Shaft, Operating ... ..	"	1	2E11
9/15/65358	5127-62	31	Shaft, Bottom ... ..	"	1	2E9
9/15/65264	5127-59	32	Washer (Top to Bottom Shaft, Special) ... ..	"	1	68E5
9/15/65270	5127-47	33	Circlip, Seeger, $\frac{13}{16}$ " Dia. ... ..	"	1	
	99-8	34	Washer ... ..	"	1	68E4
9/15/65258	5127-46	35	Spacer ... ..	"	4	P297D43
9/15/65349	5127-113	36	Cam, 7th ... ..	"	1	50D53I
9/15/65359	5127-13	37	Cam, 8th ... ..	"	1	50D53J
9/15/65360	5127-14	38	Cam, 9th ... ..	"	1	50D53K
9/15/65361	5127-15	39	Cam, 10th... ..	"	1	50D53L
9/15/65362	5127-16	40	<b>STARWHEEL COMPLETE</b> ... ..	"	1	Sub Assy. No. 5
9/15/65363	5127-138		Starwheel ... ..	"	1	49D6
9/15/65545	5127-121	41	Clamp ... ..	"	1	P297E35
9/15/65273	5127-87	42	Pin, Stop ... ..	"	1	27E49B
9/15/65274	5127-70	43	Screw, $\frac{7}{16}$ " A/F. $\times 1\frac{3}{4}$ ", Special ... ..	"	2	61E5/2
9/15/65275	5127-83	44	Plate, Locking ... ..	"	2	52E16
9/15/65248	5127-64	45	Pin, Driving ... ..	"	1	91E43
9/15/65276	5127-63	46	<b>CONTACT BLOCK PANEL COMPLETE</b> ... ..	"	1	Sub Assy. No. 11
9/15/65364	5127-139		Panel ... ..	"	1	11C73
9/15/65365	5127-22	47	<b>FIXED CONTACT BLOCK WITH TERMINAL SCREW, G.E.C.</b> ... ..	"	10	5C3068-24 *
9/15/65308	5128-4		<b>FIXED CONTACT BLOCK COMPLETE</b> ... ..	"	10	5E2700A *
9/15/65309	5128-14	48	Screw (Contact Block), 2 B.A., Hx. Hd., $\frac{1}{2}$ " ... ..	"	30	5C3068-18 *
9/15/65366	5128-21	49	Washer, Thackray, No. 2 B.A. ... ..	"	30	
	153-11		Screw, Ch. Hd., No. 2 B.A. $\times \frac{5}{8}$ " ... ..	"	10	
	143-19	50	Washer, Thackray, No. 2 B.A. ... ..	"	10	} Block to Angle Piece
	153-11		Locknut, Half, "Simmonds", 2 B.A. ... ..	"	10	
	5127-111		Screw, $\frac{1}{4}$ " Whit. $\times \frac{5}{8}$ " ... ..	"	2	300/126A
	121-87		Locknut, Half, "Simmonds", $\frac{1}{4}$ " Whit. ... ..	"	2	300/123A
9/15/65367	5127-109		Link (4 Holes) ... ..	"	1	80E43
9/15/65368	5127-72		Link (6 Holes) ... ..	"	1	80E44
9/15/65310	5127-76		Bracket, Contact Block ... ..	"	1	11E56A
	5127-53		Tag, Terminal, M+ ... ..	"	1	81E15A
	5127-92		Tag, Terminal, G+ ... ..	"	1	81E15B
	5127-93		Tag, Terminal, DM ... ..	"	1	81E15C
	5127-94		Tag, Terminal, L+ ... ..	"	1	81E15I
	5127-100		Tag, Terminal, F ... ..	"	1	81E15J
	5127-101		Tag, Terminal, R... ..	"	1	81E15K
	5127-102		Tag, Terminal, T5 ... ..	"	1	81E15R
	5127-107		Tag, Terminal, G1 ... ..	"	1	81E15M
	5127-103		Tag, Terminal, G2 ... ..	"	1	81E15N
	5127-104		Tag, Terminal, G3 ... ..	"	1	81E15O
	5127-105		Tag, Terminal, G4 ... ..	"	1	81E15P
	5127-106		Tag, Terminal, G4 ... ..	"	1	81E15S
	5127-108		Tag, Terminal, T6 ... ..	"	1	

B.R. Cat. No.	A.E.C. Basic Part No.	Plate Ref.	Designation	Used on	No. Req. per Control Gear	Remarks
			<b>R2 CONTROL GEAR—Continued</b>			Sharps Part Nos. except * G.E.C.
			<b>GEAR BOX CONTROLLER—Continued</b>	R7715, R7718	(See Note on page R.2)	† Santon (Power and Trailer Cars)
9 15 65369	5127-140		<b>CONTACTOR COMPLETE</b> ... ..	"	1	Sub Assy. No. 13
9 15 65370	5127-23		Shaft, Contactor ... ..	"	1	2C26
9 15 65280	5128-11		<b>MOVING ARM COMPLETE WITH MOVING CONTACT, G.E.C.</b>	"		
9 15 65281	5128-13		<b>MOVING ARM COMPLETE</b> ... ..	"	10	5C3068-14 *
9 15 65282	5128-7	51	Arm ... ..	"	10	5C3068-23 *
9 15 65283	5128-10	52	Plate, Retaining ... ..	"	10	S5D5072A *
9 15 65284	5128-12	53	<b>ROLLER COMPLETE</b> ... ..	"	30	S5E3568A *
9 15 65285	5128-9		Roller ... ..	"	10	5E3567B *
9 15 65286	5128-17		<b>Bush</b> ... ..	"	10	S5E3567A *
9 15 65287	5128-18	54	Rivet, Retaining Plates ... ..	"	10	S2D9359E *
9 15 65288	5128-19		Tube, Roller... ..	"	30	S2D45799V *
9 15 65289	5128-2	55	<b>Contact, Moving</b> ... ..	"	10	S2D57047T *
9 15 65290	5128-6	56	Holder ... ..	"	10	S5D3649A *
9 15 65291	5128-3	57	<b>Spring</b> ... .. } Moving Contact	"	10	S5E2680A *
9 15 65253	5128-8	58	Plate, Tapping ... ..	"	10	S5E2691A *
9 15 65292	5128-20		Screw, Contact Arm ... ..	"	30	
	153-13	59	Washer, Thackray, No. 4 B.A. ... ..	"	30	5C3068-12 *
	99-3	60	Circlip, Seeger, $\frac{5}{8}$ " Dia. ... ..	"	30	
9 15 65293	5127-126		<b>SPRING ARM COMPLETE</b> ... ..	"	14	
9 15 65294	5127-51	61	Arm, Spring ... ..	"	2	Sub Assy. No. 3
9 15 65295	5127-71	62	Roller ... ..	"	2	4E43
9 15 65296	5127-66	63	Pin, Spring ... ..	"	2	31E27
9 15 65297	5127-80	64	Spindle ... ..	"	2	91E42
9 15 94369	112-101		Rivet, Steel, Csk., $\frac{3}{16}$ " x $\frac{1-13}{16}$ ", Special ... ..	"	4	31E25
9 15 65371	5127-58		Bar, Tie ... ..	"	4	
	90-2		Locknut, $\frac{5}{16}$ " Whit. ... ..	"	3	17E16B
9 15 65305	5128-5	65	<b>Spring, Moving Contact, G.E.C.</b> ... ..	"	4	
9 15 65372	5127-141		<b>SPRING SUPPORT ANGLE COMPLETE</b> ... ..	"	10	S5E4258A *
9 15 65373	5127-77	66	Angle ... ..	"	1	Sub Assy. No. 14
9 15 65374	5127-41	67	Plate ... ..	"	1	11E60
	121-7		Screw, $\frac{1}{4}$ " Whit. x $\frac{3}{4}$ " ... ..	"	1	11D28
	5127-109		Locknut, Half, "Simmonds", $\frac{1}{4}$ " Whit. ... ..	"	2	
9 15 65251	5127-48		Bracket ... ..	"	2	300/123A
9 11 656	13-10	68	<b>Ball, Steel, <math>\frac{1}{2}</math>" Dia.</b> ... ..	"	1	11E58
	121-8		Screw, $\frac{1}{4}$ " Whit. x 1" ... ..	"	1	Handle Block
	90-1		Locknut, $\frac{1}{4}$ " Whit. ... ..	"	6	
9 15 65330	5127-84	69	Screw, Thrust ... ..	"	6	
	90-5	70	Locknut, $\frac{1}{2}$ " Whit. ... ..	"	1	61/E/11
9 15 65329	5127-79		<b>Spring, Gear Starwheel</b> ... ..	"	1	
9 15 65375	5127-85	71	<b>Spring, Direction Starwheel</b> ... ..	"	1	48E46
	134-2	72	Washer, Plain, $\frac{1}{4}$ " (Spring)... ..	"	1	48/43
	5127-109		Locknut, Half, "Simmonds", $\frac{1}{4}$ " Whit. ... ..	"	2	300/123A
9 15 65376	5127-118		Starwheel, Santon Switch ... ..	R7718	1	96E9
9 15 65377	5127-119		Bracket, Angle, Top ... ..	"	1	11B172/1
9 15 65378	5127-120		Bracket, Angle, Bottom ... ..	"	1	11B172/2
9 15 65379	5156-1		<b>SWITCH COMPLETE, SANTON</b> ... ..	"	1	SRI125MN12 †
	121-87		Screw, $\frac{1}{4}$ " Whit. x $\frac{5}{8}$ " ... ..	"	4	
	5127-109		Locknut, Half, "Simmonds" } Switch to Brackets	"	4	
	134-2		Washer, Plain, $\frac{1}{4}$ " ... ..	"	8	300/123A
	121-87		Screw, $\frac{1}{4}$ " Whit. x $\frac{5}{8}$ " ... ..	"	4	
	85-2		Nut, Plain, $\frac{1}{4}$ " Whit. ... ..	"	4	
	135-32		Washer, Grover, $\frac{1}{4}$ " ... ..	"	4	Bracket to Controller

B.R. Cat. No.	A.E.C. Basic Part No.	Plate Ref.	Designation	Used on	No. Req. per Control Gear	Remarks
			<b>CONTROL GEAR—Continued</b>		(See Note below)	(Power and Trailer Cars)
9/15/65380	373-453		<b>ENGINE SPEED INDICATOR, SMITHS RMC58/2</b> ... ..	DT01/13, 1/15, 1/12, 1/14, 1/16, 1/17, 1/18, 1/21, 1/23, 1/25, 1/26, 1/27, 1/31, 1/33, 1/32, 1/30, 1/34, 1/38, 1/40, 1/39, 1/41, 1/49, 1/52, 1/53, 1/54, 1/55, 1/57	1	Not req. on 20 Power Cars of DT01/12
9/15/65381	UI82533		<b>ENGINE SPEED INDICATOR, SMITHS RMC58/5</b> ... ..	DT01/28, 1/28A, 1/35, 1/42, 1/43, 1/45, 1/56	1	0-100 lbs. per <input type="checkbox"/> inch. Black Dial, White Needle and Markings
9/15/65382	5041-2		<b>AIR PRESSURE GAUGE, BUDENBURG Q/6646</b> ... ..	DT01/13, 1/15, 1/12, 1/14, 1/16, 1/17, 1/21, 1/22, 1/24, 1/25, 1/27, 1/31, 1/33, 1/34, 1/40, 1/39, 1/43, 1/44, 1/45, 1/52, 1/57	1	
9/15/65383	5038-33		<b>VACUUM GAUGE, GRESHAM AND CRAVEN, No. 14116</b> ... ..	DT01/15, 1/17, 1/22, 1/25	1	Power Car only DT01/15 D/E Power Car—DT01/25
9/15/63792	546-1390		<b>CHANGE OVER SWITCH, BULGIN No. 5603PD</b> ... ..	DT01/13, 1/15, 1/12, 1/14, 1/16, 1/17, 1/18, 1/22, 1/21, 1/23, 1/24, 1/25, 1/27, 1/28, 1/31, 1/33, 1/30, 1/34, 1/38, 1/40, 1/39, 1/41, 1/44, 1/53, 1/49, 1/50, 1/52, 1/54, 1/55, 1/57	1	
9/15/65384	VI/5117		<b>ENGINE CONTROL PANEL COMPLETE</b>	DT01/12, 1/13, 1/15, 1/14, 1/17, 1/18, 1/24	1	50 Power & 50 Trailer Cars of DT01/18 Trailer Car on DT01/12
9/15/65385	VI/5150		<b>ENGINE CONTROL PANEL COMPLETE</b>	DT01/12	1	Not req. on 20 Power Cars of DT01/12
9/15/65386	VI/5160		<b>ENGINE CONTROL PANEL COMPLETE</b>	DT01/16	1	
9/15/65387	VI6424		Panel ... ..	VI/5117, VI/5150 VI/5160	1	
9/15/65107	339-1375		<b>LAMP FITTING, SIGNAL, BULGIN No. D133/G</b> ... ..	"	12	
9/15/65108	416-371		<b>Bulb, 32 V. 2.8 Watt</b> ... ..	"	12	
9/15/63777	546-1198		<b>Switch, Press Button, C.A.V. No. 108/3</b> ... ..	"	1	Pass. Comm.
9/15/63788	546-1393		<b>Switch, Press Button, C.A.V. No. 108/43</b> ... ..	"	2	Start
9/15/63789	546-1394		<b>Switch, Press Button, C.A.V. No. 108/4</b> ... ..	"	1	Stop
	146-12		<b>Screw, Rd. Hd., No. 2 B.A. x 1/2"</b> ... ..	"	8	
	153-19		<b>Washer, Grover, No. 2 B.A.</b> ... ..	"	8	
			<b>NOTE:—Quantities are doubled on 20 Power Cars of DT01/25 and all Power Cars of DT01/57 (Double Ended Controls)</b>			

B.R. Cat. No.	A.E.C. Basic Part No.	Plate Ref.	Designation	Used on	No. Req. per Control Gear	Remarks
			<b>CONTROL GEAR—Continued</b>			(Power and Trailer Cars)
			<b>ENGINE CONTROL PANEL—Continued</b>			(See Note below)
				DTOI/12, 1/13, 1/14, 1/15, 1/16, 1/17, 1/18, 1/24		
9/15/65388	341-1653		Label ... ..	"	1	Engine Stop
9/15/65389	341-1682		Label ... ..	VI/5117	1	Bell
9/15/65390	341-1685		Label ... ..	VI/5150	1	Signal Push
9/15/65391	341-1704		Label ... ..	VI/5160	1	Buzzer
9/15/65392	341-1651		Label ... ..	VI/5117, VI/5150 VI/5160	1	L.H. Engine
9/15/65393	341-1647		Label ... ..	"	1	Car 1
9/15/65394	341-1648		Label ... ..	"	1	Car 2
9/15/65395	341-1649		Label ... ..	"	1	Car 3
9/15/65396	341-1650		Label ... ..	"	1	Car 4
	146-38		Screw, Rd. Hd., No. 6 B.A. x 1/2"	"	16	} Label
	149-7		Nut, Plain, No. 6 B.A.	"	16	
	135-102		Washer, Shakeproof, 1/8" External	"	16	
9/15/65397	546-1440		Switch, Press Button, C.A.V. No. 221/9	DTOI/13	1	} Start
9/15/63788	546-1393		Switch, Press Button, C.A.V. No. 108/43		2	
9/15/63789	546-1394		Switch, Press Button, C.A.V. No. 108/4	DTOI/12	1	Stop
9/15/65398	VI/5152		<b>ENGINE CONTROL PANEL COMPLETE</b>	DTOI/18, 1/21, 1/23, 1/25, 1/27, 1/28, 1/31, 1/33, 1/30, 1/38, 1/40, 1/39 (1st 71 Cars), 1/41 (1st 41 Cars), 1/43 (1st 30 Cars), 1/45 (1st 15 Cars), 1/48 (1 Car)	} 1	
9/15/65399	VI/5197		<b>ENGINE CONTROL PANEL COMPLETE</b>	DTOI/39 (Last 35 Cars) 1/41 (Last 25 Cars) 1/45 (Last 35 Cars), 1/48 (9 Cars), 1/44, 1/49, 1/50, 1/52, 1/54, 1/55, 1/57 VI/5152, VI/5197		
9/15/65400	VI6433		Panel ... ..		1	
9/15/65401	339-1332		<b>LAMP FITTING, SIGNAL, ROTAX No. N63462</b>	VI/5152	18	
9/15/65108	416-371		Bulb, 32 V., 2-8 Watt	"	18	
9/15/65402	339-1454		<b>LAMP FITTING, SIGNAL, C.A.V. No. WN62/2514</b>	VI/5197	18	
9/15/65403	416-394		Bulb, 24 V., 2-8 Watt. M.E.S.	"	18	
9/15/63788	546-1393		Switch, Press Button, C.A.V. No. 108/43	VI/5152, VI/5197	2	} Start Stop
9/15/63789	546-1394		Switch, Press Button, C.A.V. No. 108/4	"	1	
	146-12		Screw, Rd. Hd., No. 2 B.A. x 1/2"	"	6	
	153-19		Washer, Grover, No. 2 B.A.	"	6	
			<b>NOTE:—Quantities are doubled on 20 Power Cars of DTOI/25 and all Power Cars of DTOI/57 (Double Ended Controls)</b>			

B.R. Cat. No.	A.E.C. Basic Part No.	Plate Ref.	Designation	Used on	No. Req. per Control Gear	Remarks
			<b>CONTROL GEAR—Continued</b>		(See Note below)	(Power and Trailer Cars)
9/15/65404	UI82506		<b>ENGINE CONTROL PANEL COMPLETE</b>	DTO1/26, 1/32	2	
9/15/65405	UI82505		Panel ... ..	"	2	
9/15/65401	339-1332		<b>LAMP FITTING, SIGNAL, ROTAX N63462</b>	"	6	
9/15/65108	416-371		<b>BULB, 32 V., 2-8 WATT ... ..</b>	"	6	
9/15/63788	546-1393		Switch, Press Button, C.A.V. No. 108/43...	"	2	Start
9/15/63789	546-1394		Switch, Press Button, C.A.V. No. 108/4 ...	"	2	Stop
	146-12		Screw, Rd. Hd., No. 2 B.A. x 1/2" ... ..	"	8	
	153-19		Washer, Grover, No. 2 B.A. ... ..	"	8	
9/15/65402	339-1454		<b>LAMP FITTING, SIGNAL, C.A.V. No. WN62/2514 ... ..</b>	DTO/53	18	
9/15/65403	416-394		Bulb, 24 V., 2-8 Watt, M.E.S. ... ..	"	18	
9/15/63788	546-1393		Switch, Press Button, C.A.V. No. 108/43	"	2	Start
9/15/63789	546-1394		Switch, Press Button, C.A.V. No. 108/4 ...	"	1	Stop
9/15/63794	339-1327		Lampholder, "Bill" Switchgear No. LH15 ...	DTO1/15, 1/12, 1/14, 1/16, 1/17, 1/18, 1/21, 1/23, 1/24, 1/25, 1/26, 1/27, 1/28, 1/31, 1/32, 1/33, 1/30, 1/38, 1/40, 1/39, 1/41, 1/43, 1/44, 1/50	5	6 off on DTO1/13
9/15/63795	416-364		<b>Bulb, 35 V., 6 Watt ... ..</b>	"	5	6 off on DTO1/13; not req. on DTO1/25
	147-31		Screw, Rd. Hd., No. 5 B.A. x 5/8" ... ..	DTO1/13, 1/15, 1/12, 1/14, 1/16, 1/17, 1/18, 1/21, 1/23, 1/24, 1/25, 1/26, 1/27, 1/28, 1/31, 1/33, 1/30, 1/38, 1/40, 1/39, 1/41, 1/43, 1/44, 1/50	10	
	149-17		Nut, Plain, No. 5 B.A. ... ..	1/14, 1/16, 1/17, 1/18, 1/21, 1/23, 1/24, 1/25, 1/26, 1/27, 1/28, 1/31, 1/33, 1/30, 1/38, 1/40, 1/39, 1/41, 1/43, 1/44, 1/50	10	
	153-22		Washer, Grover, No. 5 B.A. ... ..	1/14, 1/16, 1/17, 1/18, 1/21, 1/23, 1/24, 1/25, 1/26, 1/27, 1/28, 1/31, 1/33, 1/30, 1/38, 1/40, 1/39, 1/41, 1/43, 1/44, 1/50	10	
9/15/63793	546-1391		<b>Single Pole On-Off Switch, Bulgin No. 5602PD</b>	DTO1/13, 1/15, 1/12, 1/16, 1/17, 1/18, 1/23, 1/24, 1/25, 1/27, 1/28, 1/31, 1/33, 1/30, 1/38, 1/40, 1/39, 1/41, 1/43, 1/44, 1/49, 1/50, 1/54	1	3 off on DTO1/14, 1/21, 1/26, 1/32
<p><b>NOTE:—Quantities are doubled on 20 Power Cars of DTO1/25 and all Power Cars of DTO1/57 (Double Ended Controls)</b></p>						



B.R. Cat. No.	A.E.C. Basic Part No.	Plate Ref.	Designation	Used on	No. Req. per Control Gear	Remarks	
			<b>CONTROL GEAR—Continued</b>			(Power and Trailer Cars)	
9/15/65406	VI/5156		<b>INSTRUMENT PANEL COMPLETE</b> ...	DTOI/22, 1/34	} 1		
9/15/65407	U189624		<b>INSTRUMENT PANEL COMPLETE</b> ...	DTOI/51, 1/56		1	
9/15/65408	VI/5155 VI6434		<b>INSTRUMENT PANEL WITH BRACKETS</b> Bracket ... ..	VI/5156, U189624		1	Not supplied as Spares
9/15/65380	373-453		<b>ENGINE SPEED INDICATOR, SMITHS</b> <b>RMC58/2</b> ... ..	"	1		
9/15/65104	Z13/30712		Bolt, Special... ..	"	4		
	85-32		Nut, Plain, 1/8" B.S.F. ... ..	"	4		
	153-17		Washer, Grover, No. 0 B.A. ... ..	"	4		
9/15/65382	5041-2		<b>AIR PRESSURE GAUGE, BUDENBURG</b> <b>Q6646</b> ... ..	"	1	0-100 lbs. per <input type="checkbox"/> inch. Black dial, white markings	
	Z12/30721		Screw, Special ... ..	"	3		
	149-14		Nut, Plain, No. 2 B.A. ... ..	"	3		
	153-19		Washer, Grover, No. 2 B.A. ... ..	"	3		
9/15/65409	VI/14531		Bracket ... ..	"	1		
	Z12/30710		Screw, Special ... ..	"	2		
	149-14		Nut, Plain, No. 2 B.A. ... ..	"	2		
	153-19		Washer, Grover, No. 2 B.A. ... ..	"	2		
9/15/63794	339-1327		<b>Lampholder, "Bill" Switchgear No. LH15...</b>	VI/5156	5		
9/15/63795	416-364		<b>Bulb, 35 V., 6 Watt</b> ... ..	"	5		
	147-31		Screw, Rd. Hd., No. 5 B.A. x 1/8" ... ..	"	10		
	149-17		Nut, Plain, No. 5 B.A. ... ..	"	10		
	153-22		Washer, Grover, No. 5 B.A. ... ..	"	10		
9/15/65410	VI/5149		<b>ENGINE CONTROL PANEL COMPLETE</b>	DTOI/22, 1/34	} 1		
9/15/65411	VI/5196		<b>ENGINE CONTROL PANEL COMPLETE</b>	DTOI/51, 1/56		1	
9/15/65412	VI6432		Panel ... ..	VI/5149, VI/5196	1		
9/15/63792	546-1390		<b>CHANGE OVER SWITCH, BULGIN No.</b> <b>5603PD</b> ... ..	"	1		
9/15/63793	546-1391		<b>SINGLE POLE ON-OFF SWITCH, BULGIN No. 5602PD</b> ... ..	"	1		
9/15/65401	339-1332		<b>LAMP FITTING, SIGNAL, ROTAX No.</b> <b>N63462</b> ... ..	VI/5149	18		
9/15/65108	416-371		Bulb, 32 V., 2.8 Watt ... ..	"	18		
9/15/65402	339-1454		<b>LAMP FITTING, SIGNAL, C.A.V. No.</b> <b>WN62/2514</b> ... ..	VI/5196	18		
9/15/65403	416-394		Bulb, 24 V., 2.8 Watt, M.E.S. ... ..	"	18		
9/15/63788	546-1393		<b>Switch, Press Button, C.A.V. No. 108/43</b> ...	VI/5149, VI/5196	2	Start	
9/15/63789	546-1394		<b>Switch, Press Button, C.A.V. No. 108/4</b> ...	"	1	Stop	
	146-12		Screw, Rd. Hd., No. 2 B.A. x 1/2" ... ..	"	6		
	153-19		Washer, Grover, No. 2 B.A. ... ..	"	6		

B.R. Cat. No.	A.E.C. Basic Part No.	Plate Ref.	Designation	Used on	No. Req. per Control Gear	Remarks
		<b>R4</b>	<b>CONTROL GEAR—Continued</b> ... ..			(Power Cars)
9/15/65413	V7533		<b>ELECTRIC PNEUMATIC VALVE COMPLETE, 6 VALVES</b> ... ..	Not DTOI/26, 1/32, 1/35, 1/42, 1/48, 1/49	1	} Alternatives
9/15/65414	V7536		<b>ELECTRIC PNEUMATIC VALVE COMPLETE, 6 VALVES</b> ... ..			
9/15/65415	U192383		<b>ELECTRIC PNEUMATIC VALVE COMPLETE, 6 VALVES</b> ... ..	DTOI/45		6 off per Order
9/15/65416	V7523		<b>ELECTRIC PNEUMATIC VALVE COMPLETE, 6 VALVES</b> ... ..	DTOI/26, 1/32	1	} Not supplied as Spares
9/15/65417	V7522	} 24	<b>VALVE CASING WITH STIFFENERS</b> ... ..	V7533, V7523		
9/15/65418	V7535			<b>VALVE CASING WITH STIFFENERS</b> ... ..	V7536, U192383	
	V38084		Casing, Bare ... ..	V7522	1	
	V1/38002		Casing, Bare ... ..	V7535	1	
9/15/65423	Z8/30566	25	Stud, Special, $\frac{7}{16}$ " B.S.F. ... ..	V7533, V7536, V7523, U192383	1	
9/15/65114	V38043	26	Bar, Locating ... ..	"	6	
9/15/65115	112-72	27	Rivet, Iron, Csk., $\frac{1}{8}$ " x $\frac{1}{2}$ " ... ..	"	12	
9/15/65419	341-1656		Plate, Identification... ..	Not U192383	1	}
9/15/65420	341-1657		Plate, Identification... ..	U192383		
9/15/65421	341-1659		Plate, Number ... ..	Not U192383	1	}
9/15/65422	U189585		Plate, Number ... ..	U192383		
	109-422		Rivet, Bifurcated, $\frac{1}{8}$ " x $\frac{7}{16}$ " ... ..	"	6	Copper
9/15/65118	V38052	29	Cover ... ..	V7533, V7536, V7523, U192383	1	
9/15/65119	Z51738	30	<b>Felt Seal, 8<math>\frac{1}{8}</math>" Long</b> ... ..	"	2	} Cover
9/15/65120	Z51739	31	<b>Felt Seal, 19<math>\frac{3}{8}</math>" Long</b> ... ..	"	2	
	90-34		Locknut, $\frac{7}{16}$ " B.S.F.... ..	"	1	
9/15/65121	V38044	32	Boss, Thumb Screw ... ..	"	1	
9/15/65424	114-188	33	Rivet, Snap Hd., $\frac{5}{32}$ " x $\frac{5}{8}$ " ... ..	"	4	
9/15/65123	A74103	34	Nut, Special, $\frac{7}{16}$ " B.S.F. ... ..	"	1	
9/15/65124	Z48801	35	Circlip, Special, 19 m/m. Dia. ... ..	"	1	
9/15/65425	V38066	} 36	Block, Manifold ... ..	V7533, V7523, V7536, U192383	1	} Manifold Block
9/15/65426	V1/38005			Block, Manifold ... ..	V7536, U192383	
9/15/65427	Z51787		<b>Joint...</b> ... ..	"	1	
9/15/65126	Z1/44569	37	Plug ... ..	V7533, V7523, V7536, U192383	6	
	117-83	38	Screw, Csk., $\frac{5}{16}$ " B.S.F. x $\frac{3}{8}$ " ... ..	"	3	} Manifold Block
9/15/65127	124-158	39	Stud, $\frac{3}{8}$ " B.S.F. x $1\frac{7}{8}$ ", Special ... ..	"	4	
	85-34	40	Nut, Plain, $\frac{3}{8}$ " B.S.F. ... ..	"	4	
	135-34	41	Washer, Grover, $\frac{3}{8}$ " ... ..	"	4	
9/15/65128	Z3/10201	42	<b>Bush...</b> ... ..	"	18	
9/15/65429	V1/38001		<b>ELECTRIC PNEUMATIC VALVE</b> ... ..	V7533	6	} A.E.I. Type TE.505 Form 4 Magnet Valve A.E.I. W.1362147 A.E.I. Y.2421349
			<b>ELECTRIC PNEUMATIC VALVE</b> ... ..	"		
9/15/65130	V38007	} 43	<b>ELECTRIC PNEUMATIC VALVE</b> ... ..	V7523	6	} Electric Pneumatic Valves
9/15/65430	V1/38004			<b>ELECTRIC PNEUMATIC VALVE</b> ... ..		
9/15/65132	Z51741	} 46	<b>Gasket, A.E.I. X.1216778-1</b> ... ..	V7533, V7523	6	} Electric Pneumatic Valves
9/15/65431	Z51786			<b>Gasket, A.E.I. Type TE.514, Form L...</b> ... ..		
9/15/65134	Z12/30760	} 48	Bolt, Special, $\frac{3}{8}$ " B.S.F. x 2", Drilled ... ..	V7533, V7523	12	} Electric Pneumatic Valves
9/15/65433	Z12/30770			Bolt, Special, $\frac{3}{8}$ " B.S.F. x 2 $\frac{1}{8}$ ", Drilled ... ..		
	Z4/30696	49	Washer, $\frac{3}{8}$ ", Grover ... ..	V7533, V7523, V7536, U192383	12	
9/15/65434	V38089		Support, Control Wiring ... ..	"	1	} Casing
9/15/65135	331-49	50	Plug, $\frac{3}{8}$ " Gas ... ..	"	2	
9/15/65136	331-48	51	Plug, $\frac{1}{4}$ " Gas ... ..	"	6	

B.R. Cat. No.	A.E.C. Basic Part No.	Plate Ref.	Designation	Used on	No. Req. per Control Gear	Remarks
9/15/65435	V7534	R4	<b>CONTROL GEAR—Continued</b>			(Power Cars)
9/15/65436	V7537		<b>ELECTRIC PNEUMATIC VALVE COMPLETE, 4 VALVES</b> ...	Not DTOI/26, 1/32, 1/42, 1/48, 1/49	1 (See Note below)	With Ext. Exhaust Valves } Alternatives
9/15/65417	V7522		<b>ELECTRIC PNEUMATIC VALVE COMPLETE, 4 VALVES</b> ...			
9/15/65418	V7535	52	<b>VALVE CASING WITH STIFFENERS</b> ...	V7534	1	Not supplied as Spares
	V38084		<b>VALVE CASING WITH STIFFENERS</b> ...	V7537		
	V1/38002		Casing ...	V7522	1	
9/15/65423	Z8/30566	53	Stud, Special, $\frac{7}{16}$ " B.S.F. ...	V7535	1	
9/15/65114	V38043	54	Bar, Locating ...	V7534, V7537	1	
9/15/65115	112-72	55	Rivet, Iron, Csk., $\frac{1}{8}$ " x $\frac{1}{2}$ " ...	"	6	
9/15/65420	341-1657		Plate, Identification... ..	"	12	
9/15/65437	341-1658		Plate, Number ... ..	"	1	
	109-422		Rivet, Bifurcated, $\frac{1}{8}$ " x $\frac{7}{16}$ " ...	"	1	
9/15/65118	V38052	57	Cover ... ..	"	6	Copper
9/15/65119	Z51738	58	<b>Felt Seal, <math>8\frac{1}{8}</math>" Long</b> ... ..	"	1	
9/15/65120	Z51739	59	<b>Felt Seal, <math>19\frac{3}{8}</math>" Long</b> ... ..	"	2	
	90-34		Locknut, $\frac{7}{16}$ " B.S.F. ... ..	"	1	
9/15/65121	V38044	60	Boss, Thumb Screw ... ..	"	1	Cover
9/15/65424	114-188	61	Rivet, Snap Hd., $\frac{5}{32}$ " x $\frac{5}{16}$ " ... ..	"	4	
9/15/65123	A74103	62	Nut, Special, $\frac{7}{16}$ " B.S.F. ... ..	"	1	
9/15/65124	Z48801	63	Circlip ... ..	"	1	
9/15/65425	V38066	64	Block, Manifold ... ..	V7534	1	
9/15/65426	V1/38005		Block, Manifold ... ..	V7537		
9/15/65427	Z51787		<b>Joint...</b> ... ..	"	1	
9/15/65126	Z1/44569		Plug, Special... ..	V7534, V7537	6	
	117-83	66	Screw, Csk., $\frac{5}{16}$ " B.S.F. x $\frac{3}{4}$ " ... ..	"	3	
9/15/65127	124-158	67	Stud, $\frac{3}{8}$ " B.S.F. x $1\frac{1}{8}$ ", Special ... ..	"	4	Manifold Block
	85-34	68	Nut, Plain, $\frac{3}{8}$ " B.S.F. ... ..	"	4	
	135-34	69	Washer, Grover, $\frac{3}{8}$ " ... ..	"	4	
9/15/65128	Z3/10201	70	<b>Bush</b> ... ..	"	12	
9/15/65429	V1/38001	71	<b>ELECTRIC PNEUMATIC VALVE</b> ... ..	V7534	4	A.E.I. Type TE.505 Form 4 Magnet Valve A.E.I. Y.2421349
9/15/65430	V1/38004		<b>ELECTRIC PNEUMATIC VALVE</b> ... ..	V7537		
9/15/65137	V38046	72	Plate, Blanking ... ..	V7534	2	Casing
9/15/65438	V1/38003		Plate, Blanking ... ..	V7537		
9/15/65132	Z51741	73	<b>Gasket, A.E.I. X.1216778-1</b> ... ..	V7534	6	
9/15/65431	Z51786		<b>Gasket, A.E.I. Type TE.514 Form L</b> ... ..	V7537		
9/15/65134	Z12/30760	75	Bolt, Special, $\frac{3}{8}$ " B.S.F. x 2", Drilled ... ..	V7534	8	Electric Pneumatic Valves and Blanking Plates
9/15/65433	Z12/30770		Bolt, Special, $\frac{3}{8}$ " B.S.F. x $2\frac{1}{8}$ ", Drilled ... ..	V7537		
9/15/35459	Z11/30783		Bolt, Special, $\frac{3}{8}$ " B.S.F. x 1", Drilled ... ..	V7534, V7537		
	Z4/30696	76	Washer, $\frac{3}{8}$ " Grover... ..	"	12	
9/15/65434	V38089		Support, Control Wiring ... ..	"	1	
9/15/65135	331-49	77	Plug, $\frac{3}{8}$ " Gas... ..	"	2	Casing
9/15/65136	331-48	78	Plug, $\frac{1}{4}$ " Gas ... ..	"	6	

NOTE:—DTOI/45—V7537—4 off total per Order

B.R. Cat. No.	A.E.C. Basic Part No.	Plate Ref.	Designation	Used on	No. Req. per Control Gear	Remarks
9/15/65439	UI84945	R4	<b>CONTROL GEAR—Continued</b>			(Power Cars)
9/15/65417	V7522 V38084	52	<b>ELECTRIC PNEUMATIC VALVE COMPLETE, 5 VALVES</b> ... ..	DT01/26, 1/32	1	
9/15/65423	Z8/30566	53	<b>VALVE CASING WITH STIFFENERS</b> ... ..	"	1	Not supplied as Spares
9/15/65114	V38043	54	Casing ... ..	"	1	
9/15/65115	112-72	55	Stud, Special, $\frac{7}{16}$ " B.S.F. ... ..	"	1	
9/15/65420	341-1657		Bar, Locating ... ..	"	6	
9/15/65440	UI82507		Rivet, Iron, Csk., $\frac{1}{8}$ " x $\frac{1}{2}$ " ... ..	"	12	
	108-63		Plate, Identification ... ..	"	1	
	V38052	57	Plate, Number ... ..	"	1	
9/15/65118	Z51738	58	Rivet, Snap Hd., $\frac{3}{32}$ " x $\frac{3}{8}$ " ... ..	"	6	Copper
9/15/65119	Z51739	59	Cover ... ..	"	1	
9/15/65120	90-34		<b>Felt Seal, Length 8<math>\frac{1}{8}</math>"</b> ... ..	"	2	
9/15/65121	V38044	60	<b>Felt Seal, Length 19<math>\frac{3}{8}</math>"</b> ... ..	"	2	
9/15/65424	114-188	61	Locknut, $\frac{7}{16}$ " B.S.F. ... ..	"	1	
9/15/65123	A74103	62	Boss, Thumb Screw ... ..	"	1	
9/15/65124	Z48801	63	Rivet, Snap Hd., $\frac{5}{32}$ " x $\frac{5}{8}$ " ... ..	"	4	Mild Steel
9/15/65125	V38051	64	Nut, Special, $\frac{7}{16}$ " B.S.F. ... ..	"	1	} Cover
	117-83	66	Circlip, Special, 19 m/m. Dia. ... ..	"	1	
9/15/65127	124-158	67	Block, Manifold ... ..	"	1	
	85-34	68	Screw, Csk., $\frac{5}{16}$ " B.S.F. x $\frac{3}{4}$ " ... ..	"	3	
	135-34	69	Stud, $\frac{3}{8}$ " B.S.F. x 1 $\frac{7}{8}$ ", Special ... ..	"	4	} Manifold Block
9/15/65128	Z3/10201	70	Nut, Plain, $\frac{3}{8}$ " B.S.F. ... ..	"	4	
9/15/65130	V38007	71	Washer, Grover, $\frac{3}{8}$ " ... ..	"	4	
			<b>Bush</b> ... ..	"	10	
9/15/65441	UI84944		<b>ELECTRIC PNEUMATIC VALVE</b> ... ..	"	4	"On" Type A.E.I. W.1363147
9/15/65137	V38046	72	<b>ELECTRIC PNEUMATIC VALVE</b> ... ..	"	1	"Off" Type A.E.I. TE.510 Form B. Magnet Valve Casing
9/15/65132	Z51741	73	Plate, Blanking ... ..	"	1	
9/15/65131	Z51740	74	<b>Gasket, A.E.I. X.1216778-1</b> ... ..	"	5	
			<b>Gasket, A.E.I. X.1216778-12</b> ... ..	"	1	
9/15/65134	Z12/30760		Bolt, Special, $\frac{3}{8}$ " B.S.F. x 2", Drilled ... ..	"	8	Use with UI84944
9/15/65133	Z12/30763	75	Bolt, Special, $\frac{3}{8}$ " B.S.F. x 2 $\frac{1}{2}$ ", Drilled ... ..	"	2	Use with V38007
9/15/35459	Z11/30783		Bolt, Special, $\frac{3}{8}$ " B.S.F. x 1", Drilled ... ..	"	2	Use with UI84944
	Z4/30696	76	Washer, $\frac{3}{8}$ " Grover ... ..	"	2	Use with V38046
9/15/65138	V38036		Support, Control Wiring ... ..	"	12	} Electric Pneumatic Valves and Blanking Plate
9/15/65135	331-49	77	Plug, $\frac{3}{8}$ " Gas ... ..	"	1	
9/15/65136	331-48	78	Plug, $\frac{1}{4}$ " Gas ... ..	"	2	
				"	6	} Casing

B.R. Cat. No.	A.E.C. Basic Part No.	Plate Ref.	Designation	Used on	No. Req. per Control Gear	Remarks
			<b>CONTROL GEAR—Continued</b>			(Power Cars)
9/15/65442	V7553		<b>ELECTRIC PNEUMATIC VALVE COMPLETE, 6 VALVES</b> ... ..	DT01/49	1	
9/15/65443	V7552		<b>VALVE CASING WITH STIFFENERS</b> ... ..	"	1	
	V1/38023		Casing, Bare ... ..	"	1	Not supplied as Spares
9/15/65114	V38043		Bar, Locating ... ..	"	6	
9/15/65115	112-72		Rivet, Iron, Csk., $\frac{1}{8}'' \times \frac{1}{2}''$ ... ..	"	12	
9/15/65419	341-1656		Plate, Identification ... ..	"	1	
9/15/65421	341-1659		Plate, Number ... ..	"	1	
	109-422		Rivet, Bifurcated, $\frac{1}{8}'' \times \frac{7}{16}''$ ... ..	"	6	Copper
9/15/65118	V38052		Cover ... ..	"	1	
9/15/65119	Z51738		<b>Felt Seal, Length <math>8\frac{1}{8}''</math></b> ... ..	"	2	
9/15/65120	Z51739		<b>Felt Seal, Length <math>19\frac{3}{8}''</math></b> ... ..	"	2	
9/15/65423	Z8/30566		Stud, Special, $\frac{7}{16}''$ B.S.F. ... ..	"	1	
	90-34		Locknut, $\frac{7}{16}''$ B.S.F. ... ..	"	1	
9/15/65121	V38044		Boss, Thumb Screw ... ..	"	1	
9/15/65424	114-188		Rivet, Snap Hd., $\frac{5}{32}'' \times \frac{5}{8}''$ ... ..	"	4	Mild Steel
9/15/65444	V1/38019		Nut, Special, $\frac{7}{16}''$ B.S.F. Thumb Screw ... ..	"	1	
9/15/65124	Z48801		Circlip, Special, 19 m/m. ... ..	"	1	
9/15/65445	V7555		<b>MANIFOLD COMPLETE WITH ELECTRIC PNEUMATIC VALVES</b> ... ..	"	1	
			Manifold ... ..	"	1	Bellows Valvair Ltd.
9/15/65446	V1/38014		<b>ELECTRIC PNEUMATIC VALVE</b> ... ..	"	6	Bellows Valvair Ltd.
9/15/65447	V1/38015		<b>ELECTRIC PNEUMATIC VALVE</b> ... ..	"	1	Bellows Valvair Ltd.
	117-83		Screw, Csk., $\frac{5}{16}''$ B.S.F. $\times \frac{3}{4}''$ ... ..	"	3	
9/15/65448	124-162		Stud, $\frac{3}{8}''$ B.S.F. $\times 2\frac{3}{8}''$ , Special ... ..	"	4	Electric Pneumatic Valve
	85-34		Nut, Plain, $\frac{3}{8}''$ B.S.F. ... ..	"	4	
	135-34		Washer, Grover, $\frac{3}{8}''$ ... ..	"	4	
9/15/65135	331-49		Plug, $\frac{3}{8}''$ Gas ... ..	"	2	Casing
9/15/65136	331-48		Plug, $\frac{1}{4}''$ Gas ... ..	"	6	
9/15/65449	V1/38024		<b>Gasket</b> ... ..	"	1	
9/15/65450	V1/38025		Strip, Blanking ... ..	"	2	Manifold
	143-18		Screw, Ch. Hd., No. 2 B.A. $\times \frac{1}{2}''$ ... ..	"	4	
	135-61		Washer, Shakeproof, $\frac{3}{16}''$ Internal ... ..	"	4	
9/15/65451	V1/38016		Block Terminal ... ..	"	1	
9/15/65452	V1/38022		Spacer ... ..	"	2	
9/15/65453	39-21		Bolt, $\frac{1}{4}''$ B.S.F. $\times 3\frac{1}{4}''$ , Special, Drilled ... ..	"	2	Terminal Block
	Z2/32045		Nut, $\frac{1}{4}''$ B.S.F. Plain ... ..	"	4	
	Z4/30691		Washer, $\frac{1}{4}''$ Steel, Bright ... ..	"	2	
9/15/65454	V1/38018		Plate, Terminal ... ..	"	1	
	426-74		Tag, Terminal ... ..	"	12	
	Z16/30798		Screw, 2 B.A. Cheese Hd., $1\frac{1}{2}''$ Long ... ..	"	7	
	Z21/30728		Screw, 2 B.A. Cheese Hd., $1\frac{3}{4}''$ Long ... ..	"	1	
	Z2/32056		Nut, 2 B.A. ... ..	"	15	Terminal
	Z2/32057		Locknut, Special ... ..	"	8	
	Z5/30602		Washer, $\frac{3}{16}''$ Steel, Bright ... ..	"	38	

B.R. Cat. No.	A.E.C. Basic Part No.	Plate Ref.	Designation	Used on	No. Req. per Control Gear	Remarks
9/15/65456	V7554		<b>CONTROL GEAR—Continued</b>			(Power Cars)
9/15/65443	V7552		<b>ELECTRIC PNEUMATIC VALVE COMPLETE, 4 VALVES ...</b>	DTOI/49	1	
	V1/38023		<b>VALVE CASING WITH STIFFENERS ...</b>	"	1	
9/15/65114	V38043		Casing, Bare ...	"	1	Not supplied as Spares
9/15/65115	112-72		Bar, Locating ...	"	6	
9/15/65420	341-1657		Rivet, Iron, Csk., $\frac{1}{8} \times \frac{1}{2}$ " ...	"	12	
9/15/65437	341-1658		Plate, Identification ...	"	1	
	109-422		Plate, Number ...	"	1	
9/15/65118	V38052		Rivet, Bifurcated, $\frac{1}{8} \times \frac{7}{16}$ " ...	"	6	Copper
9/15/65119	Z51738		Cover ...	"	1	
9/15/65120	Z51739		<b>Felt Seal, Length <math>8\frac{1}{8}</math>"</b> ...	"	2	
9/15/65423	Z8/30566		<b>Felt Seal, Length <math>19\frac{3}{8}</math>"</b> ...	"	2	
	90-34		Stud, Special, $\frac{7}{16}$ " B.S.F. ...	"	1	} Cover
9/15/65121	V38044		Locknut, $\frac{7}{16}$ " B.S.F. ...	"	1	
9/15/65424	114-188		Boss, Thumb Screw ...	"	1	
9/15/65444	V1/38019		Rivet, Snap Hd., $\frac{3}{32} \times \frac{3}{8}$ " ...	"	4	Mild Steel
9/15/65124	Z48801		Nut, Special, Thumb Screw, $\frac{7}{16}$ " B.S.F. ...	"	1	
9/15/65550	V7556		Circlip, Special, 19 m/m. ...	"	1	
			<b>MANIFOLD COMPLETE WITH ELECTRIC PNEUMATIC VALVES ...</b>			
9/15/65446	V1/38014		Manifold ...	"	1	Bellows Valvair Ltd.
9/15/65447	V1/38015		<b>ELECTRIC PNEUMATIC VALVE</b> ...	"	1	Bellows Valvair Ltd.
	117-83		Screw, Csk., $\frac{5}{16}$ " B.S.F. $\times \frac{3}{4}$ " ...	"	4	Bellows Valvair Ltd.
9/15/65448	124-162		Stud, $\frac{3}{8}$ " B.S.F. $\times 2\frac{3}{8}$ ", Special ...	"	3	} Electric Pneumatic Valve
	85-34		Nut, Plain, $\frac{3}{8}$ " B.S.F. ...	"	4	
	135-34		Washer, Grover, $\frac{3}{8}$ " ...	"	4	
9/15/65135	331-49		Plug, $\frac{3}{8}$ " Gas ...	"	2	
9/15/65136	331-48		Plug, $\frac{1}{4}$ " Gas ...	"	6	} Casing
9/15/65449	V1/38024		<b>Gasket</b> ...	"	1	
9/15/65450	V1/38025		Strip, Blanking ...	"	2	} Manifold
	143-18		Screw, Ch. Hd., No. 2 B.A. $\times \frac{1}{2}$ " ...	"	4	
	135-61		Washer, Shakeproof, $\frac{3}{16}$ " Internal ...	"	4	
9/15/65457	V1/38017		Block, Terminal ...	"	1	} Terminal Block
9/15/65452	V1/38022		Spacer ...	"	2	
9/15/65453	39-21		Bolt, $\frac{1}{2}$ " B.S.F. $\times 3\frac{1}{2}$ ", Special, Drilled ...	"	2	
	Z2/32045		Nut, $\frac{1}{2}$ " B.S.F., Plain ...	"	4	
	Z4/30691		Washer, $\frac{1}{2}$ ", Steel, Bright ...	"	2	
9/15/65454	V1/38018		Plate, Terminal ...	"	1	
	426-74		Tag, Terminal ...	"	8	} Terminal
	Z16/30798		Screw, 2 B.A., Ch. Hd., $1\frac{1}{2}$ " Long ...	"	5	
	Z21/30728		Screw, 2 B.A., Ch. Hd., $1\frac{1}{2}$ " Long ...	"	1	
	Z2/32056		Nut, 2 B.A. ...	"	11	
9/15/65455	Z2/32057		Locknut, Special ...	"	6	
	Z5/30602		Washer, $\frac{1}{16}$ ", Steel, Bright ...	"	28	

B.R. Cat. No.	A.E.C. Basic Part No.	Plate Ref.	Designation	Used on	No. Req. per Control Gear	Remarks
		<b>R6</b>	<b>CONTROL GEAR—Continued</b>			(Power Cars)
9/15/65458	R3107		<b>THROTTLE MOTOR COMPLETE</b> ... ..	DTOI/12, 1/16, 1/17, 1/22, 1/23, 1/24, 1/25, 1/26, 1/27, 1/31, 1/33, 1/32, 1/34, 1/40, 1/51, 1/56, 1/57	2 (See Note below)	
9/15/65459	R3109		<b>THROTTLE MOTOR COMPLETE</b> ... ..	DTOI/13, 1/15, 1/14, 1/18, 1/21, 1/28, 1/30, 1/38, 1/39, 1/41, 1/49		
9/15/65460 9/15/65461	R3110 R3203		<b>THROTTLE MOTOR COMPLETE</b> ... .. <b>THROTTLE MOTOR HOUSING WITH STUDS AND DOWEL</b> ... ..	DTOI/35, 1/45 R3107, R3109, R3110		2
	R1/32425	1	Housing ... ..	"	2	Not supplied as Spares
9/15/65462	Z8/30590	2	Stud, Special, $\frac{1}{4}$ " B.S.F., $1\frac{1}{2}$ " Long	"	4	} Side and End Cover
9/15/65463	Z8/30568	3	Stud, Special, $\frac{1}{4}$ " B.S.F., 1" Long	"	16	
9/15/65477	Z8/30567	4	Stud, Special, $\frac{1}{4}$ " B.S.F., $1\frac{1}{8}$ " Long	"	16	Air Cylinder
9/15/65464	Z2/44025	5	Dowel ... ..	"	4	
9/15/65465	124-154	6	Stud, $\frac{3}{8}$ " B.S.F. x $1\frac{3}{8}$ ", Special	"	8	} Housing
	85-34	7	Nut, Plain, $\frac{3}{8}$ " B.S.F.	"	8	
	135-34	8	Washer, Grover, $\frac{3}{8}$ "	"	8	
9/15/65466	R3206		<b>AIR CYLINDER COMPLETE</b> ... ..	R3107	8	} "L" Type Motor only. Valve Adaptor turned through 180°
9/15/65467	R3208		<b>AIR CYLINDER COMPLETE</b> ... ..	R3109, R3110		
9/15/65468	R3204		<b>AIR CYLINDER WITH BUSH AND STUDS</b> ... ..	R3206, R3208	8	
9/15/65469	R3205		<b>AIR CYLINDER WITH BUSH</b> ... ..	"	8	
9/15/65470	R1/32438	9	Air Cylinder ... ..	"	8	Not supplied as Spares
9/15/65471	Z4/10215	10	Bush ... ..	"	8	
9/15/65463	Z8/30568	11	Stud, Special, $\frac{1}{4}$ " B.S.F., 1" Long	"	24	Air Cylinder Cover
9/15/65472	S2/13399	12	Adaptor ... ..	"	8	} Air Cylinder
9/15/65473	138-224	} 13	Washer, Copper, $\frac{1}{2}$ " x $\frac{1}{2}$ " x $\frac{1}{8}$ ", Special	"	8	
9/15/65474	138-227		Washer, Copper, $\frac{3}{16}$ " x $\frac{1}{2}$ " x 24 l.v.g., Special	"	As req.	
9/15/65156	81-1994	14	Adaptor, Valve ... ..	"	8	Tecalemit Y.28275 (mod.)
9/15/65475	138-133	15	Washer, Copper, 17 x 23 x 2 m/m., Special	"	8	
9/15/65476	81-1302	16	Lubricator, Tecalemit NA5801-1	"	8	
9/15/65478	D40622	17	Piston ... ..	R3107, R3109, R3110	8	
9/15/65479	G27225	18	Cup, Piston ... ..	"	8	
9/15/65480	Z4/46549	19	Shim ... ..	"	As req.	} Piston Cup
9/15/65481	Z6/30697	20	Washer, Special, $\frac{3}{4}$ " O/D., $\frac{2}{16}$ " I/D. x $\frac{5}{32}$ "	"	8	
	90-153	21	Locknut, $\frac{5}{8}$ " B.S.F., "Simmonds"	"	8	
9/15/65482	R1/32430	22	Cover, Cylinder ... ..	"	8	} Cover to Air Cylinder
9/15/65483	Z44245	23	Joint ... ..	"	8	
	85-32	24	Nut, Plain, $\frac{1}{4}$ " B.S.F.	"	24	
	135-32	25	Washer, Grover, $\frac{1}{4}$ "	"	24	
9/15/65484	R1/10400	26	Shaft ... ..	"	2	} Throttle Motor Shaft
	157-3	27	Key, Woodruff, No. 3	"	10	
9/15/65485	Z8/44889	28	Boss, 1.577" ... ..	"	6	
9/15/65486	Z8/44884	29	Boss, 0.825" ... ..	"	2	

NOTE:—R3107 and Fittings supplied on 24 Power Cars of DTOI/14.  
R3110 on DTOI/50, 1/53 supplied by Albion Motors.

B.R. Cat. No.	A.E.C. Basic Part No.	Plate Ref.	Designation	Used on	No. Req. per Control Gear	Remarks
		<b>R6</b>	<b>CONTROL GEAR—Continued</b>			(Power Cars)
9/15/65487	R3/11232	30	<b>THROTTLE MOTOR—Continued</b>			
9/15/65488	40-36	31	Lever... ..	R3107, R3109	2	End Cover
	85-33	32	Bolt, $\frac{5}{16}$ " B.S.F. $\times$ $1\frac{1}{2}$ ", Special, Drilled ... ..	"	2	Lever to Shaft
	135-33	33	Nut, Plain, $\frac{5}{16}$ " B.S.F. ... ..	"	2	
9/15/65489	Z2/10100	34	Washer, Grover, $\frac{5}{16}$ " ... ..	"	2	
			<b>Bush</b> ... ..	R3107, R3109, R3110	4	
9/15/65490	R3/11225	35	Lever... ..	"	8	Air Cylinder
9/15/65491	R1/32427	36	Cover, End ... ..	"	2	Throttle Motor
9/15/65492	R1/32428	37	Cover, Side ... ..	"	2	
	85-32	38	Nut, Plain, $\frac{5}{16}$ " B.S.F. ... ..	"	20	Cover to Housing
	135-32	39	Washer, Grover, $\frac{5}{16}$ " ... ..	"	4	
	135-2	40	Washer, Thackray, $\frac{5}{16}$ " ... ..	"	16	
9/15/65493	R3/11224	41	Lever... ..	R3107, R3109	2	Control Cable Support End
9/15/61028	40-36	42	Bolt, $\frac{5}{16}$ " B.S.F. $\times$ $1\frac{1}{2}$ ", Special, Drilled ... ..	"	2	Lever to Shaft
	85-33	43	Nut, Plain, $\frac{5}{16}$ " B.S.F. ... ..	"	2	
	135-33	44	Washer, Grover, $\frac{5}{16}$ " ... ..	"	2	
9/15/65494	Z4/46517	45	Shim, 0.005" ... ..	R3107, R3109 R3110	As req.	Throttle Motor Shaft
9/15/65495	Z4/46518		Shim, 0.010" ... ..			
9/15/65496	Z4/46519	46	Shim, 0.015" ... ..	"	2	Piston Stop
9/15/40192	Z8/44885	47	Distance Piece ... ..	"	4	
9/15/65497	Z4/43706	48	Setscrew, Special, $\frac{3}{16}$ " B.S.F. $\times$ $\frac{7}{8}$ " ... ..	"	4	Air Cylinder
9/15/65498	Z4/43707	49	Setscrew, Special, $\frac{3}{16}$ " B.S.F. $\times$ $1\frac{1}{4}$ " ... ..	"	8	
	90-33	50	Locknut, $\frac{3}{8}$ " B.S.F. ... ..	"	16	
	85-33	51	Nut, Plain, $\frac{5}{16}$ " B.S.F. ... ..	"	16	Control Cable
9/15/65499	R13548	52	Washer, Plain, $\frac{5}{16}$ " ... ..	R3107	2	
9/15/65505	R13551		Plate, Support ... ..			
9/15/65500	R13550	53	Plate, Support ... ..	R3109	2	Pull Off Spring
	121-124	54	Plate, Support ... ..	"	2	
	121-123		55	Setscrew, $\frac{3}{8}$ " B.S.F. $\times$ $\frac{7}{8}$ " ... ..	R3107	4
	135-34		Setscrew, $\frac{3}{8}$ " B.S.F. $\times$ $\frac{3}{4}$ " ... ..	R3109	4	
9/15/65501	R6414		Washer, Grover, $\frac{3}{8}$ " ... ..	R3107, R3109	4	Not req. on 20 Power Cars of DTO1/12 Fitted to 24 Power Cars of DTO1/14
			<b>SUPPORT BRACKET COMPLETE</b> ... ..	DT01/12, 1/16, 1/22, 1/23, 1/25, 1/26, 1/27, 1/31, 1/32, 1/34, 1/51, 1/55, 1/56, 1/57	2	
9/15/94087	41-65		Bolt, $\frac{3}{8}$ " B.S.F. $\times$ $1\frac{1}{2}$ ", Special, Drilled ... ..	"	4	To locate Bracket before welding to Underframe
9/15/65502	85-34		Nut, Plain, $\frac{3}{8}$ " B.S.F. ... ..	"	4	
	R13549		Support... ..	DT01/13, 1/15, 1/14, 1/18, 1/24, 1/28, 1/30, 1/38, 1/39, 1/41, 1/49	4	Throttle Motor
9/15/65178	41-62		Bolt, $\frac{3}{8}$ " B.S.F. $\times$ $1\frac{1}{8}$ ", Drilled, Special ... ..	"	8	Support to Frame
	85-34		Nut, Plain, $\frac{3}{8}$ " B.S.F. ... ..	"	8	
	135-34		Washer, Grover, $\frac{3}{8}$ " ... ..	"	8	
9/15/65503	Z1/45206		<b>Spring</b> ... ..	"	2	Control Rod
9/15/65504	Z5/31374		Clip ... ..	"	2	
9/15/56758	121-104		Setscrew, $\frac{1}{4}$ " B.S.F. $\times$ $\frac{3}{4}$ " ... ..	"	2	Spring
	85-32		Nut, Plain, $\frac{1}{4}$ " B.S.F. ... ..	"	2	
	135-32		Washer, Grover, $\frac{1}{4}$ " ... ..	"	2	
9/15/46527	Z12/30769		Screw, Special, 2 B.A. $\times$ $1\frac{1}{4}$ " ... ..	DT01/12, 1/13, 1/15, 1/14, 1/16, 1/17, 1/18, 1/21, 1/22, 1/23, 1/24, 1/25, 1/26, 1/27, 1/28, 1/30, 1/31, 1/32, 1/33, 1/34, 1/38, 1/39, 1/40, 1/41, 1/49, 1/51, 1/56, 1/57	4	Control Cable
	149-14		Nut, Plain, No. 2 B.A. ... ..	"	4	
	153-19		Washer, Grover, $\frac{3}{16}$ " ... ..	"	4	



B.R. Cat. No.	A.E.C. Basic Part No.	Plate Ref.	Designation	Used on	No. Req. per Control Gear	Remarks
		<b>R6</b>	<b>CONTROL GEAR—Continued</b>			
9/15/65505	R3114		<b>THROTTLE MOTOR COMPLETE ...</b>	DTOI/43, 1/44, 1/48	1	(Power Cars)
9/15/65506	R3210		<b>THROTTLE MOTOR HOUSING WITH STUDS AND DOWEL ...</b>		1	
	R1/32425	1	Housing ...		1	
9/15/65463	Z8/30568	3	Stud, Special, $\frac{1}{4}'' \times 1''$ Long ...		10	Not supplied as Spares
9/15/65477	Z8/30567	4	Stud, Special, $\frac{1}{4}'' \times 1\frac{1}{8}''$ Long ...		8	Side and End Cover
9/15/65464	Z2/44025	5	Dowel ...		2	Air Cylinder
9/15/65465	124-154	6	Stud, $\frac{3}{8}''$ B.S.F. $\times 1\frac{3}{8}''$ , Special ...		4	} Housing
9/15/64230	124-155		Stud, $\frac{3}{8}''$ B.S.F. $\times 1\frac{1}{2}''$ , Special ...		2	
9/15/65507	124-156		Stud, $\frac{3}{8}''$ B.S.F. $\times 1\frac{3}{8}''$ , Special ...		2	
	85-34	7	Nut, Plain, $\frac{3}{8}''$ B.S.F. ...		8	
	135-34	8	Washer, Grover, $\frac{3}{8}''$ ...		8	
9/15/65467	R3208		<b>AIR CYLINDER COMPLETE</b>		4	
9/15/65468	R3204		<b>AIR CYLINDER WITH BUSH AND STUDS</b>		4	
9/15/65469	R3205		<b>AIR CYLINDER WITH BUSH</b>		4	
9/15/65470	R1/32438	9	Air Cylinder ...		4	Not supplied as Spares
9/15/65471	Z4/10215	10	Bush ...		4	
9/15/65463	Z8/30568	11	Stud, Special, $\frac{1}{4}''$ B.S.F., 1" Long ...		12	Air Cylinder Cover
9/15/65472	S2/13399	12	Adaptor ...		4	
9/15/65473	138-224	13	Washer, Copper, $\frac{1}{2}'' \times \frac{3}{16}'' \times \frac{1}{8}''$ , Special ...		4	} Air Cylinder
9/15/65474	138-227		Washer, Copper, $\frac{1}{2}'' \times \frac{1}{8}'' \times 24$ I.W.G., Special ...		4	
9/15/65156	81-1994	14	Adaptor, Valve ...		4	Tecalemit Y.28275 (mod.)
9/15/65475	138-133	15	Washer, Copper, 17 $\times$ 23 $\times$ 2 m/m., Special ...		4	
9/15/65476	81-1302	16	Lubricator, Tecalemit NA5801-1 ...		4	
9/15/65478	D40622	17	<b>Piston</b> ...		4	
9/15/65479	G27225	18	<b>Cup, Piston</b> ...		4	
9/15/65480	Z4/46549	19	Shim ...		As req.	} Piston Cup
9/15/65481	Z6/30697	20	Washer, Special, $\frac{3}{8}''$ O/D., $\frac{3}{16}'' \times \frac{1}{4}''$ I/D., $\frac{5}{32}''$ ...		4	
	90-153	21	Locknut, $\frac{5}{16}''$ B.S.F., "Simmonds" ...		4	
9/15/65482	R1/32430	22	Cover, Cylinder ...		4	
9/15/65483	Z44245	23	<b>Joint</b> ...		4	
	85-32	24	Nut, Plain, $\frac{1}{4}''$ B.S.F. ...		12	} Cover to Air Cylinder
	135-32	25	Washer, Grover, $\frac{1}{4}''$ ...		12	
9/15/65484	R1/10400	26	Shaft ...		1	
	157-3	27	Key, Woodruff, (No. 3) ...		5	
9/15/65485	Z8/44889	28	Boss, 1-577" ...		3	} Throttle Motor Shaft
9/15/65486	Z8/44884	29	Boss, 0-825" ...		1	
9/15/65489	Z2/10100	34	<b>Bush</b> ...		2	
9/15/65490	R3/11225	35	Lever ...		4	Air Cylinder
9/15/65491	R1/32427	36	Cover, End ...		1	} Throttle Motor
9/15/65492	R1/32428	37	Cover, Side ...		1	
	85-32	38	Nut, Plain, $\frac{1}{4}''$ B.S.F. ...		10	
	135-32	39	Washer, Grover, $\frac{1}{4}''$ ...		2	} Cover to Housing
	135-2	40	Washer, Thackray, $\frac{1}{4}''$ ...		8	
9/15/65494	Z4/46517	45	Shim, 0-005" ...		As req.	} Throttle Motor Shaft
9/15/65495	Z4/46518		Shim, 0-010" ...			
9/15/65496	Z4/46519		Shim, 0-015" ...			
9/15/40192	Z8/44885		Distance Piece ...			
9/15/65497	Z4/43706	47	Setscrew, Special, $\frac{3}{16}''$ B.S.F. $\times \frac{7}{8}''$ ...		2	} Piston Stop
9/15/65498	Z4/43707	48	Setscrew, Special, $\frac{3}{16}''$ B.S.F. $\times 1\frac{1}{4}''$ ...		2	
	90-33	49	Locknut, $\frac{3}{8}''$ B.S.F. ...		4	
	85-33	50	Nut, Plain, $\frac{5}{16}''$ B.S.F. ...		8	} Air Cylinder
	134-3	51	Washer, Plain, $\frac{5}{16}''$ ...		8	

B.R. Cat. No.	A.E.C. Basic Part No.	Plate Ref.	Designation	Used on	No. Req. per Control Gear	Remarks
9/15/65205	5110-1		<b>CONTROL GEAR—Continued</b> <b>FLOAT SWITCH COMPLETE, MOBREY TYPE SOIA/FO2A</b> ... ..	Not DTO1/28A, 1/35, 1/42, 1/48, 1/52	2	(Power Cars only except where otherwise stated)
9/15/65508	5111-3		<b>ENGINE RELAY BOX COMPLETE, J. STONE (DEPTFORD)</b> ... ..	DTO1/26, 1/32	1	
9/15/65509	5111-12		<b>ENGINE RELAY BOX COMPLETE, J. STONE (DEPTFORD)</b> ... ..	DTO1/13, 1/15, 1/12, 1/14, 1/16, 1/17, 1/18, 1/22, 1/21, 1/23, 1/24, 1/25, 1/27, 1/28, 1/31, 1/33, 1/30, 1/34, 1/38, 1/39, 1/40, 1/41, 1/41A, 1/44, 1/45, 1/49, 1/50, 1/51, 1/54, 1/55, 1/56, 1/57	2	
9/15/65510	5111-13		<b>ENGINE RELAY BOX COMPLETE, J. STONE (DEPTFORD), T4276</b> ...	DTO1/43	2	
9/15/65511	546-1717		<b>ENGINE RELAY BOX COMPLETE, C.A.V. No. V5994/1</b> ... ..	DTO1/38, 1/52	2	
9/15/65512	5111-4		<b>ELECTRIC PNEUMATIC RELAY BOX COMPLETE, J. STONE (DEPT-FORD), T3631</b> ... ..	DTO1/13, 1/15, 1/12, 1/14, 1/16, 1/17, 1/18, 1/22, 1/21, 1/23, 1/24, 1/25, 1/27, 1/28, 1/31, 1/33, 1/30, 1/34, 1/38, 1/39, 1/40, 1/41, 1/41A, 1/44, 1/45, 1/49, 1/50, 1/51, 1/53, 1/54, 1/55, 1/56, 1/57	2	
9/15/65513	5111-14		<b>ELECTRIC PNEUMATIC RELAY BOX COMPLETE, J. STONE (DEPT-FORD), T4277</b> ... ..	DTO1/43	2	
9/15/65514	546-1716		<b>ELECTRIC PNEUMATIC RELAY BOX COMPLETE, C.A.V. No. V5992/1</b> ...	DTO1/38, 1/52	2	
9/15/63797	415-102		<b>ENGINE ISOLATING SWITCH, WALL-SALL No. 3062</b> ... ..	Not DTO1/26, 1/28A, 1/32, 1/35, 1/42, 1/48, 1/53	2	
9/15/63777	546-1198		Switch, Press Button, C.A.V. No. 108-3 ...	Not DTO1/28A, 1/35, 1/42, 1/48	1	Deadman's Cancellation (Power and Trailer Cars)
9/15/63784	546-1170		<b>BATTERY ISOLATING SWITCH, C.A.V. No. 134-18</b> ... ..	Not DTO1/28, 1/28A, 1/35, 1/42, 1/43, 1/45, 1/50, 1/53	1	(See Note below)
9/15/65515	U182532		<b>BATTERY ISOLATING SWITCH, C.A.V. No. WN62/2361</b> ... ..	DTO1/28, 1/28A, 1/35, 1/42, 1/43, 1/45, 1/50, 1/53	1	
9/15/65516	5049-12		<b>ENGINE SPEED CONTROL BOX, Smiths No. 4301-304B</b> ... ..	Not DTO1/24, 1/28A, 1/35, 1/42, 1/44, 1/48, 1/53	2	Not req. on 20 Power Cars of DTO1/12
9/15/65517	5049-27		<b>COMBINED STARTER, CONTROL AND FIRE ALARM SWITCH, SMITHS</b> ...	DTO1/53	2	DS TRB-841
9/15/65518	546-1414		<b>12-WAY RELAY OPERATED SWITCH PANEL, MAGNETIC DEVICES LTD. No. 9280300</b> ... ..	DTO1/13, 1/15, 1/12, 1/14, 1/16, 1/17, 1/18, 1/24	1	(Power and Trailer Cars)
9/15/65519	546-1426		<b>18-WAY RELAY OPERATED SWITCH PANEL, MAGNETIC DEVICES LTD. No. 9287001</b> ... ..	DTO1/18, 1/22, 1/21, 1/23, 1/25, 1/27, 1/28, 1/31, 1/33, 1/30, 1/34, 1/38, 1/40, 1/39, 1/41, 1/41A, 1/43, 1/44, 1/45, 1/48, 1/49, 1/50, 1/51, 1/52, 1/53, 1/54, 1/56	1	(Power and Trailer Cars)

**NOTE:—Quantity of 546-1198 doubled on all Power Cars of DTO1/57 (Double Ended Cars)**

B.R. Cat. No.	A.E.C. Basic Part No.	Plate Ref.	Designation	Used on	No. Req. per Control Gear	Remarks
9/15/65520	V7549		<b>CONTROL GEAR—Continued</b> <b>LOCAL CONTROL BOX COMPLETE</b> ...	DT01/13, 1/15, 1/12, 1/14, 1/16, 1/17, 1/18, 1/22, 1/21, 1/23, 1/24, 1/25, 1/27, 1/28, 1/31, 1/33, 1/30, 1/34, 1/38, 1/40, 1/39, 1/41, 1/51	2	(Power Cars)
9/15/65521	V7531		<b>LOCAL CONTROL BOX COMPLETE</b> ...	DT01/53, 1/56	2	
9/15/63785	V38079		Casing ... ..	V7549, V7531	2	(Start)—4 off on V7531
9/15/65522	546-1431		<b>Switch, Press Button, C.A.V. No. 221/8</b> ...	V7549	2	
9/15/65523	V1/38007		Plate, Blanking ... ..	V7531	2	
9/15/65524	V1/38008		Joint... ..	"	2	
9/15/63789	546-1394		<b>Switch, Press Button, C.A.V. No. 108/4</b> ...	V7549, V7531	4	Stop
9/15/63790	146-12		Screw, Rd. Hd., No. 2 B.A. $\times \frac{1}{2}$ " ... ..	"	16	
9/15/65525	499-3692		Socket, Flanged, 5 amp., 2 Pin ... ..	"	2	
9/15/65526	Z44115		Gasket ... ..	"	2	
	145-36		Screw, Csk., No. 4 B.A. $\times \frac{3}{4}$ " ... ..	"	6	
	149-16		Nut, Plain, No. 4 B.A. ... ..	"	6	
	135-102		Washer, Shakeproof, $\frac{1}{8}$ " External ... ..	"	6	
9/15/63786	V38080		Cover ... ..	"	2	
	145-78		Screw, Raised Csk. Hd., No. 2 B.A. $\times \frac{1}{2}$ " ... ..	"	8	Cover
9/15/65527	V7529		<b>LOCAL CONTROL BOX COMPLETE</b> ...	DT01/26, 1/32	2	
9/15/65528	V38092		Casing ... ..	"	2	
9/15/63788	546-1393		<b>Switch, Press Button, C.A.V. No. 108/43</b> ...	"	4	Start
	546-1394		<b>Switch, Press Button, C.A.V. No. 108/4</b> ...	"	4	Stop
	146-12		Screw, Rd. Hd., No. 2 B.A. $\times \frac{1}{2}$ " ... ..	"	16	
9/15/65529	V38093		Cover ... ..	"	2	
	145-80		Screw, Raised Csk. Hd., No. 2 B.A. $\times \frac{3}{4}$ " ...	"	8	Cover

B.R. Cat. No.	A.E.C. Basic Part No.	Plate Ref.	Designation	Used on	No. Req. per Control Gear	Remarks
9/15/65206	5004-11		<b>CONTROL GEAR—Continued</b>			(Power Cars)
9/15/65207	5006-308		<b>AIR CLEANER AND ANTI-FREEZER, CLAYTON DEWANDRE AP.SA372-1 ...</b>	Not DTO1/26, 1/28A, 1/33, 1/35, 1/42, 1/48	2	
			<b>NON RETURN VALVE, CLAYTON DEWANDRE, AP.SA68 ...</b>	Not DTO1/26, 1/28A, 1/32, 1/35, 1/42, 1/43, 1/48	2	
9/15/65208	5006-504		Body, Clayton AP5006-1 ...	"	2	
9/15/65209	5001-140		Trip Valve with Seat, Clayton AP.SA39 ...	"	2	
9/15/65210	5006-495		Spring, Clayton AP5134 ...	"	2	
9/15/65211	5001-143		Adaptor Nut, Clayton AP5484-1 ...	"	2	
9/15/65212	138-142		Washer, Copper, 30.5 x 38 x 2 m/m., Special ...	"	2	
9/15/65213	5006-505		Plate, Locking, Clayton SO2055 ...	"	2	
9/15/65214	5001-144		Screw, Clayton SF8-13 ...	"	2	
	135-32		Washer, Grover, 1/4" ...	"	2	
9/15/65215	GA0903		<b>AIR RESERVOIR COMPLETE WITH SAFETY VALVE AND BLANKING PIECE ...</b>	DTO1/15, 1/12, 1/14, 1/16, 1/17, 1/18, 1/22, 1/23, 1/24, 1/25, 1/27, 1/28, 1/31, 1/30, 1/34, 1/38, 1/39, 1/41, 1/44, 1/45	1	
9/15/65216	GA0904		<b>AIR RESERVOIR COMPLETE WITH SAFETY VALVE &amp; BLANKING PIECE</b>	DTO1/13, 1/21, 1/33, 1/40, 1/43	1	
9/15/65530	GA0906		<b>AIR RESERVOIR COMPLETE WITH SAFETY VALVE &amp; BLANKING PIECE</b>	DTO1/49, 1/50, 1/51, 1/52, 1/53, 1/54, 1/55, 1/56, 1/57	1	
9/15/65218	5006-442		<b>AIR RESERVOIR COMPLETE, CLAYTON DEWANDRE AP.GA4624-1 ...</b>	GA0903	1	Green Unloader Valve
9/15/65219	5006-443		<b>AIR RESERVOIR COMPLETE, CLAYTON DEWANDRE, AP.GA4624-2 ...</b>	GA0904	1	
9/15/65531	5006-449		<b>AIR RESERVOIR COMPLETE, CLAYTON DEWANDRE, AP.GA4641 ...</b>	GA0906	1	
	5021-583		<b>SAFETY VALVE COMPLETE, WESTINGHOUSE, A87644-1 ...</b>	GA0903, GA0904, GA0906	1	
	5021-83		Body, Westinghouse A74387 ...	"	1	
	5021-82		Valve, Westinghouse A74386 ...	"	1	
	5021-81		Pivot, Westinghouse A74385 ...	"	1	
	5021-84		Spring, Westinghouse A75028-1 ...	"	1	
	5021-85		Cap, Valve, Westinghouse A75062 ...	"	1	
	5021-87		Locknut, Special, Westinghouse A84202 ...	"	1	
	5021-333		Adaptor, Westinghouse A74804-2 ...	"	1	
	219-24		Wire, Locking, Iron, 18 I.W.G. ...	"	As req.	
9/15/65221	501-225		Seal, Lead ...	"	1	
9/15/65222	Z51779		Blanking Piece ...	"	1	
9/15/65532	28-32		Bolt, No. 2 B.A. x 3/4", Special, Drilled ...	"	4	Blanking Piece
	153-19		Washer, Grover, No. 2 B.A. ...	"	4	
9/15/65223	132-56		Nut, Union, Special ...	"	1	
9/15/65224	Z2/32014		Nut, Special, ...	"	1	Blanking (Unloader Valve)
9/15/65225	138-214		Washer, Copper, Special, 3/8" Dia x 2 m/m. ...	"	1	
9/15/65533	5006-425		Tap, Drain, Clayton AP.SA763 ...	GA0906	2	

B.R. Cat. No.	A.E.C. Part No.	Page No.	Designation	Used on	No. Req. per Control Gear	Remarks
<b>CONTROL GEAR—Continued</b>						
9/15 65226	5204-01		<b>AIR RESERVOIR COMPLETE, CLAYTON DEMANDRE AP.GA4460-1</b> ... ..	DT01/15, 1/12, 1/16, 1/18, 1/22, 1/23, 1/24, 1/25, 1/27, 1/28, 1/31, 1/30, 1/34, 1/38, 1/39, 1/41, 1/44, 1/45	1	
9/15 65534	5204-02		<b>AIR RESERVOIR COMPLETE, CLAYTON DEMANDRE AP.GA4459-3</b> ... ..	DT01/13, 1/52		
9/15 65227	5204-03		<b>AIR RESERVOIR COMPLETE, CLAYTON DEMANDRE AP.GA4460</b> ... ..	DT01/14, 1/17, 1/21, 1/33, 1/40, 1/43	1	
9/15 65535	5204-04		<b>AIR RESERVOIR COMPLETE, CLAYTON DEMANDRE AP.GA4613</b> ... ..	DT01/26, 1/32		
9/15 65228	5204-05		<b>AUXILIARY AIR RESERVOIR, CLAYTON DEMANDRE AP.GA4459</b> ... ..	DT01/12, 1/15, 1/16, 1/17, 1/18, 1/22, 1/23, 1/24, 1/25, 1/27, 1/28, 1/31, 1/30, 1/34, 1/38, 1/39, 1/41, 1/41A, 1/44, 1/45, 1/49, 1/50, 1/51, 1/53, 1/54, 1/55, 1/56, 1/57	1	
9/15 65536	5204-06		<b>AUXILIARY AIR RESERVOIR, CLAYTON DEMANDRE AP.GA4460-3</b> ... ..	DT01/13		
9/15 65229	5204-07		<b>AUXILIARY AIR RESERVOIR, CLAYTON DEMANDRE AP.GA4459</b> ... ..	DT01/14, 1/21, 1/33, 1/40	2	
9/15 65230	5204-08		<b>AIR FILTER COMPLETE, CLAYTON DEMANDRE AP.SA209-3</b> ... ..	DT01/13, 1/15, 1/12, 1/14, 1/16, 1/17, 1/18, 1/22, 1/21, 1/23, 1/24, 1/25, 1/26, 1/27, 1/28, 1/31, 1/33, 1/32, 1/30, 1/34, 1/38, 1/40, 1/39, 1/41, 1/41A, 1/43, 1/44, 1/45, 1/49, 1/50, 1/51, 1/52, 1/53, 1/54, 1/55, 1/56, 1/57		
9/15 65231	5204-09		<b>REDUCING VALVE COMPLETE, CLAYTON DEMANDRE AP.GA6154/2</b> ... ..	"	1	
9/15 65232	5204-10		<b>AIR PRESSURE SWITCH, BTH. TYPE PGS. FORM 82</b> ... ..	DT01/13, 1/15, 1/12, 1/14, 1/16, 1/17, 1/18, 1/22, 1/21, 1/23, 1/24, 1/25, 1/27, 1/28, 1/31, 1/33, 1/30, 1/34, 1/38, 1/40, 1/39, 1/41, 1/41A, 1/43, 1/44, 1/45, 1/49, 1/50, 1/51, 1/52, 1/53, 1/54, 1/55, 1/56, 1/57	1	
	5203-07		Coupling Cord, 8", Westinghouse ... ..	Use on Trailer and non Driving Trailer Cars	2	Type S.R. No. 543 Type M.B. 50822 Type M. No. G288
	5203-04		Hose Coupling, 8", Westinghouse ... ..		2	
	5203-08		Dummy Coupling, 8", Westinghouse ... ..		2	

B.R. Cat. No.	A.E.C. Basic Part No.	Plate Ref.	Designation	Used on	No. Req. per Control Gear	Remarks	
	U192382		<b>CONTROL GEAR—Continued</b>				
	U192380		<b>SAND EJECTOR COMPLETE, WESTINGHOUSE No. B73753/1 ... ..</b>	DT01/45	44	These Quantities are total supplied for DT01/45	
	U192381		<b>AUXILIARY VALVE COMPLETE, WESTINGHOUSE No. A80031/2 ... ..</b>	"	11		
	U192379		<b>DUPLEX CHECK VALVE COMPLETE, WESTINGHOUSE No. B74160/2 ... ..</b>	"	5		
9/15/65537	U192378		<b>Hose, Flexible ... ..</b>	"	22		
9/15/65538	U192378		<b>THROTTLE CONTROLLER COMPLETE, SHARPS (SANDING) GA185 ... ..</b>	"	12		
9/15/63777	546-1198		<b>Switch, Press Button, C.A.V. No. 108-3 ... ..</b>	"	12		
9/15/65539	U189587		<b>ELECTRIC PNEUMATIC RELAY BOX COMPLETE, J. STONE (DEPTFORD) T4413 ... ..</b>	"	6		
9/15/65540	U184958		<b>AUTOMATIC GEAR CONTROLLER COMPLETE, SHARPS GA34 ... ..</b>	DT01/32	2		Automatic Gear Control on last Car only
9/15/65541	U184959		<b>ALTERNATOR COMPLETE, C.A.V. No. X LAB1470 ... ..</b>	"	1		
9/15/65542	U187420		<b>CONTROL UNIT COMPLETE, C.A.V. No. VN62-2467 ... ..</b>	"	1		
9/15/65543	U187464		<b>DRIVE CONTROLLER COMPLETE, SHARPS No. Q2769 ... ..</b>	DT01/42	1		

railcar.co.uk

