

# SPARE PARTS LIST



## GENERATORS

TYPE AC..



C.A.V. LIMITED LONDON W.3 ENGLAND

PUBLICATION No. 4190 PRICE 1/-



# C.A.V. SPARE PARTS

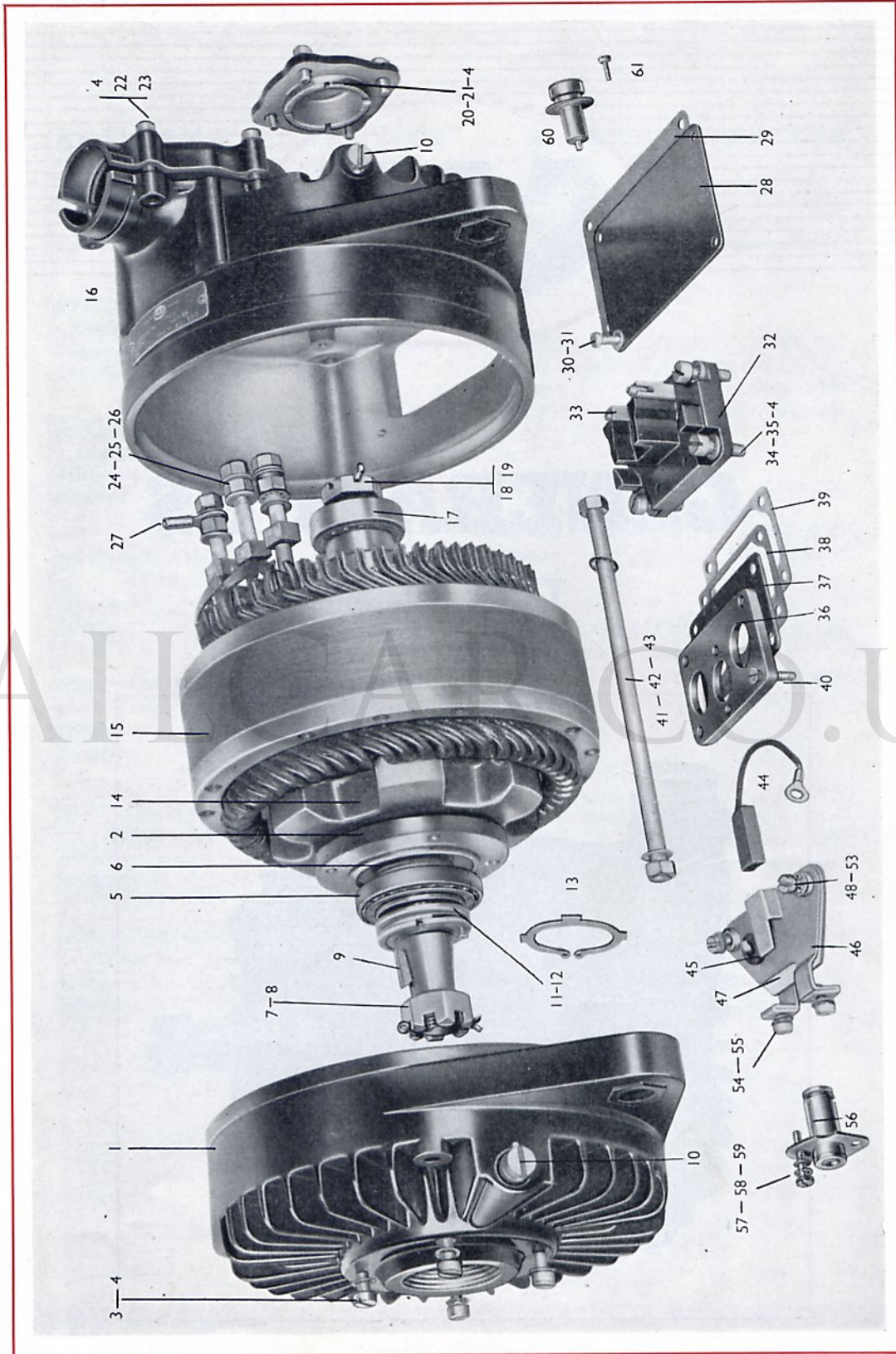

# C.A.V. SPARE PARTS

This Spare Parts List is applicable only to AC .. Generators bearing any of the type symbols listed below:—

## MODELS

					Page
AC724-1	...	...	1271010	...	7
AC824-2	...	...	1280020	...	4
AC8A24-2	...	...	1280021	...	4
AC824-3	...	...	1280030	...	4
AC8A24-3	...	...	1280031	...	4
AC824-4	...	...	—	...	4
AC8A24-4	...	...	—	...	4
AC824-5	...	...	1280050	...	4
AC8A24-5	...	...	1280051	...	4
AC8A24-6	...	...	1280060	...	4
AC8A32-2M	...	...	1281021	...	6





# C.A.V. SPARE PARTS

AC824.. & AC8A24.. GENERATOR PARTS	MODELS — PART AND ILLUSTRATION NUMBERS									
	AC824-2 AC8A24-2		AC824-3 AC8A24-3		AC824-4 AC8A24-4		AC824-5 AC8A24-5		AC8A24-6	
SHIELD, driving end (AC8) ...	5886-134	1	5886-140	1	5886-134	1	5886-134	1	—	—
SHIELD, driving end (AC8A) ...	5886-169	1	5886-186	1	5886-169	1	5886-169	1	5886-169A	1
CAP, D.E. bearing (AC8) ...	5886-136	2	§	§	§	§	§	§	—	—
CAP, D.E. bearing (AC8A) ...	5886-173	2	§	§	§	§	§	§	§	§
SCREW, for (2) (AC8) ...	5335-630	3	§	§	§	§	§	§	§	§
SCREW, for (2) (AC8A) ...	5335-630D	3	§	§	§	§	§	§	§	§
WASHER, spring, for (3, 21, 23 & 34)	5001-10	4	§	§	§	§	§	§	§	§
RACE, roller, D.E. (AC8) ...	NC4-3	4	§	§	§	§	§	§	—	—
RACE, roller, D.E. (AC8A) ...	5886-183	5	§	§	§	§	§	§	§	§
WASHER, bearing D.E. (AC8) ...	5886-124	6	§	§	§	§	§	§	—	—
WASHER, bearing D.E. (AC8A) ...	5886-191	6	§	§	§	§	§	§	§	§
NUT, shaft, D.E. ...	5330-313	7	§	§	§	§	§	§	§	§
PIN, split, for (7) ...	NJ1-48	8	§	§	§	§	§	§	§	§
KEY, drive end ...	NK1-9	9	§	§	§	§	§	§	§	§
PLUG, lubricator ...	5886-154	10	§	§	§	§	§	§	§	§
NUT, bearing, D.E. (AC8) ...	5886-38A	11	§	§	§	§	§	§	—	—
SCREW, locking (11) (AC8) ...	5333-136	12	§	§	§	§	§	§	—	—
CIRCLIP, D.E. (AC8A) ...	5886-200	13	§	§	§	§	§	§	§	§
ROTOR, assembly (AC8) ...	A628	14	§	§	§	§	§	§	—	—
ROTOR, assembly (AC8A) ...	A629	14	§	§	§	§	§	§	A662	14
STATOR, assembly ...	A580	15	§	§	A631	15	A639	15	A663	15
SHIELD, terminal end (AC8) ...	5886-128	16	5886-142	16	5886-128	16	5886-192	16	—	—
SHIELD, terminal end (AC8A) ...	5886-128A	16	5886-142A	16	5886-128A	16	5886-192A	16	—	—
SHIELD & COWL, term. end ...	—	—	—	—	—	—	—	—	5886-199	16
PLATE, cover, for (16) ...	—	—	—	—	—	—	—	—	5886-208	—
GASKET, cover plate ...	—	—	—	—	—	—	—	—	5886-213	—
SCREW, cover plate ...	—	—	—	—	—	—	—	—	NS37-15Z1	—
WASHER, spring ...	—	—	—	—	—	—	—	—	5244-22	—
RACE, ball, term. end (AC8) ...	NC2-7	17	§	§	§	§	§	§	—	—
RACE, ball, term. end. (AC8A) ...	5886-184	17	§	§	§	§	§	§	§	§
NUT, shaft, term. end ...	5330-312	18	§	§	§	§	§	§	§	§
PIN, split, for (18) ...	NJ1-47	19	§	§	§	§	§	§	§	§
CAP, bearing, term. end. (AC8) ...	5886-132	20	§	§	§	§	§	§	—	—
CAP, bearing, term. end (AC8A) ...	5886-179	20	§	§	§	§	§	§	5886-206	20
SCREW, fixing cap ...	5335-630A	21	§	§	§	§	§	§	§	§
COVER, terminal box ...	5886-139	22	§	§	§	§	—	—	§	§
BASE, terminal box ...	—	—	—	—	—	—	—	—	5978-19	—
SCREW, fixing cover ...	5335-630C	23	§	§	§	§	—	—	§	§
NUT, terminal ...	5330-262A	24	§	§	§	§	5293-57	25	5330-262A	24
WASHER, spring, for (24) ...	5001-31	25	§	§	§	§	—	—	5001-31	25
WASHER, plain, for (24) ...	NW1-24Z1	26	§	§	§	§	—	—	§	§
NUT, for small terminal ...	—	—	—	—	—	—	—	—	NW1-4T1	—
WASHER, spring, small term. ...	—	—	—	—	—	—	—	—	5244-22	—
WASHER, plain, small term. ...	—	—	—	—	—	—	—	—	NW1-14Z1	—
SOCKET, cable ...	5459-25B	27	§	§	§	§	5459-25F	47	5459-25G	27
COVER, brush gear ...	5886-118	28	§	§	§	§	§	§	§	§

continued—

§ This denotes the same part number as column 1.



# C.A.V. SPARE PARTS

AC824.. & AC8A24.. GENERATOR PARTS <i>—continued</i>	MODELS — PART AND ILLUSTRATION NUMBERS				
	AC824-2 AC8A24-2	AC824-3 AC8A24-3	AC824-4 AC8A24-4	AC824-5 AC8A24-5	AC8A24-6
GASKET, cover ... ..	5886-119 29	§	§	§	§
SCREW, fixing cover ... ..	NS37-14 30	§	§	§	§
WASHER, spring, for (30) ... ..	5244-22 31	§	§	§	§
TERMINAL BASE ASSY. ... ..	5886-120 32	§	5886-120A 32	—	5886-120B 32
Screw, terminal ... ..	5335-91C 33	§	§	—	§
SCREW, fixing (32) ... ..	5335-630B 34	§	§	—	5335-630A 34
WASHER, plain, for (32) ... ..	NW1-14 35	§	§	—	§
PLATE, terminal, thick ... ..	—	—	—	5886-194 36	—
PLATE, terminal, thin ... ..	—	—	—	5886-219 37	—
PLATE, insulating ... ..	—	—	—	—	5886-211 37
PLATE, locking ... ..	—	—	—	5886-193 38	5886-212 38
GASKET, terminal plate ... ..	—	—	—	5886-195 39	5886-195 39
TERMINAL, small, for (37) ... ..	—	—	—	—	5596-6 —
NUT, small terminal ... ..	—	—	—	NU2-3T —	NU1-4T1 —
WASHER, plain, small term. ... ..	—	—	—	NW3-19T —	NW1-10Z1 —
WASHER, spring, small term. ... ..	—	—	—	5244-22 —	5244-22 —
SCREW, fixing (36) ... ..	—	—	—	5333-152A 40	—
SCREW, fixing (37) ... ..	—	—	—	—	5335-630B 34
BOLT, through ... ..	5886-152 41	§	§	§	§
NUT, for (41) ... ..	5330-262 42	§	§	§	§
WASHER, spring, for (42) ... ..	5001-31 43	§	§	§	§
BRUSH, with lead ... ..	5886-34 44	§	§	§	§
SPRING, brush ... ..	5886-32 45	§	§	§	§
HOLDER, brush ... ..	5886-78 46	§	§	§	§
PLATE, insulating (46) ... ..	5886-33 47	§	§	§	§
SCREW, fixing (46) ... ..	NS37-47 48	§	§	§	§
WASHER, spring, for (48) ... ..	5244-22 49	§	§	§	§
WASHER, plain, for (48) ... ..	NW1-10 50	§	§	§	§
WASHER, insulating (48) ... ..	5936-94 51	§	§	§	§
BUSH, insulating (48) ... ..	5567-248A 52	§	§	§	§
BUSH, earthing (48) ... ..	—	—	—	5886-197 53	—
SCREW, fixing, brush lead ... ..	NS39-5T 54	§	§	§	§
WASHER, spring, for (54) ... ..	5244-22 55	§	§	§	§
BUSH, suppressor ... ..	—	—	—	5915-45A 56	—
SCREW, fixing (56) ... ..	—	—	—	NS37-5T 57	—
WASHER, spring, for (57) ... ..	—	—	—	5001-23 58	—
WASHER, plain, for (57) ... ..	—	—	—	NW3-19T 59	—
SOCKET, cable, screened ... ..	—	—	—	5658-258 60	—
RIVET, for (60) ... ..	—	—	—	NR15-7 61	—
LEAD, pos. field to socket ... ..	—	—	—	5886-75E —	—
SLEEVE, for lead ... ..	—	—	—	5658-38G —	—
FAN, cooling ... ..	—	—	—	—	5886-204 —
KEY, fan ... ..	—	—	—	—	NK1-6 —
COVER, fan ... ..	—	—	—	—	5886-202 —
WASHER, for fan ... ..	—	—	—	—	NW2-187Z1 —
SCREW, fan cover ... ..	—	—	—	—	NS37-14Z1 —
WASHER, spring ... ..	—	—	—	—	5244-22 —
LEADS, brush, complete ... ..	—	—	—	—	5886-216 —

§ This denotes the same part number as column 1.





# C.A.V. SPARE PARTS

ACA832 . . GENERATOR PARTS	MODEL — PART AND ILLUSTRATION NUMBERS		
	AC8A32-2M	PARTS— <i>continued</i>	AC8A32-2M
SHIELD, driving end ... ..	5886-169B 1	SOCKET, cable ... ..	5459-25B 27
CAP, D.E. Bearing ... ..	5886-173A 2	COVER, brushgear ... ..	5886-118A 28
SCREW, for (2) ... ..	5335-630D 3	GASKET, cover ... ..	5886-119A 29
WASHER, spring, for (3, 21, 23 & 34)	5001-10 4	SCREW, fixing cover ... ..	NS37-14Z1 30
RACE, roller, D.E. ... ..	5886-183 5	WASHER, spring, for (30) ... ..	5244-22 31
WASHER, bearing, D.E. ... ..	5886-191 6	TERMINAL BASE ASSY. ... ..	5886-120 32
NUT, shaft, D.E. ... ..	5330-313 7	Screw terminal ... ..	5335-91C 33
PIN, split, for (7) ... ..	NJ1-48 8	SCREW, fixing (32) ... ..	5335-630B 34
KEY, drive end ... ..	NK1-9 9	WASHER, plain for (32) ... ..	NW1-14Z1 35
PLUG, lubricator ... ..	5886-154 10	BOLT, through ... ..	5886-152 41
CIRCLIP, D.E. ... ..	5886-200 13	NUT, for (41) ... ..	5330-262 42
ROTOR, assembly ... ..	A662 14	WASHER, spring for (42) ... ..	5001-31 43
STATOR, assembly ... ..	A680 15	BRUSH, with lead ... ..	5886-34 44
SHIELD, terminal end ... ..	5886-128B 16	SPRING, brush ... ..	5886-32 45
RACE, ball, terminal end ... ..	5886-184 17	HOLDER, brush ... ..	5886-78 46
NUT, shaft, terminal end ... ..	5330-312 18	PLATE, insulating (46) ... ..	5886-33 47
PIN, split, for (18) ... ..	NJ1-47 19	SCREW, fixing (46) ... ..	NS37-47Z1 48
CAP, bearing, terminal end ... ..	5886-179A 20	WASHER, spring for (48) ... ..	5244-22 49
SCREW, fixing cap ... ..	5335-630A 21	WASHER, plain for (48) ... ..	NW1-10Z1 50
COVER, terminal box ... ..	5886-139B 22	WASHER, insulating (48) ... ..	5936-94 51
SCREW, fixing cover ... ..	5335-630C 23	BUSH, insulating (48) ... ..	5567-248A 52
NUT, terminal ... ..	5330-262A 24	SCREW, fixing, brush lead ... ..	NS39-5T 54
WASHER, spring, for (24) ... ..	5001-31 25	WASHER, spring for (54) ... ..	5244-22 55
WASHER, plain, for (24) ... ..	NW1-24Z1 26		

*continued—*



# C.A.V. SPARE PARTS

AC724 . . GENERATOR PARTS	MODEL — PART AND ILLUSTRATION NUMBERS					
	AC724-I		PARTS— <i>continued</i>		AC724-I	
SHIELD, driving end ... ..	6019-60	1	SCREW, fixing, cover ... ..	5335-668	—	
CAP, D.E. bearing ... ..	5886-173A	2	WASHER, spring, for (30) ... ..	5001-10	—	
SCREW, for (2) ... ..	5335-630D	3	BASE, terminal ... ..	6019-34	32	
WASHER, spring, for (3, 21, 23 & 24)	5001-10	4	SCREW, fixing (32) ... ..	NS39-9T	34	
RACE, roller, D.E. ... ..	5886-183	5	WASHER, plain, for (32) ... ..	NW3-21T	35	
WASHER, bearing D.E. ... ..	5886-191	6	BOLT, through ... ..	6019-49	41	
NUT, shaft, D.E. ... ..	5330-313	7	NUT, for (41) ... ..	5330-261	42	
PIN, split, for (7) ... ..	NJ1-48	8	WASHER, spring for (42) ... ..	5001-10	43	
KEY, drive end ... ..	NK1-9	9	BRUSH, with lead ... ..	5886-34	44	
NUT, bearing, terminal end ... ..	5886-38A	11	SPRING, brush ... ..	5886-32	45	
SCREW, locking (11) ... ..	5333-136	12	HOLDER, brush ... ..	5886-78	46	
PLATE, bearing, terminal end ... ..	6019-29	—	PLATE, insulating (46) ... ..	5886-33	47	
SCREW, bearing plate ... ..	NS37-16	—	SCREW, fixing (46) ... ..	NS39-32	48	
WASHER, spring, for screw ... ..	5001-23	—	WASHER, spring, for (48) ... ..	5244-22	49	
CIRCLIP, D.E. ... ..	5886-200	13	WASHER, plain, for (48) ... ..	NW1-10Z1	50	
ROTOR, assembly ... ..	A672	14	WASHER, insulating (48) ... ..	5936-94	51	
STATOR, assembly ... ..	A673	15	BUSH, insulating (48) ... ..	5567-248A	52	
SHIELD, terminal end ... ..	6019-61	16	SCREW, fixing, brush lead ... ..	NS39-5T	54	
RACE, ball, terminal end ... ..	6019-24	17	WASHER, spring for (54) ... ..	5244-22	55	
WASHER, bearing, terminal end ... ..	5886-124	—	GASKET, terminal cover ... ..	6019-50	—	
COVER, terminal ... ..	6019-48	22	RING NUT, cable entry ... ..	5658-114C	—	
SCREW, fixing, cover ... ..	NS37-18	23	WASHER, ring nut ... ..	NW3-52	—	
NUT, terminal ... ..	NU2-2T	24	CONE, sealing ... ..	6019-55	—	
WASHER, plain, for (24) ... ..	NW3-32	26	SOCKET, cable screened ... ..	6019-75	60	
COVER, brushgear ... ..	6019-45	—	RIVET, for (60) ... ..	6019-58	61	
GASKET, cover ... ..	6019-51	—				

*continued—*







**RESIDENT SERVICE REPRESENTATIVES**

**EASTERN AREA DEPOT** Mr. G. H. Wolno  
469 Norwich Road, Ipswich, Suffolk  
Telephone . . . . . Ipswich 81629

**EIRE: DUBLIN DEPOT** C.A.V. Ltd.  
Portland St. North, North Circular Road  
Telephone . . . . . Dublin 46195  
Telegrams . . . . . "Luserv, Dublin"

**MIDLAND AREA DEPOT** C.A.V. Ltd.  
Great Hampton Street, Birmingham, 18  
Telephone . . . . . Central 5050  
Telegrams . . . . . "Lucas, Telex, Birmingham"

**NORTHERN AREA DEPOT** C.A.V. Ltd.  
64 Roseville Road, Leeds, 8  
Telephone . . . . . Leeds 22768  
Telegrams . . . . . "Luserdep, Leeds"

**NORTH-EASTERN AREA DEPOT** C.A.V. Ltd.  
64-68 St. Mary's Place, Newcastle-on-Tyne, 1  
Telephone . . . . . Newcastle-on-Tyne 25571  
Telegrams . . . . . "Motolite, Newcastle-on-Tyne"

**NORTHERN IRELAND DEPOT** C.A.V. Ltd.  
51 Upper Library Street, Belfast  
Telephone . . . . . Belfast 25617  
Telegrams . . . . . "Servdep, Belfast"

**NORTH-WESTERN AREA DEPOT** C.A.V. Ltd.  
Talbot Road, Stretford, Manchester  
Telephone . . . . . Longford 1101  
Telegrams . . . . . "Lucas, Stretford"

**LIVERPOOL DEPOT** C.A.V. Ltd.  
450-456 Edge Lane, Liverpool, 13  
Telephone . . . . . Stonycroft 4721  
Telegrams . . . . . "Luserv, Liverpool"

**SOUTHERN AREA DEPOT** C.A.V. Ltd.  
85 Old Shoreham Road, Hove, Brighton, 4  
Telephone . . . . . Hove 38993  
Telegrams . . . . . "Luserv, Brighton"

**SOUTH WALES DEPOT** C.A.V. Ltd.  
54a Penarth Road, Cardiff  
Telephone . . . . . Cardiff 28361  
Telegrams . . . . . "Lucas, Cardiff"

**WESTERN AREA DEPOT** C.A.V. Ltd.  
345 Bath Road, Bristol, 4  
Telephone . . . . . Bristol 76001  
Telegrams . . . . . "Kingly, Bristol"

**SCOTTISH AREA DEPOTS**  
**EDINBURGH, 11** C.A.V. Ltd.  
60 Stevenson Road, Gorgie  
Telephone . . . . . Edinburgh 62921  
Telegrams . . . . . "Luserv, Edinburgh"

**GLASGOW, C.3** C.A.V. Ltd.  
4-24 Grant Street, St. George's Road  
Telephone . . . . . Douglas 6591-6  
Telegrams . . . . . "Vanteria, Glasgow, C.3"

RAILCAR.CO.UK

**C.A.V. LIMITED · ACTON · LONDON W.3**

Telephone: SHEPHERDS BUSH 3111  
PRINTED IN ENGLAND

Telegrams: VANTERIA, TELEX, LONDON  
PUBLICATION No. 4190  
(APRIL, 1959)